



**ALUMÍNIOS IBÉRICA, S.A.**



**PALA - MIGUEL & REIS, LDA.**



**ALUMÍNIOS DE VISEU, LDA.**



**ANGULAR - Alumínios, Lda.**

## Catálogo COR 70 C16 ST



Sistema / System

## ► COR 70 C16 ST

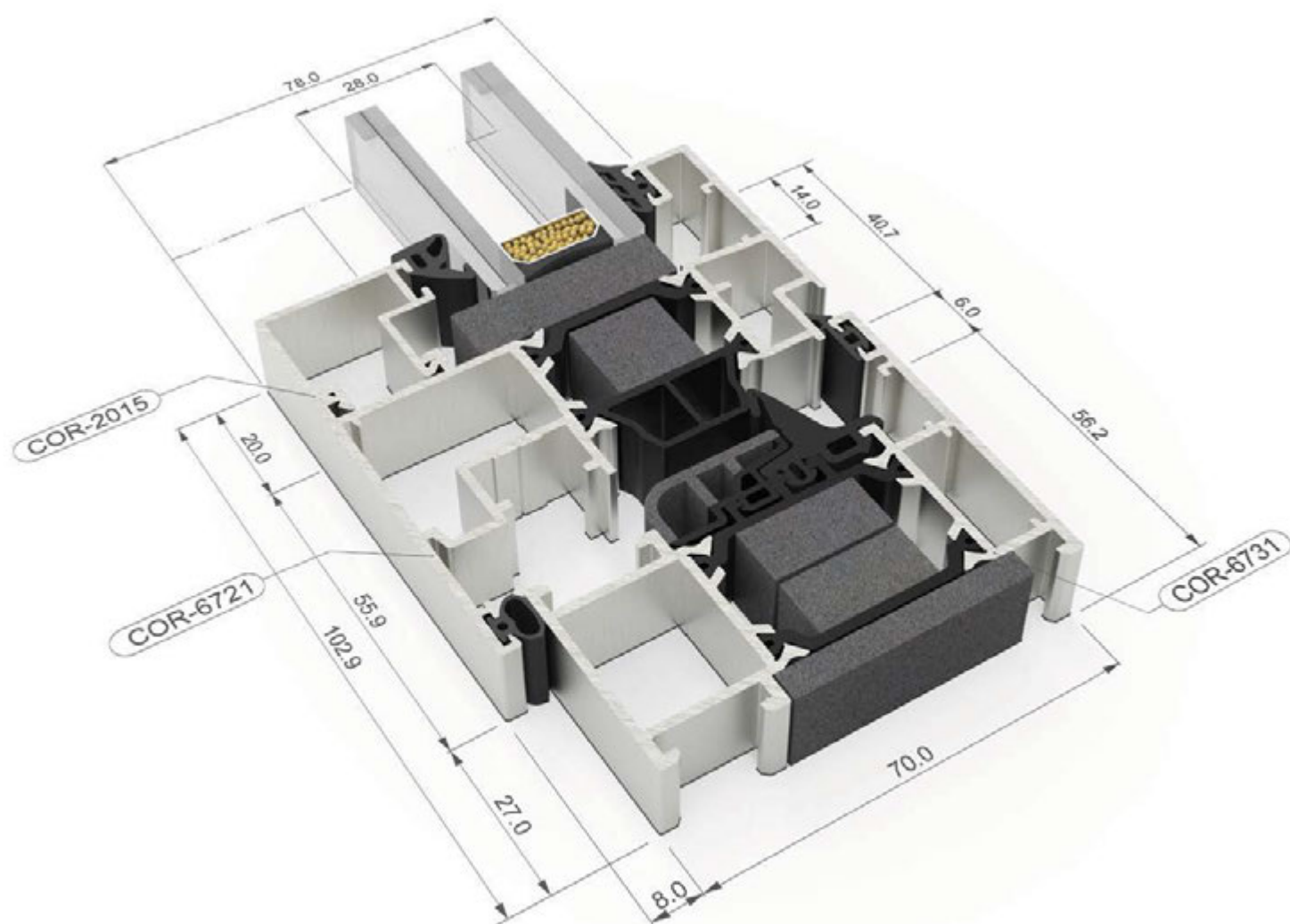

ALUMÍNIOS IBÉRICA, S.A.



PALA-MIGUEL S REIS, Lda.



ALUMÍNIOS DE VISEU Lda.



ANGULAR - Aluminios, Lda.

Sistema / System

## ➤ COR 70 C16 ST



ALUMÍNIOS IBÉRICA, S.A.



PALA-MIGUEL S REIS, LDA.



ALUMÍNIOS DE VISEU, LDA.



ANGULAR - Alumínios, Lda.

Transmitancia / Transmittance

$U_w \geq 0,9$  (W/m<sup>2</sup>K)

Consultar tipología, dimensión y vidrio.  
Consult typology, dimensions and glass.

**CTE - Apto para zonas climáticas\*: α A B C D E**

\*En función de la transmitancia del vidrio.

Aislamiento acústico / Acoustic insulation

Máximo acristalamiento  
Maximum glazing 55 mm

Máximo aislamiento acústico  
Maximum acoustic insulation **Rw = 46 dB**

Secciones Sections	Espesor perfilera Profile thickness		
Marco / Frame	70 mm	Ventana / Window	1,5 mm
Hoja / Sash	78 mm		

Longitud varilla poliamida Polyamide strip length	Marco / Frame	35 mm
	Hoja / Sash	30 mm

**Categorías alcanzadas en banco de ensayos**  
**Categories achieved at test centre**

Permeabilidad al aire / Air permeability  
(UNE-EN 12207:2000): Clase / Class 4

Estanqueidad al agua / Water tightness  
(UNE-EN 12208:2000): Clase / Class E1500

Resistencia al viento / Wind resistance  
(UNE-EN 12210:2000): Clase / Class C5

Ensayo de referencia ventana 1,23 x 1,48 m, 2 hojas.  
Reference test 1,23 x 1,48 m, 2 sashes.

**Acabados / Finishes**

Posibilidad bicolor / Possibility of dual colour  
Lacado colores (RAL, moteados y rugosos) / Colour powder coating (RAL, mottled & rough)  
Lacado imitación madera / Wood effect powder coating  
Lacado antibacteriano / Anti-bacterial powder coating  
Anodizado / Anodized

**Posibilidades de apertura**  
**Opening possibilities**

Apertura interior: practicable, oscilo-batiente, abatible.

Open in: casement, tilt-turn, tilt.

**Dimensiones máximas/hoja**  
**Maximum dimensions/sash**

Ancho / Width (L) = 1.500 mm

Alto / Height (H) = 2.600 mm

Consultar peso y dimensiones máximas según tipología.  
Consult maximum weight and dimensions in accordance to typology.

**Peso máximo/hoja**  
**Maximum weight/sash** 120 Kg.

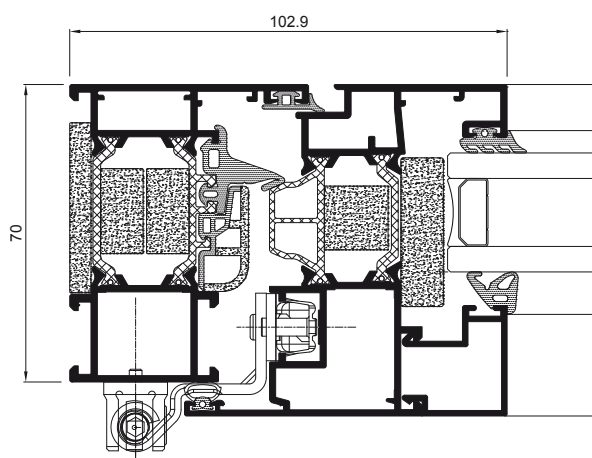

ALUMINIOS IBÉRICA, S.A.



PALA-MIGUEL S REIS, LDA.



ALUMINIOS DE VISEULDA



ANGULAR - Aluminios, Lda.

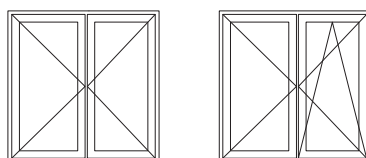
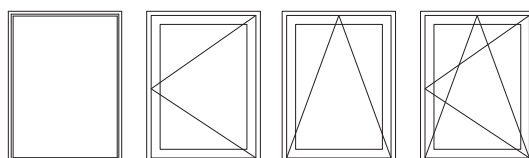

ALUMÍNIOS IBÉRICA, S.A.



PALA-MIGUEL S REIS, Lda.



ALUMÍNIOS DE VISEU Lda.



ANGULAR - Aluminios, Lda.

COR 70 C16 ST  
Perfis à escala

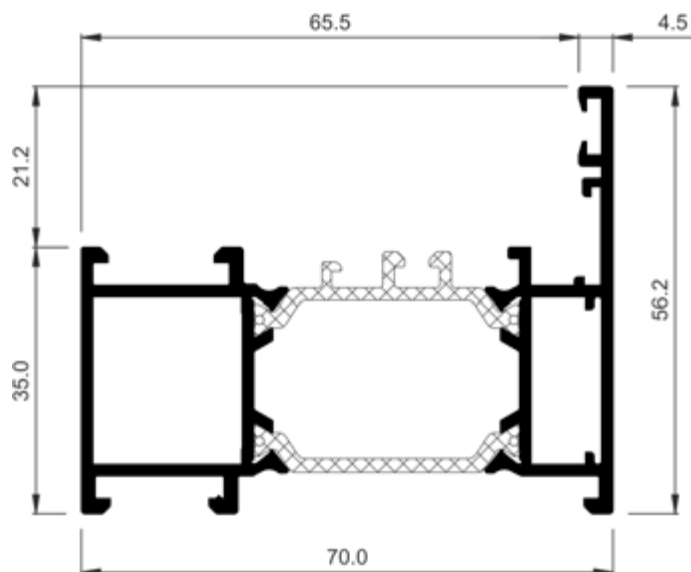

COR-6730	
<b>Descripción</b> Description	Marco alto ventana apertura interior Inner opening high window frame
<b>Peso</b> Weight (g/m)	1395,5
<b>Superficie</b> Surface (dm <sup>2</sup> /m)	53,9
<b>Ix (cm<sup>4</sup>)</b>	8,05
<b>Iy (cm<sup>4</sup>)</b>	30,08
<b>Escuadra principal</b> Main cleat	366730
<b>Troquel</b> Punch tool	366799
<b>Escuadra secundaria</b> Secondary cleat	356731
<b>Escuadra alineamiento</b> Alignment cleat	296838

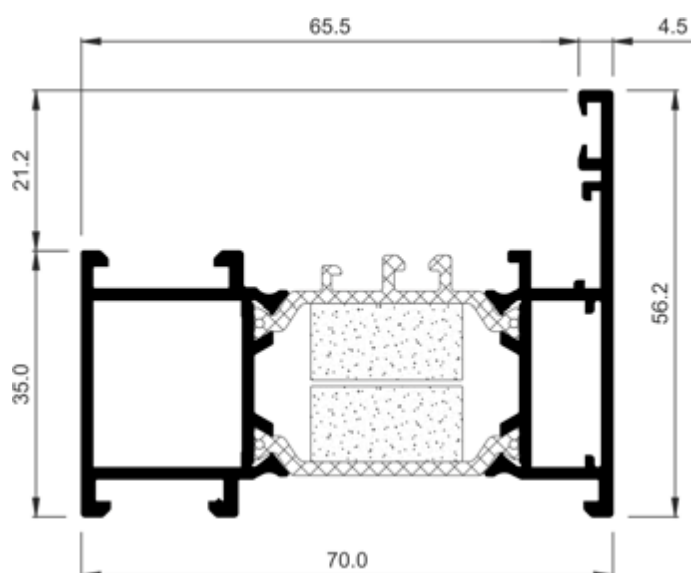

COR-6731	
<b>Descripción</b> Description	Marco alto ventana apertura interior HI Inner opening high window frame HI
<b>Peso</b> Weight (g/m)	1395,5
<b>Superficie</b> Surface (dm <sup>2</sup> /m)	53,9
<b>Ix (cm<sup>4</sup>)</b>	8,05
<b>Iy (cm<sup>4</sup>)</b>	30,08
<b>Escuadra principal</b> Main cleat	366730
<b>Troquel</b> Punch tool	366799
<b>Escuadra secundaria</b> Secondary cleat	356731
<b>Escuadra alineamiento</b> Alignment cleat	296838

COR 70 C16 ST  
Perfis à escala

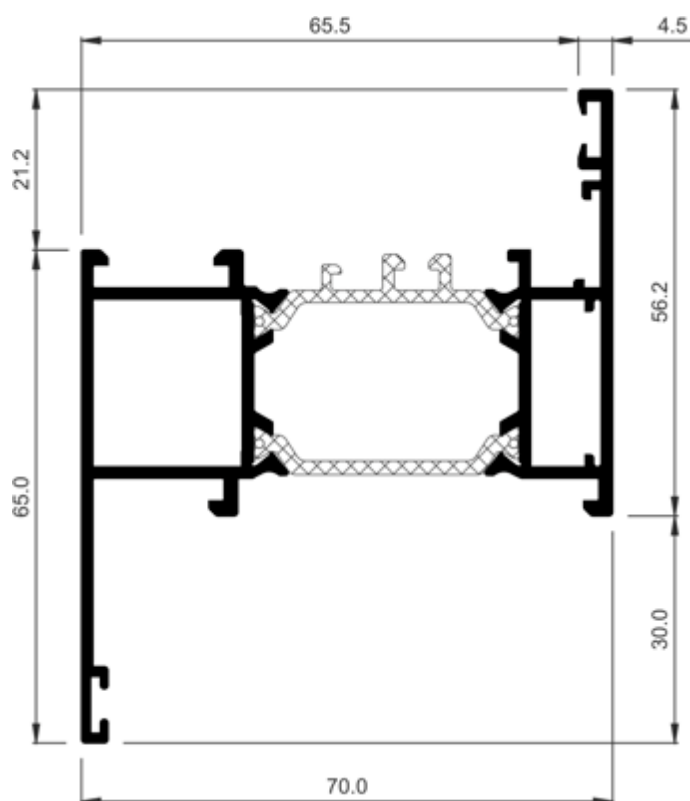

COR-6732	
<b>Descripción</b> Description	Marco alto ventana A.I. con solape Inner opening high window frame with 30 mm overlap
<b>Peso</b> Weight (g/m)	1519,7
<b>Superficie</b> Surface (dm <sup>2</sup> /m)	60,97
<b>Ix (cm<sup>4</sup>)</b>	14,64
<b>Iy (cm<sup>4</sup>)</b>	36,01
<b>Escuadra principal</b> Main cleat	366730
<b>Troquel</b> Punch tool	366799
<b>Escuadra secundaria</b> Secondary cleat	356731
<b>Escuadra alineamiento</b> Alignment cleat	296838 960023

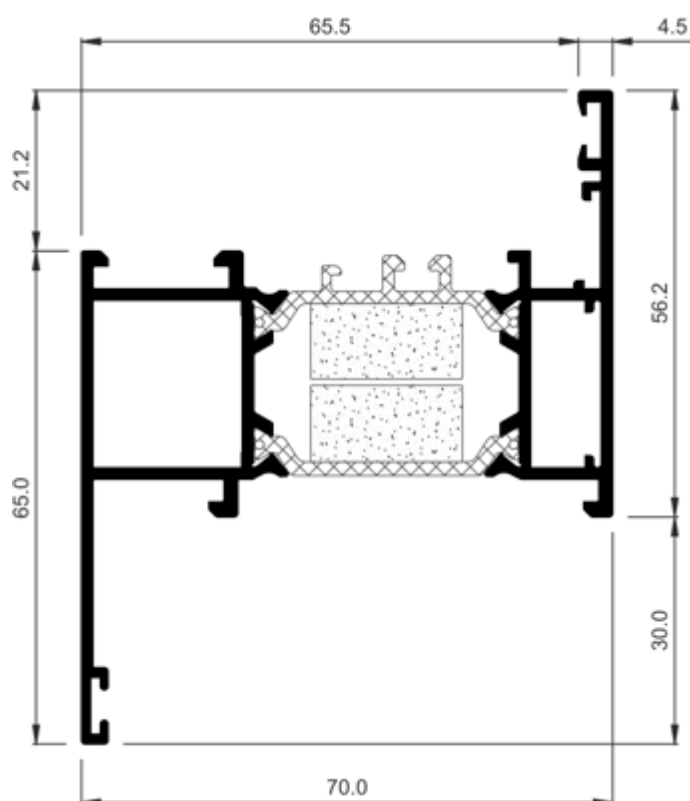

COR-6733	
<b>Descripción</b> Description	Marco alto ventana apertura interior con solape HI Inner opening high window frame with 30 mm overlap HI
<b>Peso</b> Weight (g/m)	1519,7
<b>Superficie</b> Surface (dm <sup>2</sup> /m)	60,97
<b>Ix (cm<sup>4</sup>)</b>	14,64
<b>Iy (cm<sup>4</sup>)</b>	36,01
<b>Escuadra principal</b> Main cleat	366730
<b>Troquel</b> Punch tool	366799
<b>Escuadra secundaria</b> Secondary cleat	356731
<b>Escuadra alineamiento</b> Alignment cleat	296838 960023



ALUMINIOS IBÉRICA, S.A.



PALA-MIGUEL S REIS, LDA.



ALUMINIOS DE VISEU LDA.



ANGULAR - Aluminios, Lda.



COR 70 C16 ST  
Perfis à escala

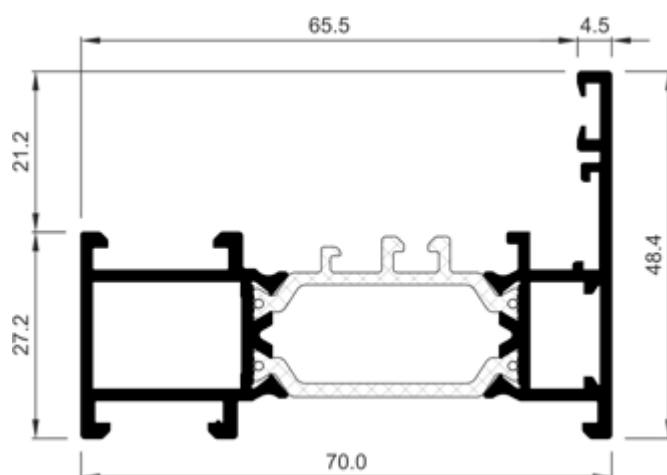

COR-7930	
<b>Descripción</b> Description	Marco ventana apertura interior Inner opening window frame
<b>Peso</b> Weight (g/m)	1274
<b>Superficie</b> Surface (dm <sup>2</sup> /m)	47,28
<b>Ix (cm<sup>4</sup>)</b>	4,82
<b>Iy (cm<sup>4</sup>)</b>	26,67
<b>Escuadra principal</b> Main cleat	327922
<b>Troquel</b> Punch tool	366799
<b>Escuadra secundaria</b> Secondary cleat	327920
<b>Escuadra alineamiento</b> Alignment cleat	296838

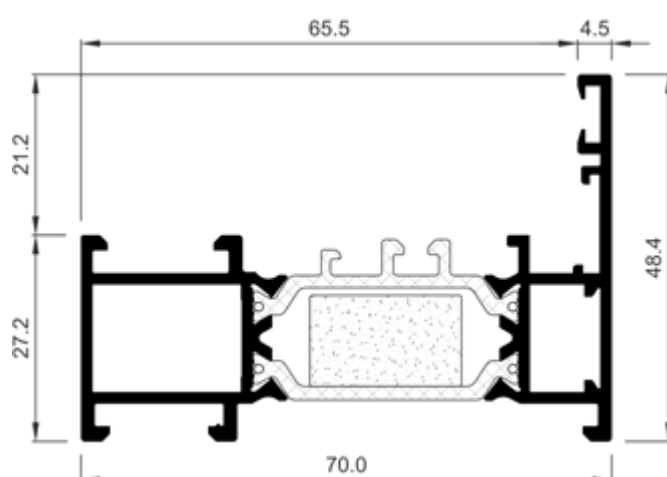

COR-7931	
<b>Descripción</b> Description	Marco ventana apertura interior HI Inner opening HI window frame
<b>Peso</b> Weight (g/m)	1274
<b>Superficie</b> Surface (dm <sup>2</sup> /m)	47,28
<b>Ix (cm<sup>4</sup>)</b>	4,82
<b>Iy (cm<sup>4</sup>)</b>	26,67
<b>Escuadra principal</b> Main cleat	327922
<b>Troquel</b> Punch tool	366799
<b>Escuadra secundaria</b> Secondary cleat	327920
<b>Escuadra alineamiento</b> Alignment cleat	296838



ALUMINIOS IBÉRICA, S.A.



PALA-MIGUEL S REIS, LDA.



ALUMINIOS DE VISEU LDA.



ANGULAR - Aluminios, Lda.



COR 70 C16 ST  
Perfis à escala

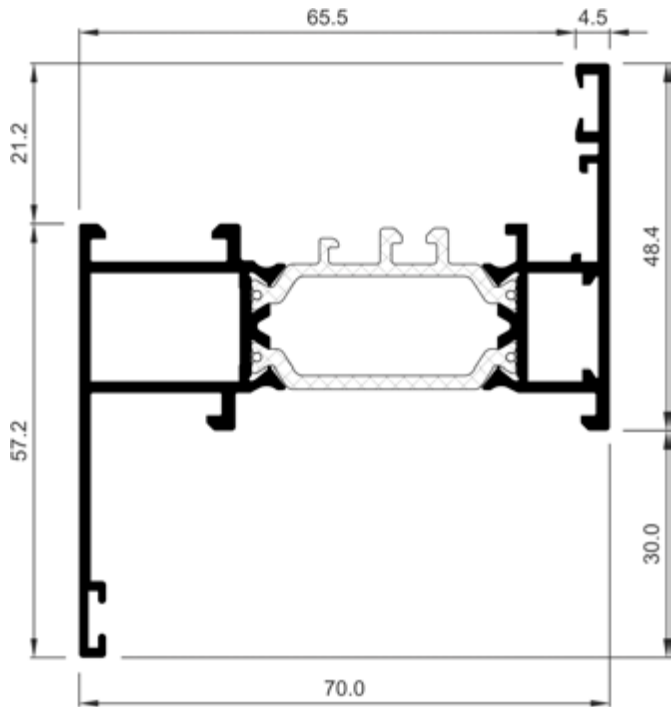

COR-7932	
Descripción Description	Marco ventana apertura interior con solape de 30 mm Inner opening window frame with 30 mm overlap
Peso Weight (g/m)	1398,2
Superficie Surface (dm²/m)	54,36
Ix (cm⁴)	10,1
Iy (cm⁴)	32,6
Escuadra principal Main cleat	327922
Troquel Punch tool	366799
Escuadra secundaria Secondary cleat	327920
Escuadra alineamiento Alignment cleat	296838
	960023

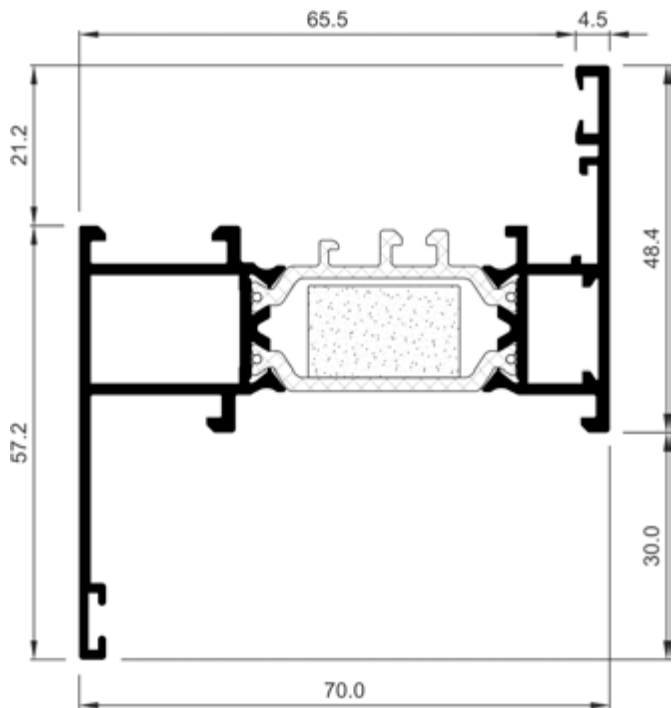

COR-7933	
Descripción Description	Marco ventana apertura interior HI con solape de 30 mm Inner opening HI window frame with 30 mm overlap
Peso Weight (g/m)	1398,2
Superficie Surface (dm²/m)	54,36
Ix (cm⁴)	10,1
Iy (cm⁴)	32,6
Escuadra principal Main cleat	327922
Troquel Punch tool	366799
Escuadra secundaria Secondary cleat	327920
Escuadra alineamiento Alignment cleat	296838
	960023

COR 70 C16 ST  
Perfis à escala

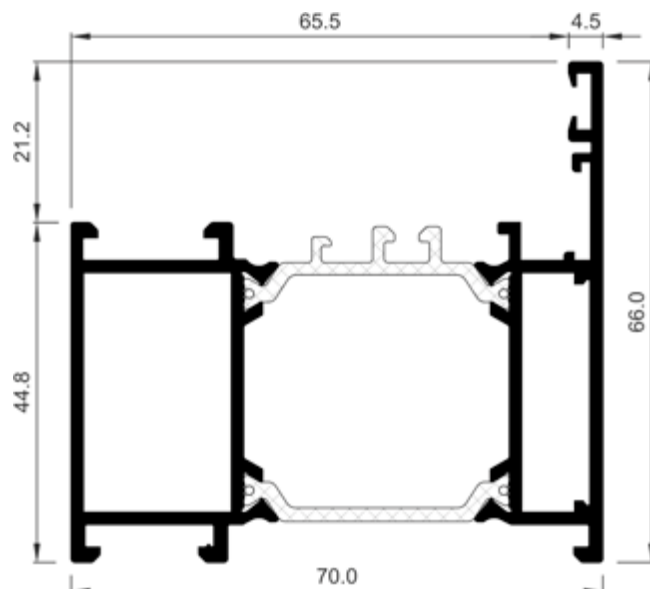

COR-7935	
<b>Descripción</b> Description	Marco balconera apertura interior Inner opening balcony frame
<b>Peso</b> Weight (g/m)	1614,2
<b>Superficie</b> Surface (dm <sup>2</sup> /m)	61,19
<b>Ix (cm<sup>4</sup>)</b>	14,27
<b>Iy (cm<sup>4</sup>)</b>	36,33
<b>Escuadra principal</b> Main cleat	327923
<b>Troquel</b> Punch tool	366799
<b>Escuadra secundaria</b> Secondary cleat	327924
<b>Escuadra alineamiento</b> Alignment cleat	296838

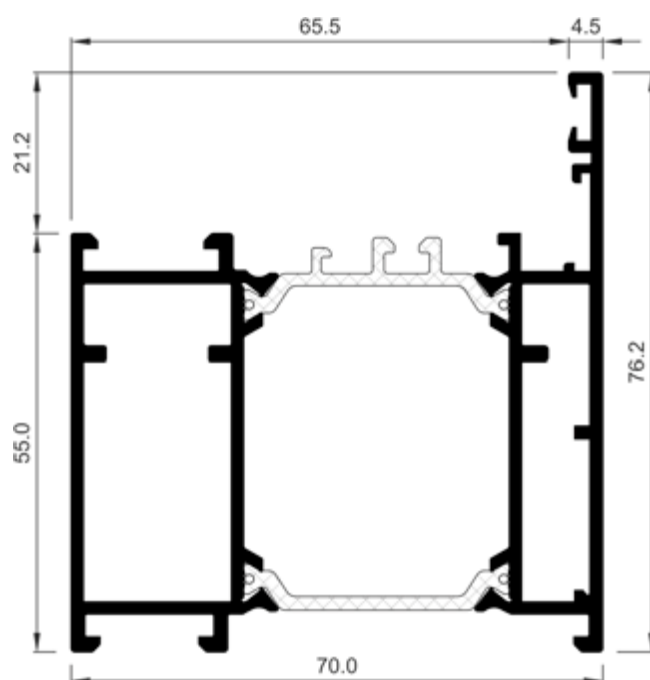

COR-7936	
<b>Descripción</b> Description	Marco balconera embutir recogedor Balcony frame scoop cram
<b>Peso</b> Weight (g/m)	1846,4
<b>Superficie</b> Surface (dm <sup>2</sup> /m)	71,38
<b>Ix (cm<sup>4</sup>)</b>	23,17
<b>Iy (cm<sup>4</sup>)</b>	42,77
<b>Escuadra principal</b> Main cleat	327923
<b>Troquel</b> Punch tool	366799
<b>Escuadra secundaria</b> Secondary cleat	327924
<b>Escuadra alineamiento</b> Alignment cleat	296838



ALUMÍNIOS IBÉRICA, S.A.



PALA-MIGUEL S REIS, Lda.



ALUMÍNIOS DE VISEU, Lda.



ANGULAR - Aluminios, Lda.

COR 70 C16 ST  
Perfis à escala

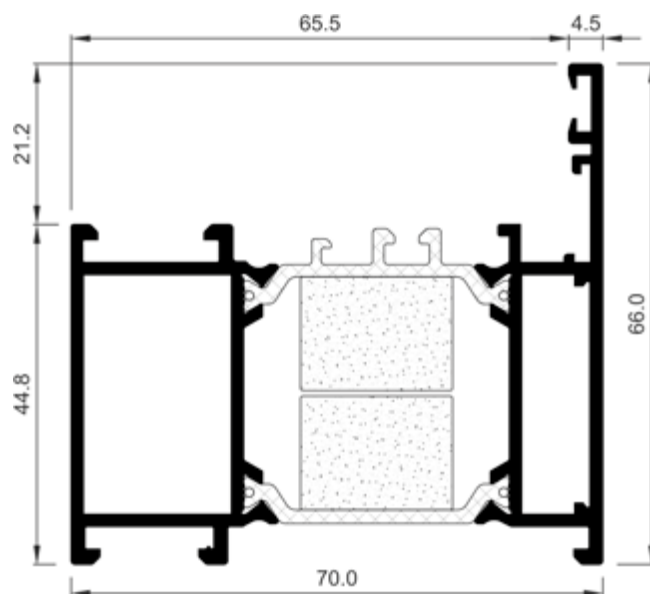

COR-7937	
Descripción Description	Marco balconera HI Balcony frame HI
Peso Weight (g/m)	1614,2
Superficie Surface (dm <sup>2</sup> /m)	61,19
Ix (cm <sup>4</sup> )	14,27
Iy (cm <sup>4</sup> )	36,33
Escuadra principal Main cleat	327923
Troquel Punch tool	366799
Escuadra secundaria Secondary cleat	327924
Escuadra alineamiento Alignment cleat	296838

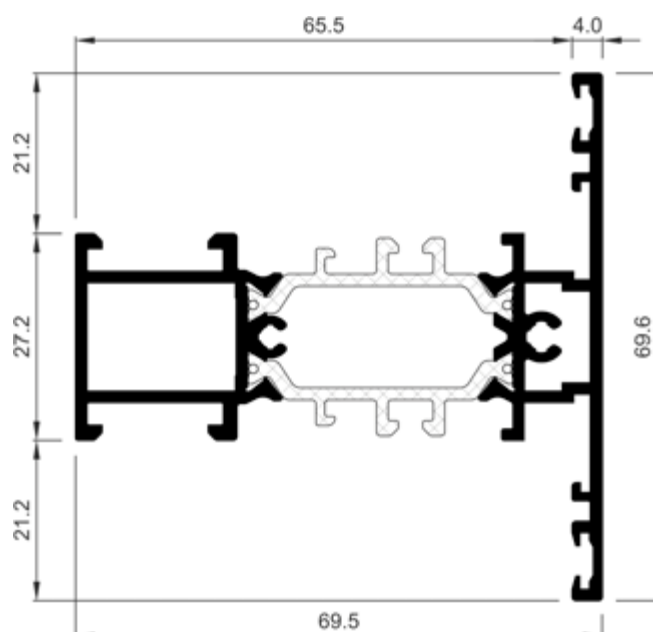

COR-7970	
Descripción Description	Travesaño ventana apertura interior Inner opening window transom
Peso Weight (g/m)	1454,9
Superficie Surface (dm <sup>2</sup> /m)	57,01
Ix (cm <sup>4</sup> )	8,07
Iy (cm <sup>4</sup> )	29,99
Fresa Miller	327991
Troquel Punch tool	366799
Tope travesaño interior Internal transom stop	920140
Tope travesaño exterior External transom stop	327971



ALUMINIOS IBÉRICA, S.A.



PALA-MIGUEL S REIS, Lda.



ALUMINIOS DE VISEULDA



ANGULAR - Aluminios, Lda.

COR 70 C16 ST  
Perfis à escala

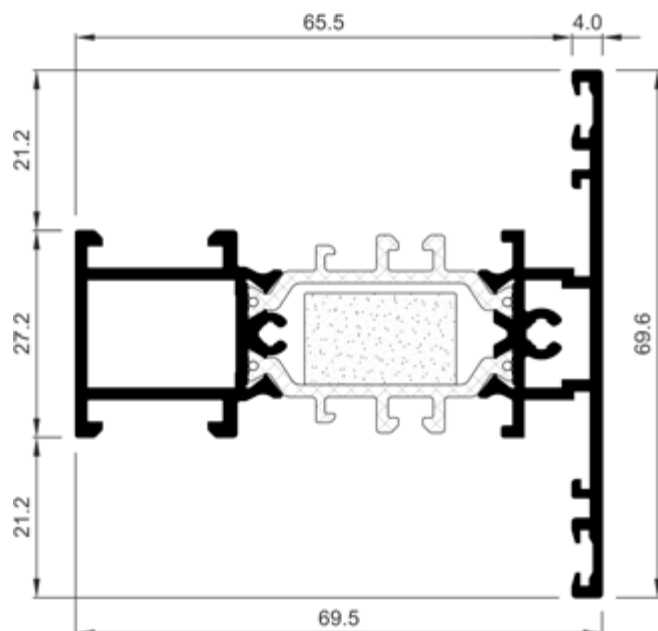

COR-7971	
<b>Descripción</b> Description	Travesaño ventana apertura interior HI Inner opening HI window transom
<b>Peso</b> Weight (g/m)	1454,9
<b>Superficie</b> Surface (dm <sup>2</sup> /m)	57,01
<b>Ix (cm<sup>4</sup>)</b>	8,07
<b>Iy (cm<sup>4</sup>)</b>	29,99
<b>Fresa</b> Miller	327991
<b>Troquel</b> Punch tool	366799
<b>Tope travesaño interior</b> Internal transom stop	920140
<b>Tope travesaño exterior</b> External transom stop	327971

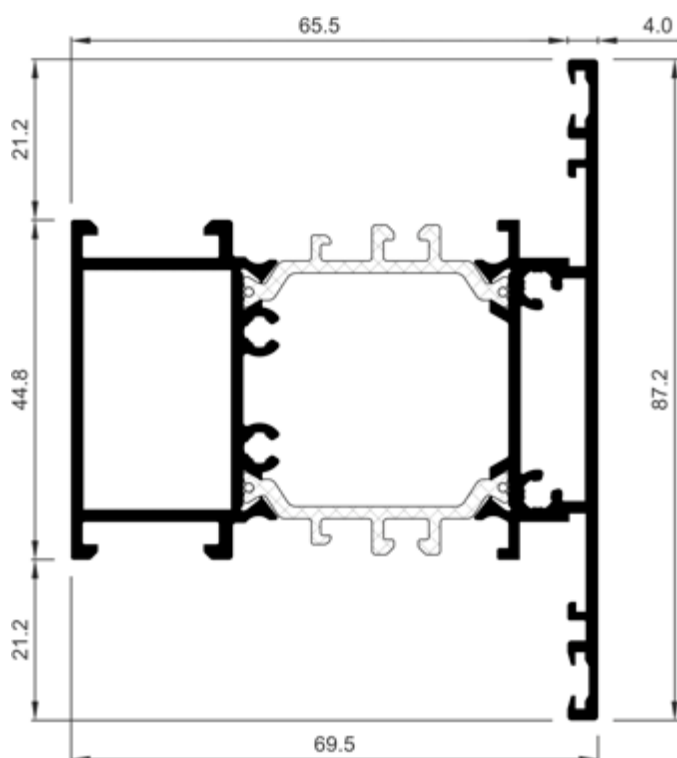

COR-7975	
<b>Descripción</b> Description	Travesaño balconera apertura interior Inner opening balcony transom
<b>Peso</b> Weight (g/m)	1846,4
<b>Superficie</b> Surface (dm <sup>2</sup> /m)	72,45
<b>Ix (cm<sup>4</sup>)</b>	20,38
<b>Iy (cm<sup>4</sup>)</b>	40,3
<b>Fresa</b> Miller	327991
<b>Troquel</b> Punch tool	366799
<b>Tope travesaño interior</b> Internal transom stop	920150
<b>Tope travesaño exterior</b> External transom stop	327971



ALUMINIOS IBÉRICA, S.A.



PALA-MIGUEL S REIS, Lda.



ALUMINIOS DE VISEU Lda.



ANGULAR - Aluminios, Lda.

COR 70 C16 ST  
 Perfis à escala

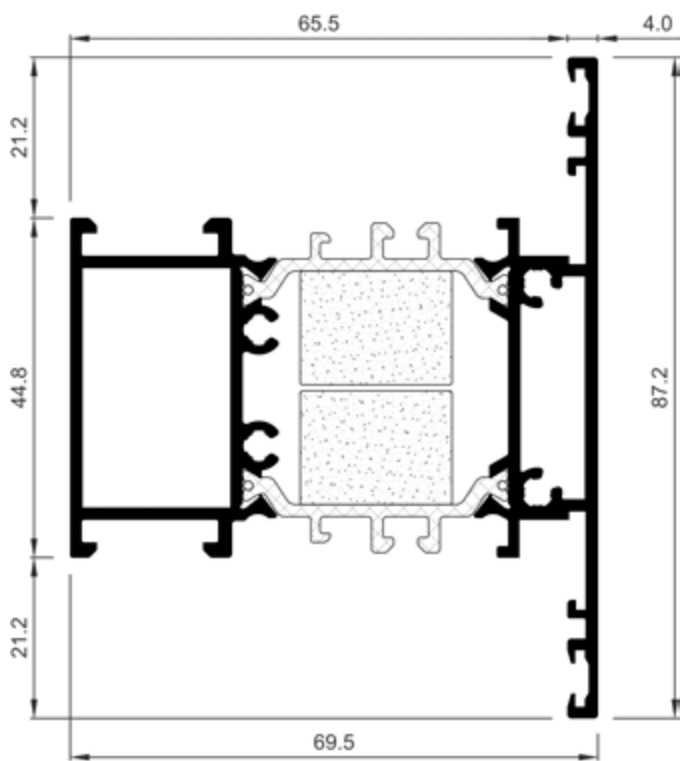

COR-7976	
Descripción Description	Travesaño balconera HI HI balcony transom
Peso Weight (g/m)	1846,4
Superficie Surface (dm²/m)	72,45
Ix (cm⁴)	20,38
Iy (cm⁴)	40,3
Fresa Miller	327991
Troquel Punch tool	366799
Tope travesaño interior Internal transom stop	920150
Tope travesaño exterior External transom stop	327971



COR 70 C16 ST  
Perfis à escala

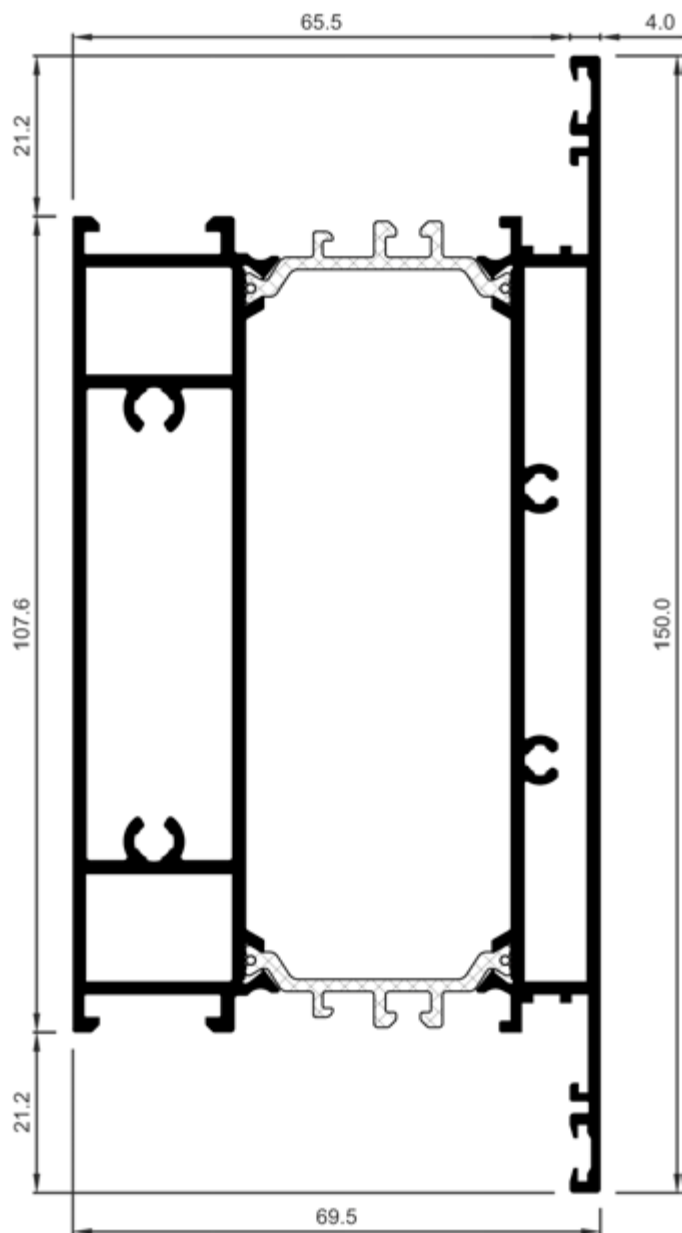

COR-7977	
Descripción Description	Travesaño de 150 mm 150 mm transom
Peso Weight (g/m)	3388,1
Superficie Surface (dm²/m)	133,34
Ix (cm⁴)	160,11
Iy (cm⁴)	84,35
Fresa Miller	327991
Troquel Punch tool	366799
Tope travesaño interior Internal transom stop	920140
Tope travesaño exterior External transom stop	327971

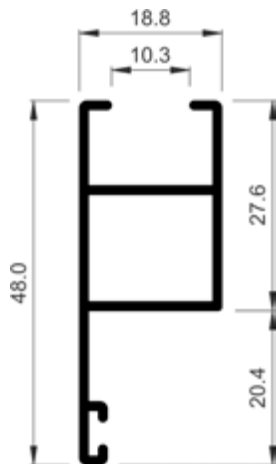

770226	
Descripción Description	Hoja de contra recta Straight shutter sash
Peso Weight (g/m)	399,6
Superficie Surface (dm²/m)	24,06
Ix (cm⁴)	2,5
Iy (cm⁴)	0,81
Escuadra principal Main cleat	920425
Troquel Punch tool	366799
Observaciones Observations	CONSULTAR DISPONIBILIDAD CHECK AVAILABILITY

COR 70 C16 ST  
Perfis à escala

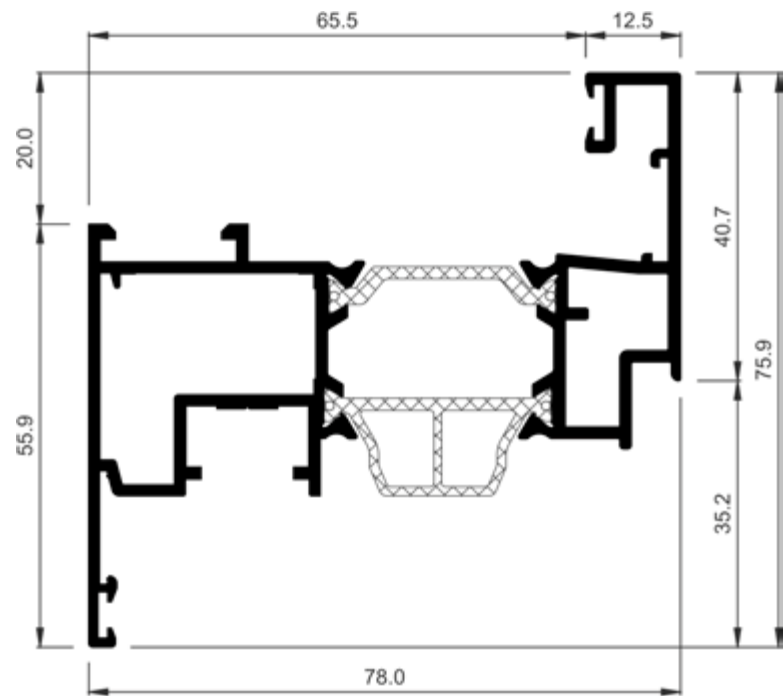

COR-6720	
Descripción Description	Hoja ventana apertura interior Inner opening window sash
Peso Weight (g/m)	1679
Superficie Surface (dm²/m)	69,07
Ix (cm⁴)	13,96
Iy (cm⁴)	43,51
Escuadra principal Main cleat	273520
Troquel Punch tool	366799
Escuadra secundaria Secondary cleat	327920
Escuadra alineamiento Alignment cleat	296838
	920135

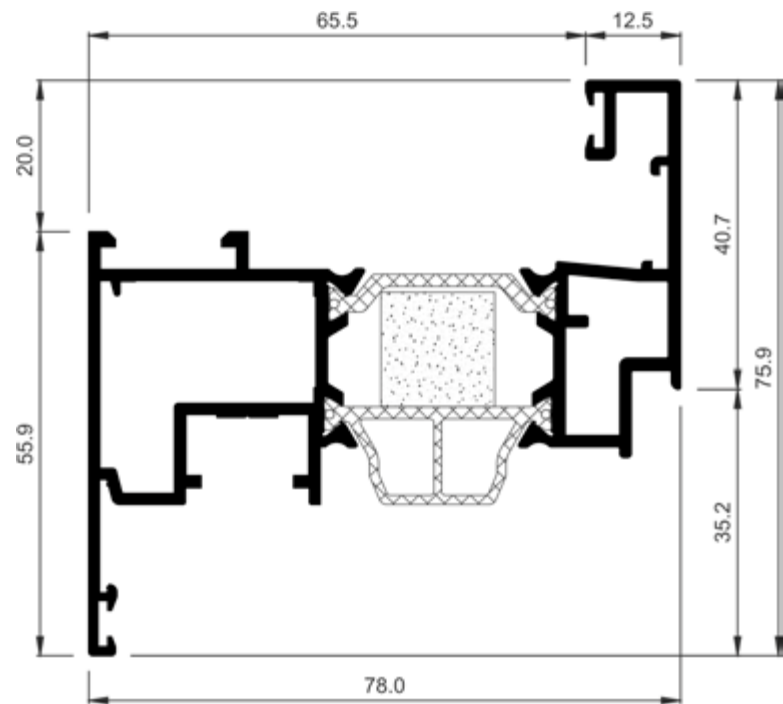

COR-6721	
Descripción Description	Hoja ventana apertura interior HI Inner opening window sash HI
Peso Weight (g/m)	1679
Superficie Surface (dm²/m)	69,07
Ix (cm⁴)	13,96
Iy (cm⁴)	43,51
Escuadra principal Main cleat	273520
Troquel Punch tool	366799
Escuadra secundaria Secondary cleat	327920
Escuadra alineamiento Alignment cleat	296838
	920135



COR 70 C16 ST  
Perfis à escala

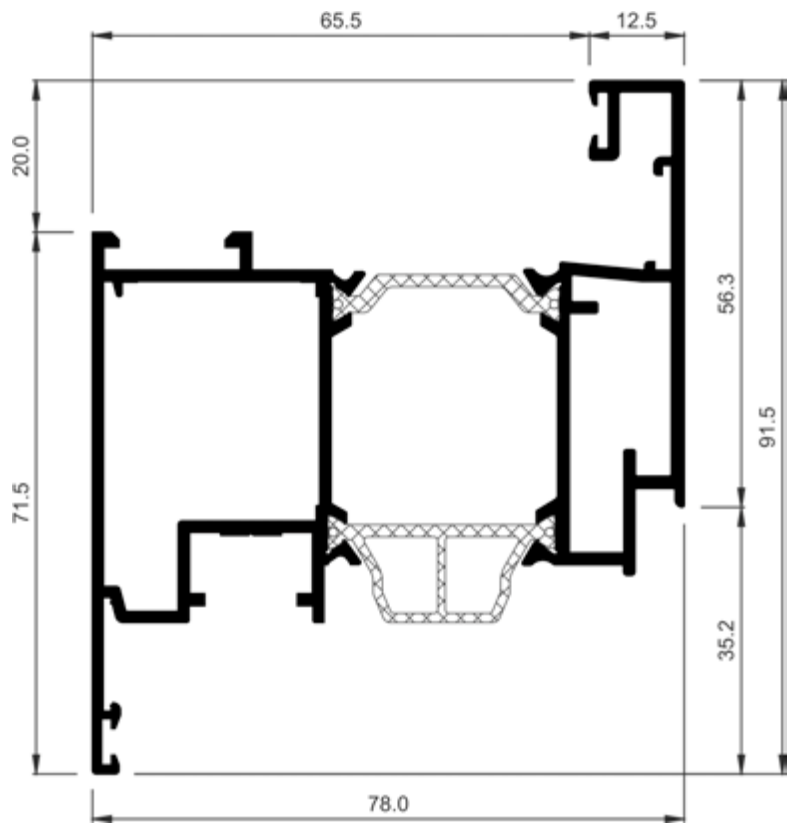

COR-6722	
Descripción Description	Hoja balconera apertura interior inner opening balcony sash
Peso Weight (g/m)	1965,2
Superficie Surface (dm²/m)	82,47
Ix (cm⁴)	28,32
Iy (cm⁴)	53,23
Escuadra principal Main cleat	273524
Troquel Punch tool	366799
Escuadra secundaria Secondary cleat	327924
Escuadra alineamiento Alignment cleat	296838
	920135

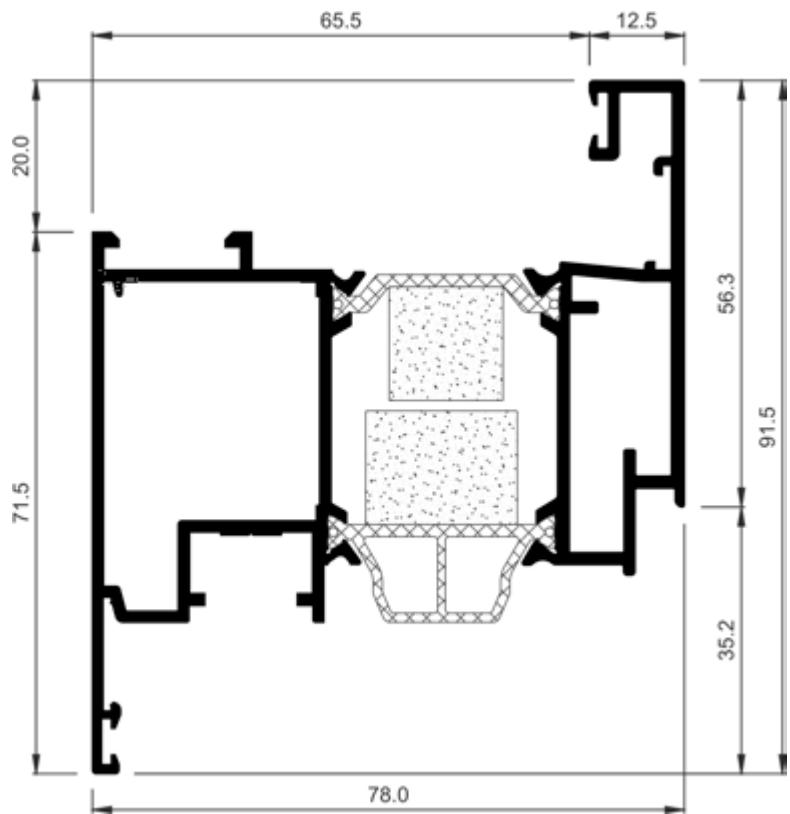

COR-6723	
Descripción Description	Hoja balconera apertura interior HI inner opening balcony sash HI
Peso Weight (g/m)	1965,2
Superficie Surface (dm²/m)	82,47
Ix (cm⁴)	28,32
Iy (cm⁴)	53,23
Escuadra principal Main cleat	273524
Troquel Punch tool	366799
Escuadra secundaria Secondary cleat	327924
Escuadra alineamiento Alignment cleat	296838
	920135

COR 70 C16 ST  
Perfis à escala

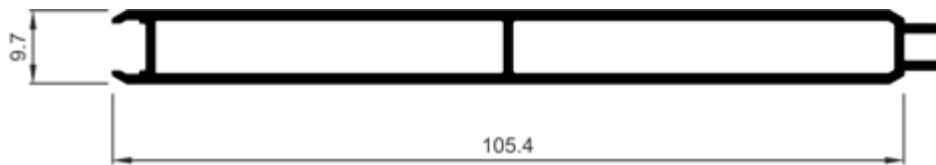

COR-2366	
Descripción Description	Lama contra de ventana Window louvre
Peso Weight (g/m)	796,5
Superficie Surface (dm²/m)	47,49
Ix (cm⁴)	0,48
Iy (cm⁴)	30,48

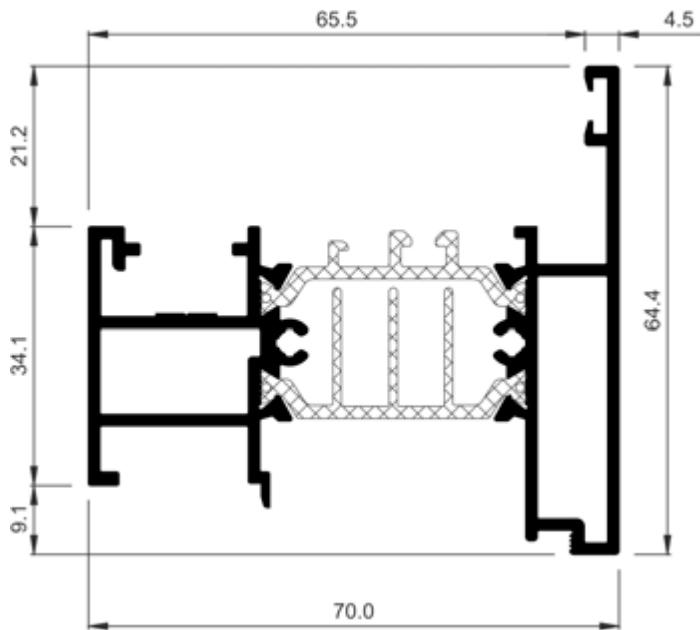

COR-6740	
Descripción Description	Inversor apertura interior Inner opening inverter
Peso Weight (g/m)	1560,2
Superficie Surface (dm²/m)	60,71
Ix (cm⁴)	9,42
Iy (cm⁴)	32,67
Tapas Covers	366740
Tornillería Screws	813922

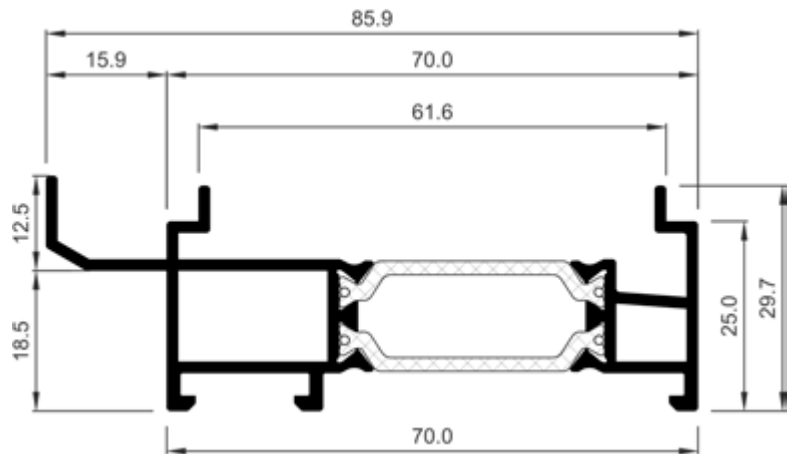

COR-7960	
Descripción Description	Condensación Condensation
Peso Weight (g/m)	1179,5
Superficie Surface (dm²/m)	43,39
Ix (cm⁴)	2,01
Iy (cm⁴)	27,86
Tapas Covers	257200

COR 70 C16 ST  
Perfis à escala

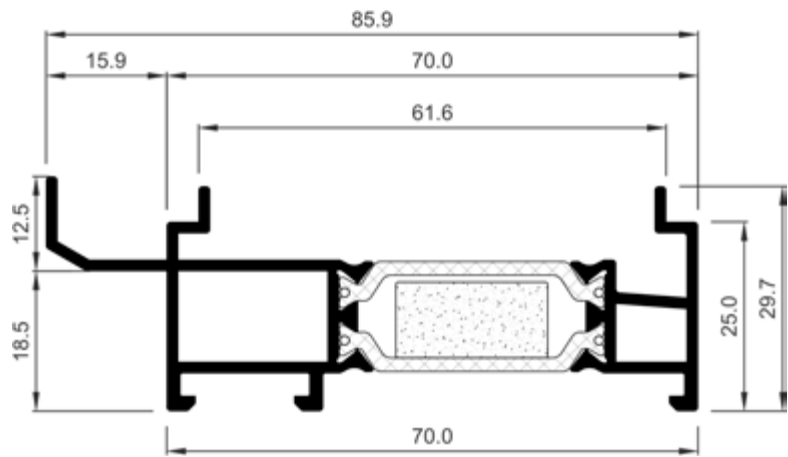

COR-7961	
Descripción Description	Condensación HI HI condensation
Peso Weight (g/m)	1179,5
Superficie Surface (dm²/m)	43,39
Ix (cm⁴)	2,01
Iy (cm⁴)	27,86
Tapas Covers	257200

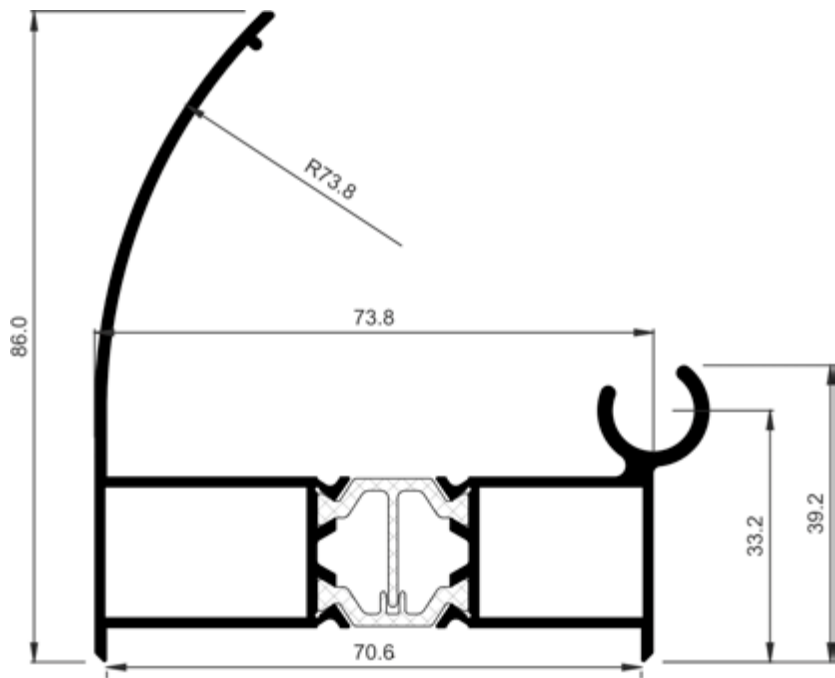

COR-7357	
Descripción Description	Esquinero regulable hembra Adjustable corne female
Peso Weight (g/m)	1521
Superficie Surface (dm²/m)	63,05
Ix (cm⁴)	21,09
Iy (cm⁴)	37,2



ALUMINIOS IBÉRICA, S.A.



PALA-MIGUEL S REIS, Lda.



ALUMINIOS DE VISEULDA



ANGULAR - Aluminios, Lda.

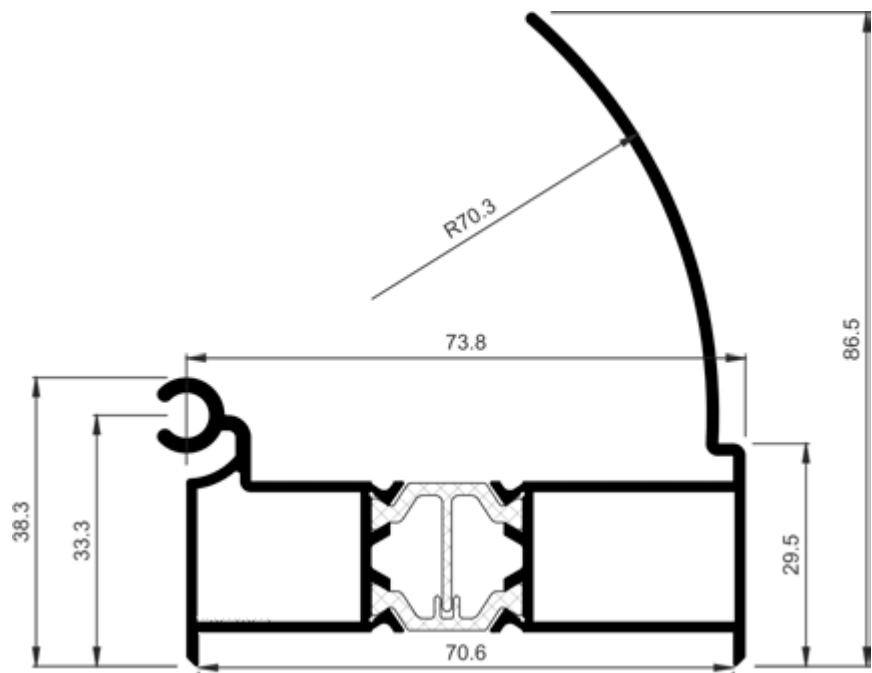

COR-7358	
Descripción Description	Esquinero regulable macho Adjustable corne male
Peso Weight (g/m)	1512,9
Superficie Surface (dm²/m)	63,84
Ix (cm⁴)	20,98
Iy (cm⁴)	33,3

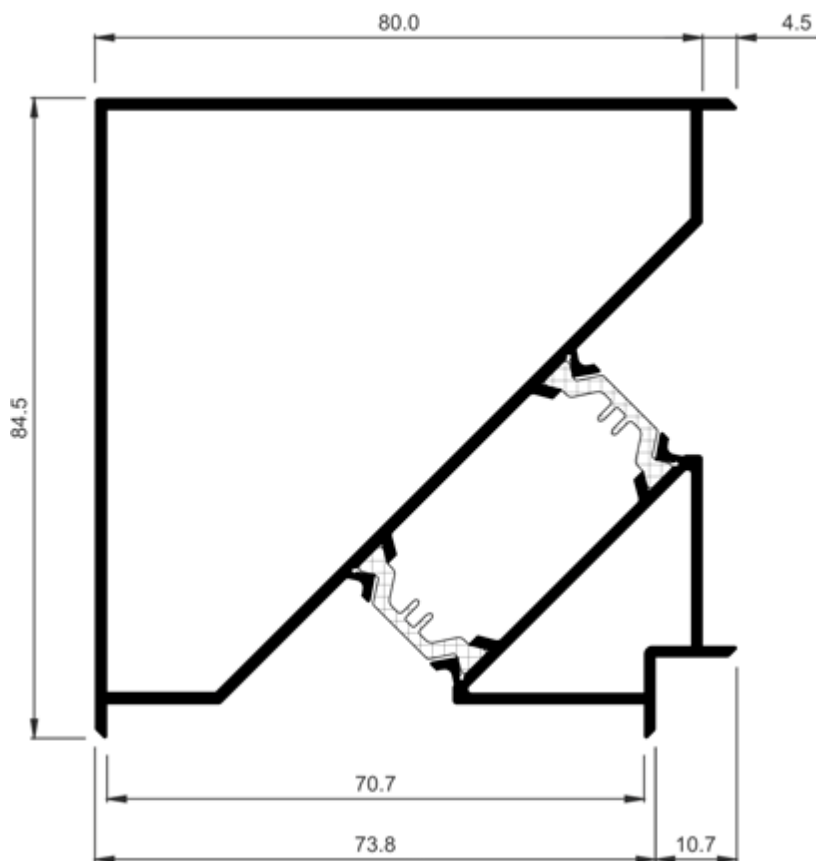

COR-7359	
Descripción Description	Esquinero recto Straight corner
Peso Weight (g/m)	2017,1
Superficie Surface (dm²/m)	86,55
Ix (cm⁴)	56,75
Iy (cm⁴)	56,75



ALUMINIOS IBÉRICA, S.A.



PALA-MIGUEL S REIS, Lda.



ALUMINIOS DE VISEULDA



ANGULAR - Aluminios, Lda.

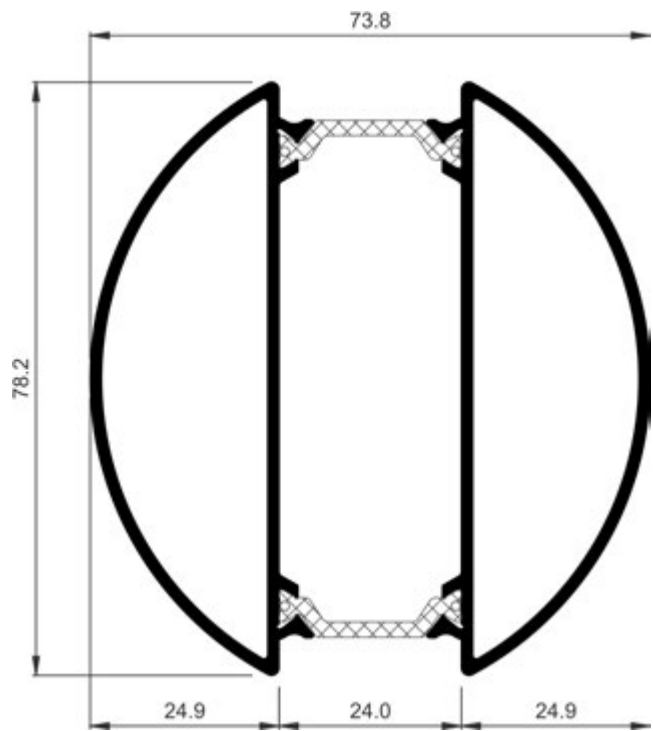

COR-7980	
Descripción Description	Esquinero regulable Adjustable corner
Peso Weight (g/m)	1706,6
Superficie Surface (dm <sup>2</sup> /m)	74,14
I <sub>x</sub> (cm <sup>4</sup> )	32,41
I <sub>y</sub> (cm <sup>4</sup> )	27,95

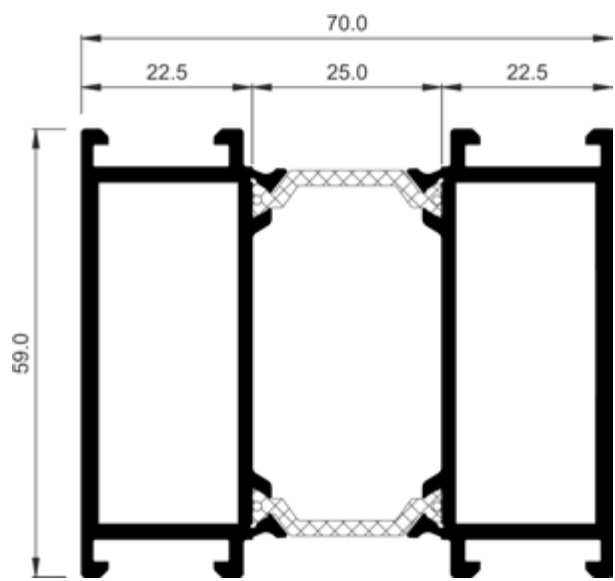

COR-7985	
Descripción Description	Suplemento marco Frame supplement
Peso Weight (g/m)	2061,4
Superficie Surface (dm <sup>2</sup> /m)	70,38
I <sub>x</sub> (cm <sup>4</sup> )	25,2
I <sub>y</sub> (cm <sup>4</sup> )	43,28

COR 70 C16 ST  
Perfis à escala

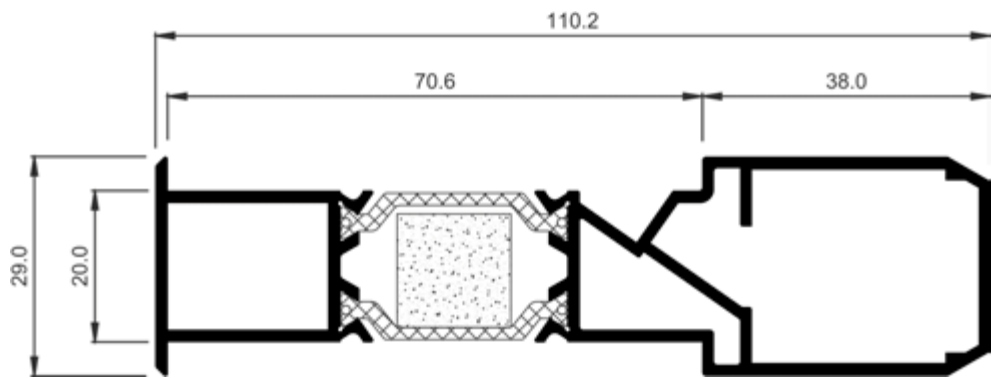

COR-6755	
Descripción Description	Unión de marcos con refuerzo HI Frame joint profile with reinforcement HI
Peso Weight (g/m)	1624,6
Superficie Surface (dm²/m)	63,21
Ix (cm⁴)	4,47
Iy (cm⁴)	61,78
Tapas Covers	257201

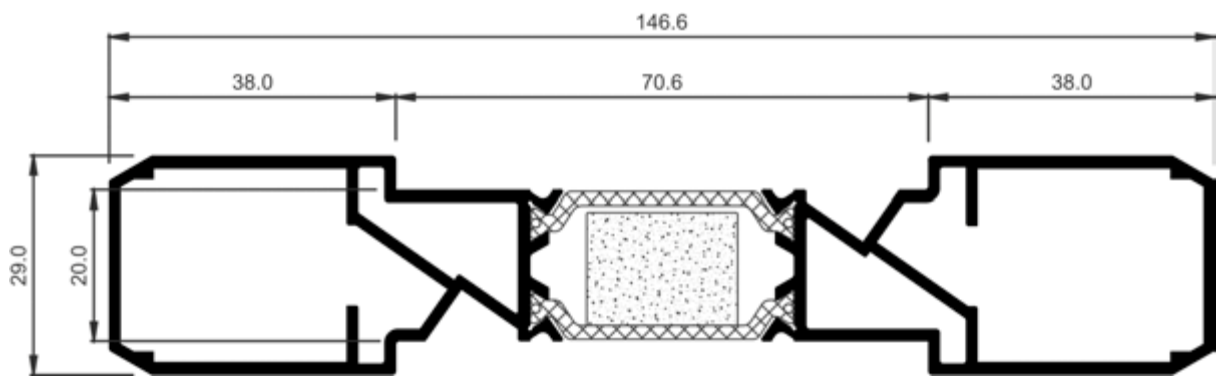

COR-6756	
Descripción Description	Unión de marcos con doble refuerzo HI Frame joint profile with double reinforcement
Peso Weight (g/m)	2072,8
Superficie Surface (dm²/m)	83,54
Ix (cm⁴)	6,79
Iy (cm⁴)	142,58
Tapas Covers	257201

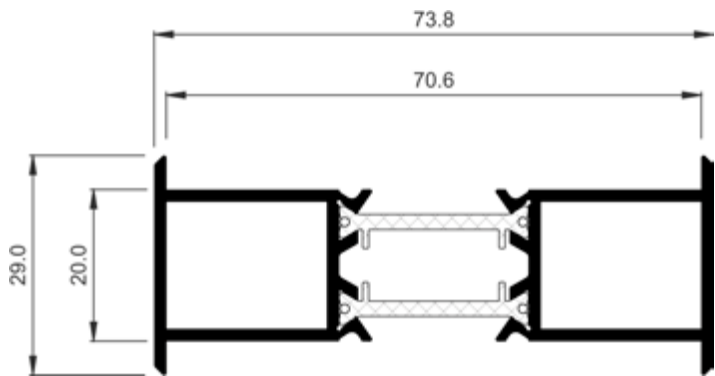

COR-7354	
Descripción Description	Unión de marcos Frame joint profile
Peso Weight (g/m)	1116,4
Superficie Surface (dm²/m)	42,88
Ix (cm⁴)	2,17
Iy (cm⁴)	22,14

COR 70 C16 ST  
Perfis à escala

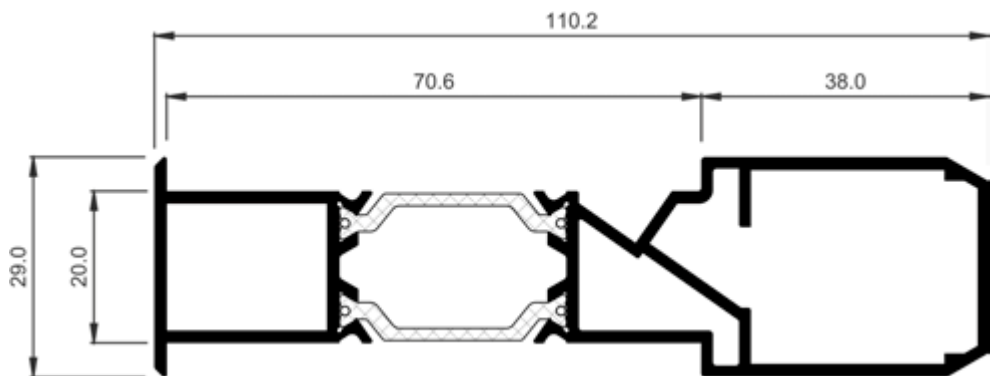

COR-7355	
Descripción Description	Unión de marcos con refuerzo Frame joint profile with reinforcement
Peso Weight (g/m)	1624,6
Superficie Surface (dm²/m)	63,21
Ix (cm⁴)	4,47
Iy (cm⁴)	61,78
Tapas Covers	257201

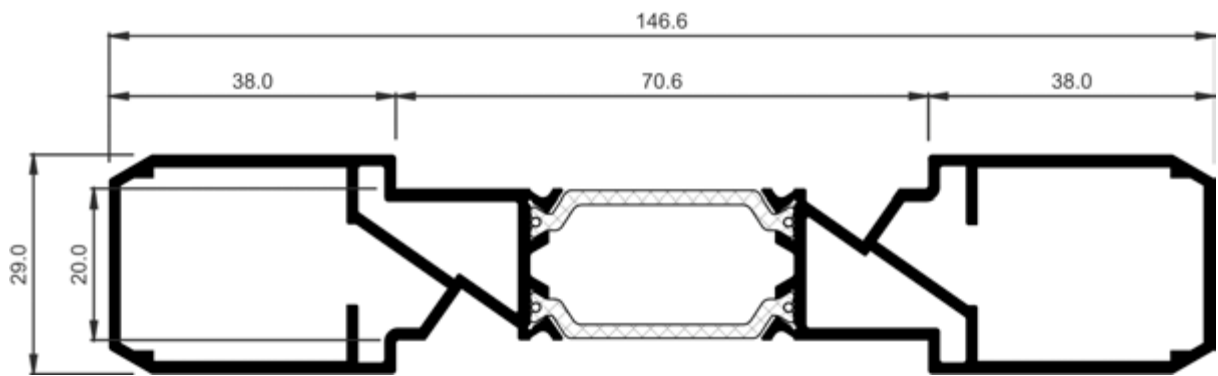

COR-7356	
Descripción Description	Unión de marcos con doble refuerzo Frame joint profile with double reinforcement
Peso Weight (g/m)	2072,8
Superficie Surface (dm²/m)	83,54
Ix (cm⁴)	6,79
Iy (cm⁴)	142,58
Tapas Covers	257201



COR-2012	
Descripción Description	Grapa para junquillos Glazing bead clip
Peso Weight (g/m)	113,4
Superficie Surface (dm²/m)	7,65
Ix (cm⁴)	0,03
Iy (cm⁴)	0,12



COR 70 C16 ST  
Perfis à escala

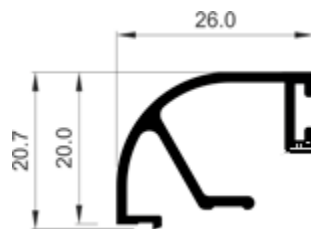

COR-2013	
<b>Descripción</b> Description	Junquillo curvo grapa 26 mm Curve glazing bead clip 26 mm
<b>Peso</b> Weight (g/m)	280,8
<b>Superficie</b> Surface (dm <sup>2</sup> /m)	15,71
<b>Ix (cm<sup>4</sup>)</b>	0,42
<b>Iy (cm<sup>4</sup>)</b>	0,74
<b>Varios</b> Various	252012

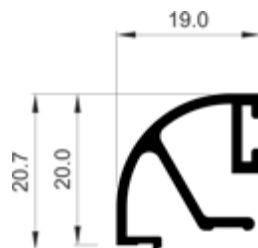

COR-2014	
<b>Descripción</b> Description	Junquillo curvo grapa 19 mm Curve glazing bead clip 19 mm
<b>Peso</b> Weight (g/m)	256,5
<b>Superficie</b> Surface (dm <sup>2</sup> /m)	14,31
<b>Ix (cm<sup>4</sup>)</b>	0,35
<b>Iy (cm<sup>4</sup>)</b>	0,35
<b>Varios</b> Various	252012

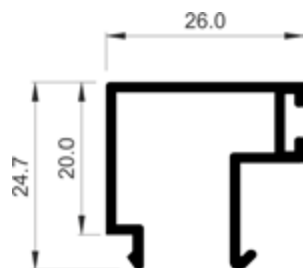

COR-2015	
<b>Descripción</b> Description	Junquillo clip recto de 26 mm Straight glazing bead clip 26 mm
<b>Peso</b> Weight (g/m)	321,3
<b>Superficie</b> Surface (dm <sup>2</sup> /m)	18,04
<b>Ix (cm<sup>4</sup>)</b>	0,75
<b>Iy (cm<sup>4</sup>)</b>	0,97

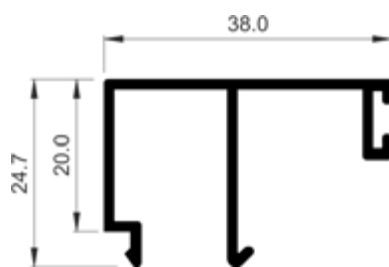

COR-2016	
<b>Descripción</b> Description	Junquillo clip recto de 38 mm Straight glazing bead clip 38 mm
<b>Peso</b> Weight (g/m)	375,3
<b>Superficie</b> Surface (dm <sup>2</sup> /m)	21,15
<b>Ix (cm<sup>4</sup>)</b>	0,87
<b>Iy (cm<sup>4</sup>)</b>	2,18

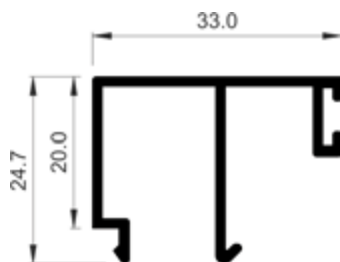

COR-2017	
<b>Descripción</b> Description	Junquillo clip recto de 33 mm Straight glazing bead clip 33 mm
<b>Peso</b> Weight (g/m)	356,4
<b>Superficie</b> Surface (dm <sup>2</sup> /m)	20,15
<b>Ix (cm<sup>4</sup>)</b>	0,83
<b>Iy (cm<sup>4</sup>)</b>	1,56

COR 70 C16 ST  
Perfis à escala

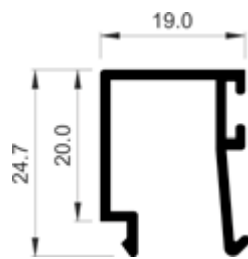

COR-2018	
<b>Descripción</b> Description	Junquillo clip recto de 19 mm Straight glazing bead clip 19 mm
<b>Peso</b> Weight (g/m)	275,4
<b>Superficie</b> Surface (dm <sup>2</sup> /m)	15,52
<b>Ix (cm<sup>4</sup>)</b>	0,67
<b>Iy (cm<sup>4</sup>)</b>	0,53

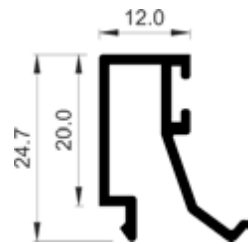

COR-2019	
<b>Descripción</b> Description	Junquillo clip recto de 12 mm Straight glazing bead clip 12 mm
<b>Peso</b> Weight (g/m)	261,9
<b>Superficie</b> Surface (dm <sup>2</sup> /m)	14,77
<b>Ix (cm<sup>4</sup>)</b>	0,61
<b>Iy (cm<sup>4</sup>)</b>	0,27

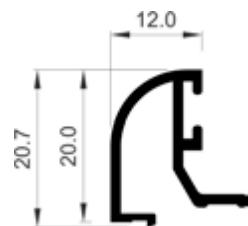

COR-2021	
<b>Descripción</b> Description	Junquillo curvo grapa 12 mm Curve glazing bead clip 12 mm
<b>Peso</b> Weight (g/m)	216
<b>Superficie</b> Surface (dm <sup>2</sup> /m)	12,55
<b>Ix (cm<sup>4</sup>)</b>	0,31
<b>Iy (cm<sup>4</sup>)</b>	0,18
<b>Varios</b> Various	252012



COR-2023	
<b>Descripción</b> Description	Junquillo recto de 2,5 mm 2,5 Straight glazing bead clip
<b>Peso</b> Weight (g/m)	151,2
<b>Superficie</b> Surface (dm <sup>2</sup> /m)	8,71
<b>Ix (cm<sup>4</sup>)</b>	0,32
<b>Iy (cm<sup>4</sup>)</b>	0,21



COR-2038	
<b>Descripción</b> Description	Junquillo curvo grapa 33 mm Curve glazing bead clip 33 mm
<b>Peso</b> Weight (g/m)	307,8
<b>Superficie</b> Surface (dm <sup>2</sup> /m)	17,32
<b>Ix (cm<sup>4</sup>)</b>	0,47
<b>Iy (cm<sup>4</sup>)</b>	1,37
<b>Varios</b> Various	252012

COR 70 C16 ST  
Perfis à escala

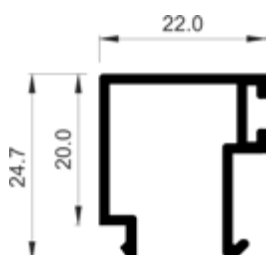
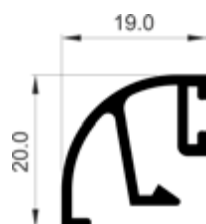
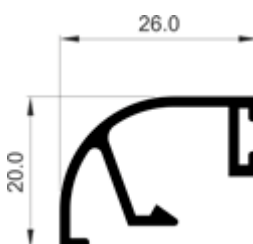
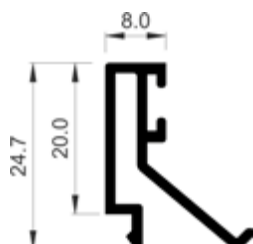
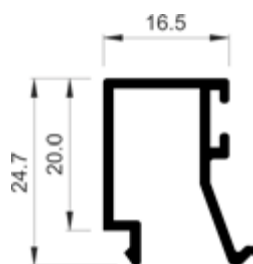

COR-2065	
Descripción Description	Junquillo clip recto de 16,50 mm Straight glazing bead clip 16,50 mm
Peso Weight (g/m)	270
Superficie Surface (dm <sup>2</sup> /m)	15,13
Ix (cm <sup>4</sup> )	0,65
Iy (cm <sup>4</sup> )	0,41

COR-2093	
Descripción Description	Junquillo clip recto de 8 mm Straight glazing bead clip 8 mm
Peso Weight (g/m)	256,5
Superficie Surface (dm <sup>2</sup> /m)	14,51
Ix (cm <sup>4</sup> )	0,56
Iy (cm <sup>4</sup> )	0,23

COR-2113	
Descripción Description	Junquillo curvo grapa plástica 26 mm Curve glazing bead plastic clip 26 mm
Peso Weight (g/m)	272,7
Superficie Surface (dm <sup>2</sup> /m)	15
Ix (cm <sup>4</sup> )	0,36
Iy (cm <sup>4</sup> )	0,72
Varios Various	212001

COR-2114	
Descripción Description	Junquillo curvo grapa plástica 19 mm Curve glazing bead plastic clip 19 mm
Peso Weight (g/m)	251,1
Superficie Surface (dm <sup>2</sup> /m)	13,74
Ix (cm <sup>4</sup> )	0,31
Iy (cm <sup>4</sup> )	0,31
Varios Various	212001

COR-2117	
Descripción Description	Junquillo clip recto de 22 mm Straight glazing bead clip 22 mm
Peso Weight (g/m)	294,3
Superficie Surface (dm <sup>2</sup> /m)	16,44
Ix (cm <sup>4</sup> )	0,7
Iy (cm <sup>4</sup> )	0,69



ALUMINIOS IBÉRICA, S.A.



PALA-MIGUEL S REIS, Lda.



ALUMINIOS DE VISEU Lda.



ANGULAR - Alumínios, Lda.

COR 70 C16 ST  
Perfis à escala

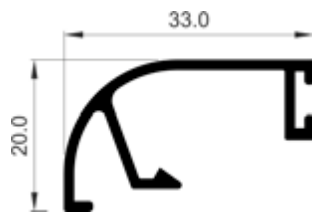

COR-2138	
<b>Descripción</b> Description	Junquillo curvo grapa plástica 33 mm Curve glazing bead plastic clip 33 mm
<b>Peso</b> Weight (g/m)	294,3
<b>Superficie</b> Surface (dm <sup>2</sup> /m)	16,15
<b>Ix (cm<sup>4</sup>)</b>	0,41
<b>Iy (cm<sup>4</sup>)</b>	1,35
<b>Varios</b> Various	212001

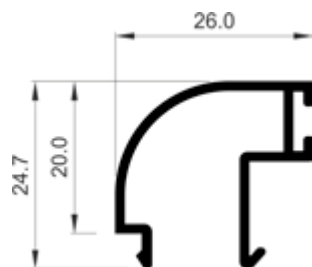

COR-2313	
<b>Descripción</b> Description	Junquillo curvo 26 mm Curve glazing bead 26 mm
<b>Peso</b> Weight (g/m)	278,1
<b>Superficie</b> Surface (dm <sup>2</sup> /m)	16,99
<b>Ix (cm<sup>4</sup>)</b>	0,61
<b>Iy (cm<sup>4</sup>)</b>	0,76

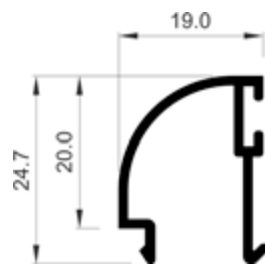

COR-2314	
<b>Descripción</b> Description	Junquillo curvo 19 mm Curve glazing bead 19 mm
<b>Peso</b> Weight (g/m)	237,6
<b>Superficie</b> Surface (dm <sup>2</sup> /m)	14,5
<b>Ix (cm<sup>4</sup>)</b>	0,52
<b>Iy (cm<sup>4</sup>)</b>	0,41

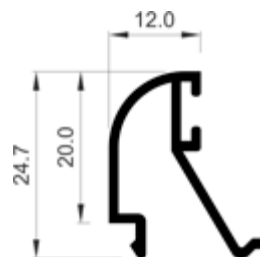

COR-2321	
<b>Descripción</b> Description	Junquillo curvo 12 mm Curve glazing bead 12 mm
<b>Peso</b> Weight (g/m)	228,5
<b>Superficie</b> Surface (dm <sup>2</sup> /m)	13,98
<b>Ix (cm<sup>4</sup>)</b>	0,49
<b>Iy (cm<sup>4</sup>)</b>	0,24

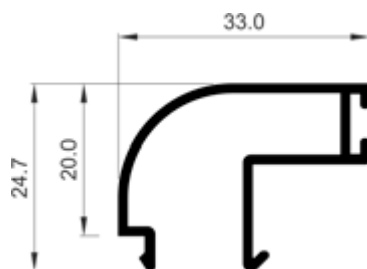

COR-2338	
<b>Descripción</b> Description	Junquillo curvo 33 mm Curve glazing bead 33 mm
<b>Peso</b> Weight (g/m)	326,7
<b>Superficie</b> Surface (dm <sup>2</sup> /m)	19,91
<b>Ix (cm<sup>4</sup>)</b>	0,68
<b>Iy (cm<sup>4</sup>)</b>	1,35

COR 70 C16 ST  
Perfis à escala

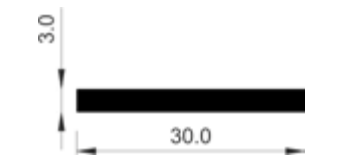

603003	
Descripción Description	Pletina de 30x3 mm Plate 30x3mm
Peso Weight (g/m)	243
Superficie Surface (dm²/m)	6,6
Ix (cm⁴)	-
Iy (cm⁴)	-

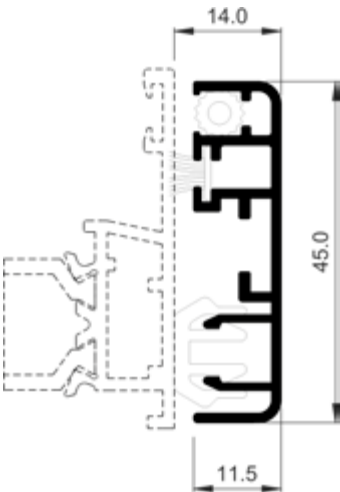

COR-2170	
Descripción Description	Mosquitera fija Fixed insect screen
Peso Weight (g/m)	405
Superficie Surface (dm²/m)	24,41
Ix (cm⁴)	3,02
Iy (cm⁴)	0,19
Varios Various	272170
Juntas Gaskets	272100
	950040
Escuadra alineamiento Alignment cleat	245054
Observaciones Observations	Telas mosquitera 272125/26/27/28 Mosquito net 272125/26/27/28

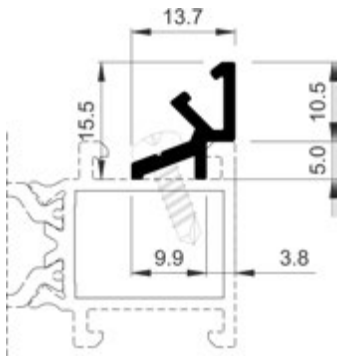

COR-2714	
Descripción Description	Acople esquinero regulable Adjustable corner attachment
Peso Weight (g/m)	162
Superficie Surface (dm²/m)	7,34
Ix (cm⁴)	0,1
Iy (cm⁴)	0,08
Observaciones Observations	Tornillo Ø3.5 mm DIN7504N. Ø3.5 mm DIN7504Nscrew.



COR 70 C16 ST  
Perfis à escala

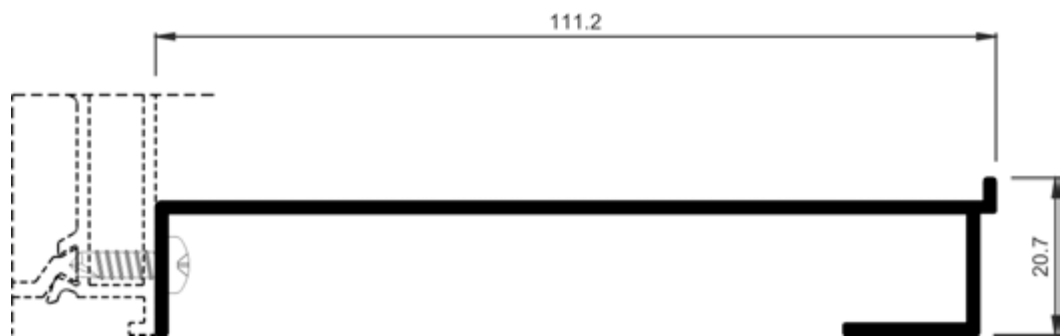

COR-2778	
Descripción Description	Peana de 110 mm 110 mm stand
Peso Weight (g/m)	696,6
Superficie Surface (dm²/m)	32,73
Ix (cm⁴)	0,89
Iy (cm⁴)	38,59
Tornillería Screws	853913

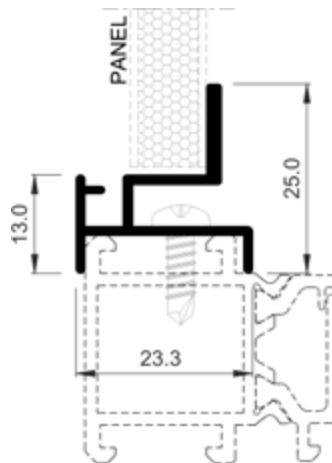

COR-2890	
Descripción Description	Complemento tapa registro (para panel) Register cover complement (for pannel)
Peso Weight (g/m)	264,6
Superficie Surface (dm²/m)	14,57
Ix (cm⁴)	0,36
Iy (cm⁴)	0,53
Juntas Gaskets	262810
Tornillería Screws	853913

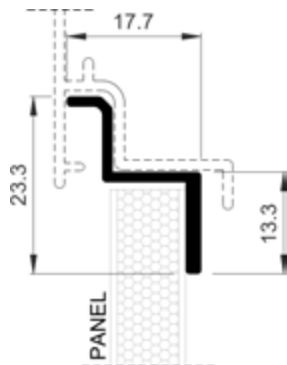

COR-2891	
Descripción Description	Asiento tapa registro Register cover seat
Peso Weight (g/m)	159,3
Superficie Surface (dm²/m)	7,92
Ix (cm⁴)	0,23
Iy (cm⁴)	0,19
Juntas Gaskets	262810

COR 70 C16 ST  
Perfis à escala

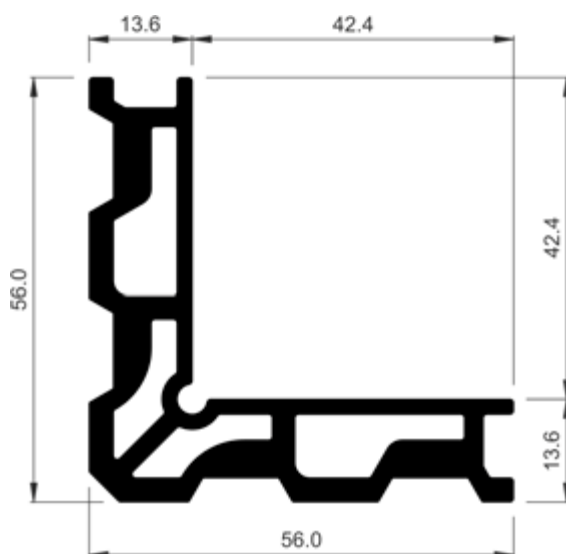

COR-3160	
<b>Descripción</b> Description	Perfil para escuadra de ensamblar de 13,60 mm Profile for assembly cleat - 13.60 mm
<b>Peso</b> Weight (g/m)	1884,6
<b>Superficie</b> Surface (dm <sup>2</sup> /m)	45,94
<b>I<sub>x</sub></b> (cm <sup>4</sup> )	18,6
<b>I<sub>y</sub></b> (cm <sup>4</sup> )	18,6

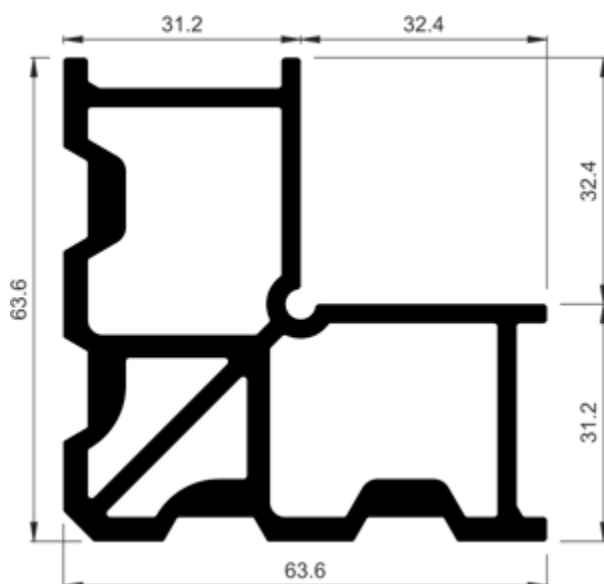

COR-3161	
<b>Descripción</b> Description	Perfil para escuadra de ensamblar de 31,20 mm Profile for assembly cleat - 31.20 mm
<b>Peso</b> Weight (g/m)	2651,4
<b>Superficie</b> Surface (dm <sup>2</sup> /m)	62,87
<b>I<sub>x</sub></b> (cm <sup>4</sup> )	34,52
<b>I<sub>y</sub></b> (cm <sup>4</sup> )	34,52

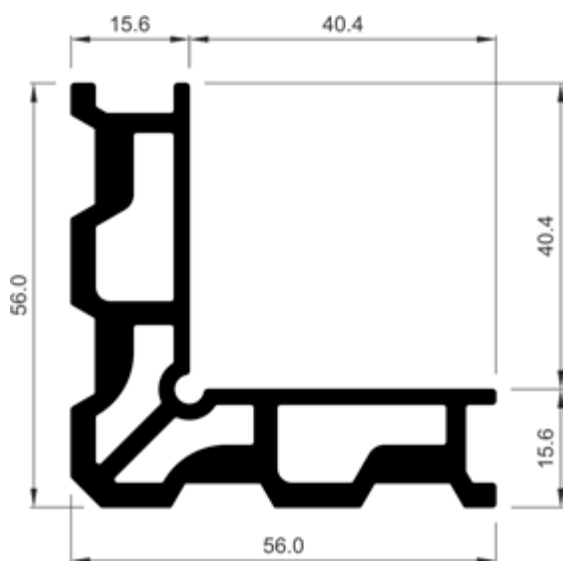

COR-3660	
<b>Descripción</b> Description	Perfil para escuadra de ensamblar 15,6 mm Profile for assembly cleat - 15.6 mm
<b>Peso</b> Weight (g/m)	1941,3
<b>Superficie</b> Surface (dm <sup>2</sup> /m)	47,3
<b>I<sub>x</sub></b> (cm <sup>4</sup> )	18,98
<b>I<sub>y</sub></b> (cm <sup>4</sup> )	18,98



ALUMÍNIO IBÉRICA, S.A.



PALA-MIGUEL S REIS, Lda.



ALUMÍNIO DE VISEU Lda.



ANGULAR - Alumínios, Lda.



COR 70 C16 ST  
Perfis à escala

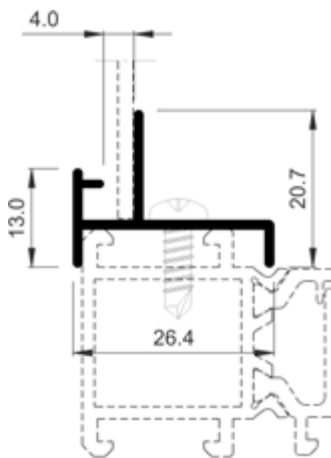

COR-5057	
Descripción Description	Complemento tapa registro (para chapa) Register cover complement (for plate)
Peso Weight (g/m)	191,7
Superficie Surface (dm²/m)	12,06
Ix (cm⁴)	0,14
Iy (cm⁴)	0,5
Juntas Gaskets	262810
Tornillería Screws	853913

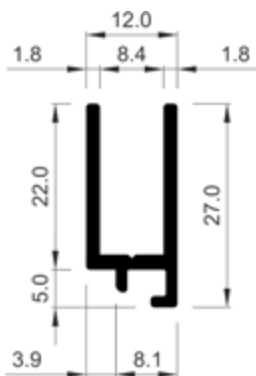

COR-7997	
Descripción Description	Acople para junta de dilatación Expansion gasket attachment
Peso Weight (g/m)	297
Superficie Surface (dm²/m)	12,56
Ix (cm⁴)	0,63
Iy (cm⁴)	0,24
Juntas Gaskets	347901
Tornillería Screws	813919

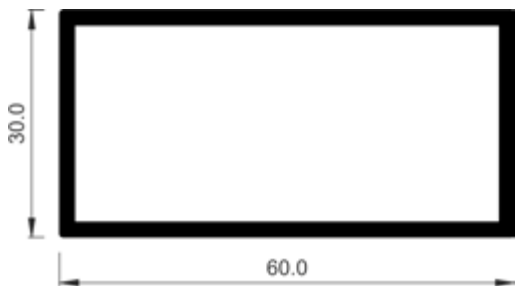

806030	
Descripción Description	Tubo de 60x30x2 mm 60x30x2 mm tube
Peso Weight (g/m)	928,8
Superficie Surface (dm²/m)	34,4
Ix (cm⁴)	15,93
Iy (cm⁴)	5,29

COR 70 C16 ST  
Perfis à escala

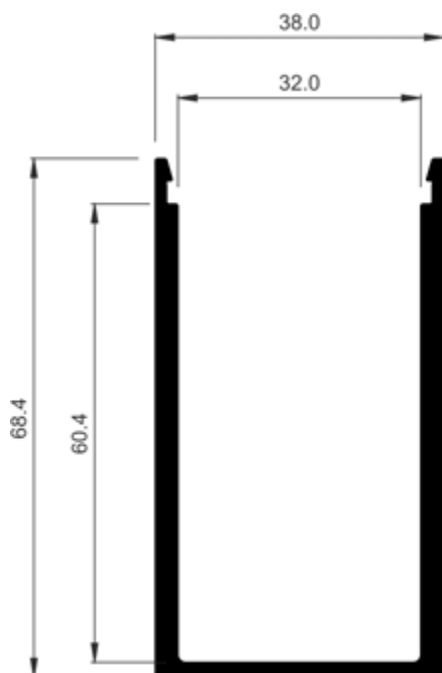

COR-1700	
<b>Descripción</b> Description	U de refuerzo Reinforcement U
<b>Peso</b> Weight (g/m)	1239,3
<b>Superficie</b> Surface (dm <sup>2</sup> /m)	34,5
<b>Ix (cm<sup>4</sup>)</b>	20,05
<b>Iy (cm<sup>4</sup>)</b>	12,71

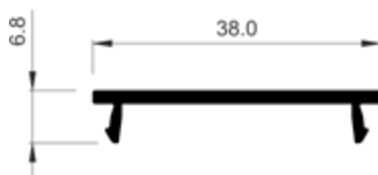

COR-1701	
<b>Descripción</b> Description	Tapa clipaje U refuerzo Reinforcement U-clip end plate
<b>Peso</b> Weight (g/m)	202,5
<b>Superficie</b> Surface (dm <sup>2</sup> /m)	10
<b>Ix (cm<sup>4</sup>)</b>	0,02
<b>Iy (cm<sup>4</sup>)</b>	1,09

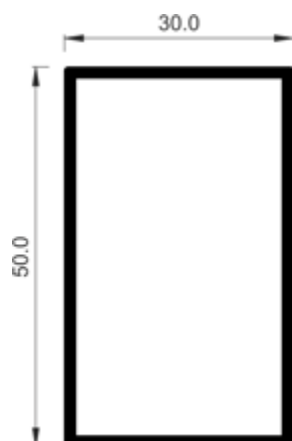

COR-6852	
<b>Descripción</b> Description	Tubo de 50x30 INOX 50x30 mm stainless tube
<b>Peso</b> Weight (g/m)	-
<b>Superficie</b> Surface (dm <sup>2</sup> /m)	-
<b>Ix (cm<sup>4</sup>)</b>	7,87
<b>Iy (cm<sup>4</sup>)</b>	3,54

COR 70 C16 ST  
Perfis à escala

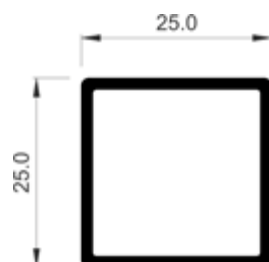

COR-7252	
Descripción Description	Tubo 25x25 INOX Tube of 25x25 stainless steel
Peso Weight (g/m)	-
Superficie Surface (dm <sup>2</sup> /m)	18,8
Ix (cm <sup>4</sup> )	1,29
Iy (cm <sup>4</sup> )	1,29

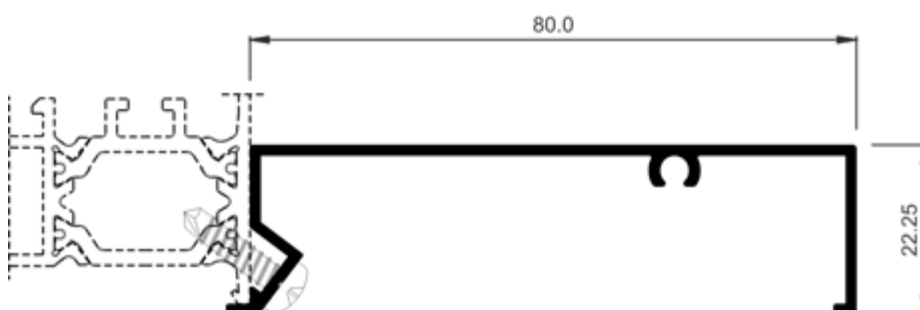

COR-2724	
Descripción Description	Cubre premarco 80 mm Pre-frame cover 80 mm
Peso Weight (g/m)	537,3
Superficie Surface (dm <sup>2</sup> /m)	28,05
Ix (cm <sup>4</sup> )	0,99
Iy (cm <sup>4</sup> )	17,3
Observaciones Observations	Tornillo Ø3.9 mm DIN7504N-A2 Ø3.9 mm DIN7504N-A2 screw

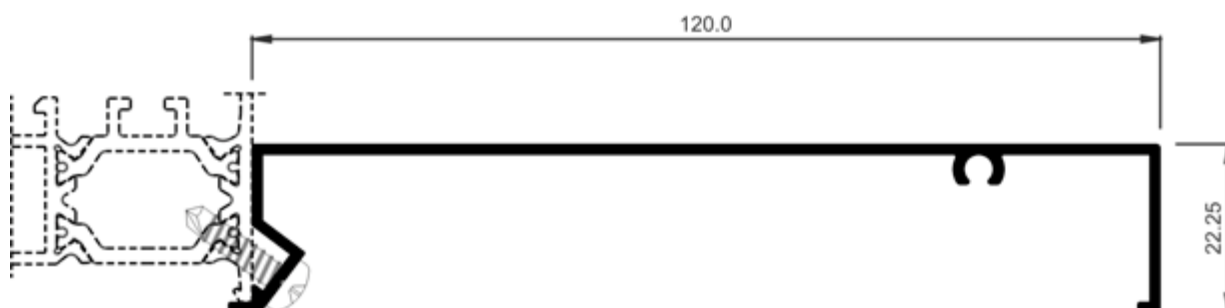

COR-2726	
Descripción Description	Cubre premarco 120 mm Pre-frame cover 120 mm
Peso Weight (g/m)	688,5
Superficie Surface (dm <sup>2</sup> /m)	36,05
Ix (cm <sup>4</sup> )	1,09
Iy (cm <sup>4</sup> )	47,2
Observaciones Observations	Tornillo Ø3.9 mm DIN7504N-A2 Ø3.9 mm DIN7504N-A2 screw



ALUMINIOS IBÉRICA, S.A.



PALA-MIGUEL S REIS, Lda.



ALUMINIOS DE VISEULDA.



ANGULAR - Aluminios, Lda.

COR 70 C16 ST  
Perfis à escala

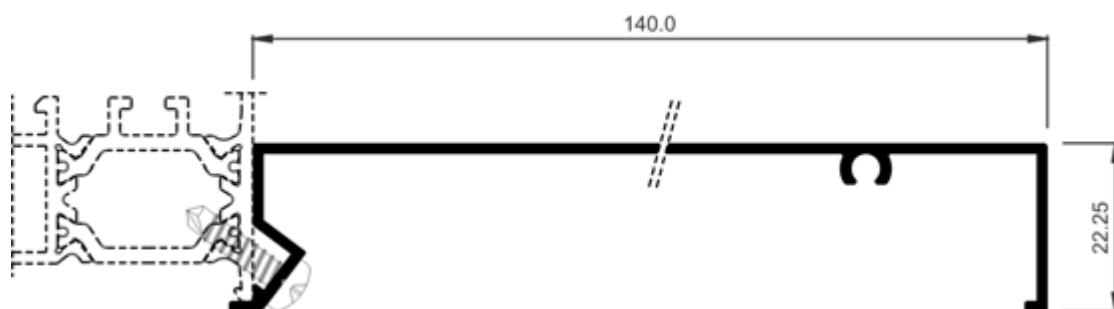

COR-2727	
<b>Descripción</b> Description	Cubre premarco 140 mm Pre-frame cover 140 mm
<b>Peso</b> Weight (g/m)	764,1
<b>Superficie</b> Surface (dm <sup>2</sup> /m)	40,05
<b>Ix</b> (cm <sup>4</sup> )	1,13
<b>Iy</b> (cm <sup>4</sup> )	69,51
<b>Observaciones</b> Observations	Tornillo Ø3.9 mm DIN7504N-A2 Ø3.9 mm DIN7504N-A2 screw

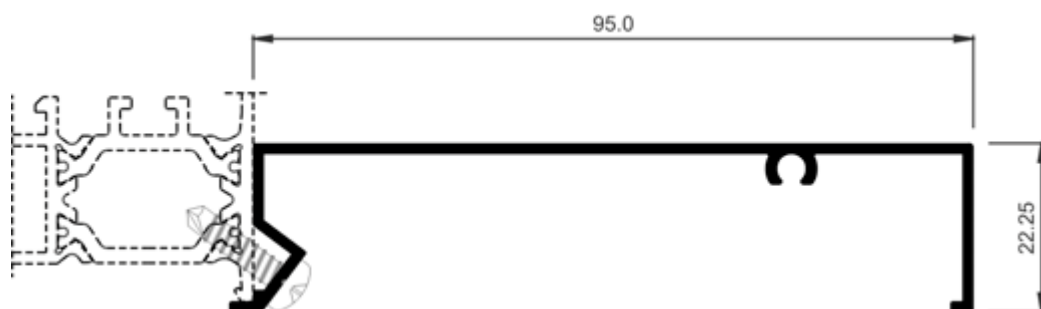

COR-2790	
<b>Descripción</b> Description	Cubre premarco 95 mm Pre-frame cover 95 mm
<b>Peso</b> Weight (g/m)	591,3
<b>Superficie</b> Surface (dm <sup>2</sup> /m)	30,96
<b>Ix</b> (cm <sup>4</sup> )	1,02
<b>Iy</b> (cm <sup>4</sup> )	26,25
<b>Observaciones</b> Observations	Tornillo Ø3.9 mm DIN7504N-A2 Ø3.9 mm DIN7504N-A2 screw

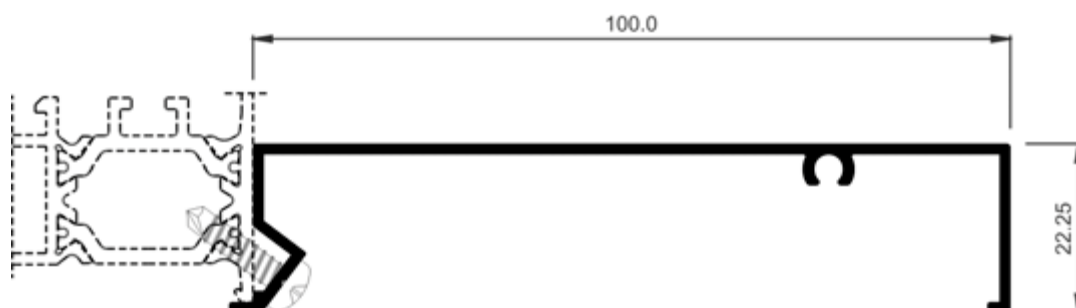

COR-2791	
<b>Descripción</b> Description	Cubre premarco 100 mm Pre-frame cover 100 mm
<b>Peso</b> Weight (g/m)	610,2
<b>Superficie</b> Surface (dm <sup>2</sup> /m)	31,96
<b>Ix</b> (cm <sup>4</sup> )	1,03
<b>Iy</b> (cm <sup>4</sup> )	29,81
<b>Observaciones</b> Observations	Tornillo Ø3.9 mm DIN7504N-A2 Ø3.9 mm DIN7504N-A2 screw

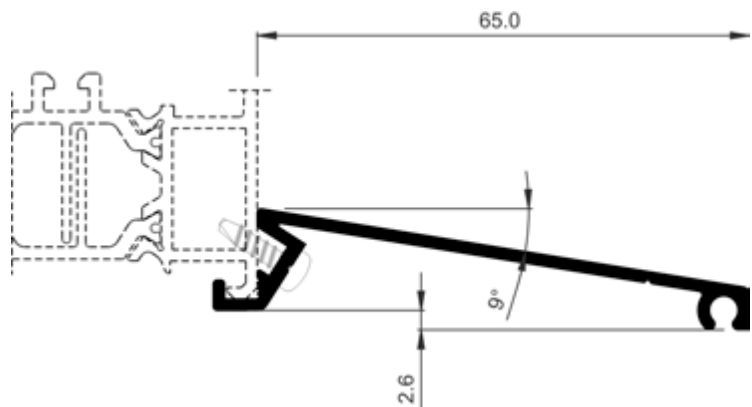

COR-2870	
Descripción Description	Alargadera de 65 mm 65 mm cill
Peso Weight (g/m)	415,8
Superficie Surface (dm²/m)	19,92
Ix (cm⁴)	0,23
Iy (cm⁴)	8,45
Observaciones Observations	Tornillo Ø3.9 mm DIN7504N-A2 Ø3.9 mm DIN7504N-A2 screw

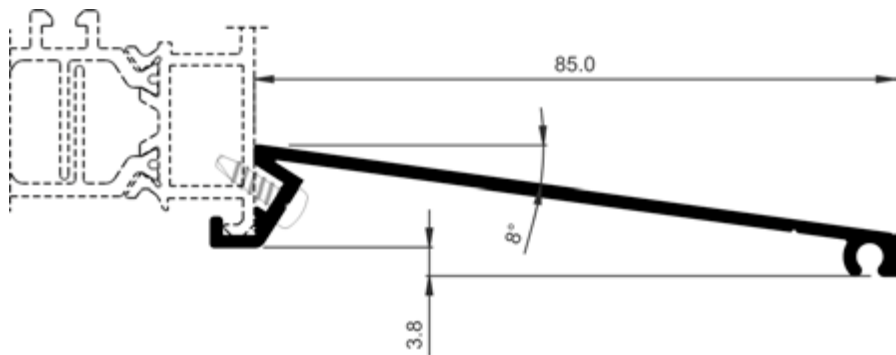

COR-2872	
Descripción Description	Alargadera de 85 mm 85 mm cill
Peso Weight (g/m)	496,8
Superficie Surface (dm²/m)	23,92
Ix (cm⁴)	0,3
Iy (cm⁴)	16,49
Observaciones Observations	Tornillo Ø3.9 mm DIN7504N-A2 Ø3.9 mm DIN7504N-A2 screw

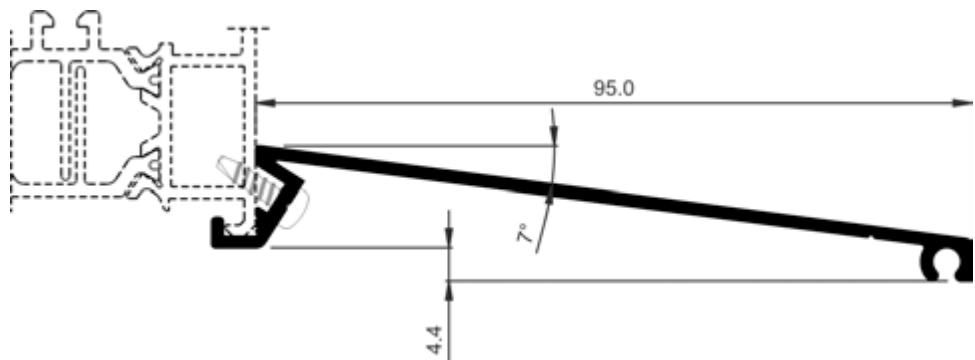

COR-2873	
Descripción Description	Alargadera de 95 mm 95 mm cill
Peso Weight (g/m)	537,3
Superficie Surface (dm²/m)	25,92
Ix (cm⁴)	0,35
Iy (cm⁴)	21,83
Observaciones Observations	Tornillo Ø3.9 mm DIN7504N-A2 Ø3.9 mm DIN7504N-A2 screw

COR 70 C16 ST  
Perfis à escala

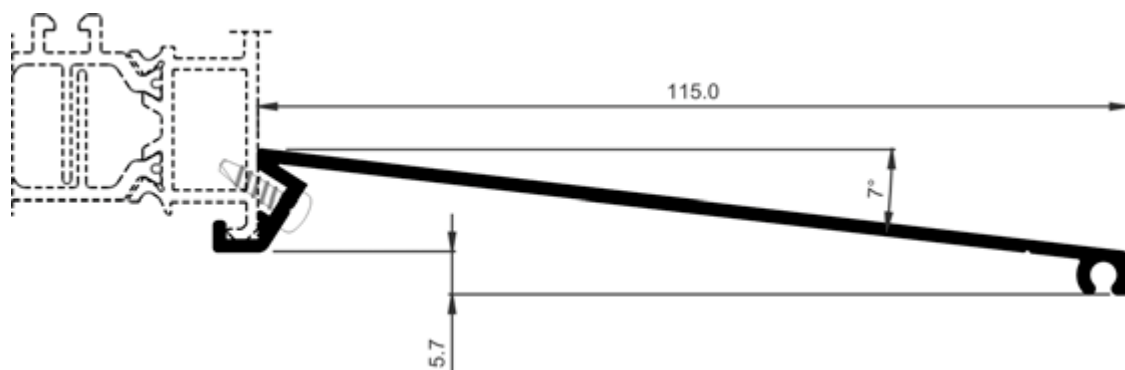

COR-2875	
Descripción Description	Alargadera de 115 mm 115 mm cill
Peso Weight (g/m)	618,3
Superficie Surface (dm <sup>2</sup> /m)	29,93
Ix (cm <sup>4</sup> )	0,45
Iy (cm <sup>4</sup> )	35,54
Observaciones Observations	Tornillo Ø3.9 mm DIN7504N-A2 Ø3.9 mm DIN7504N-A2 screw

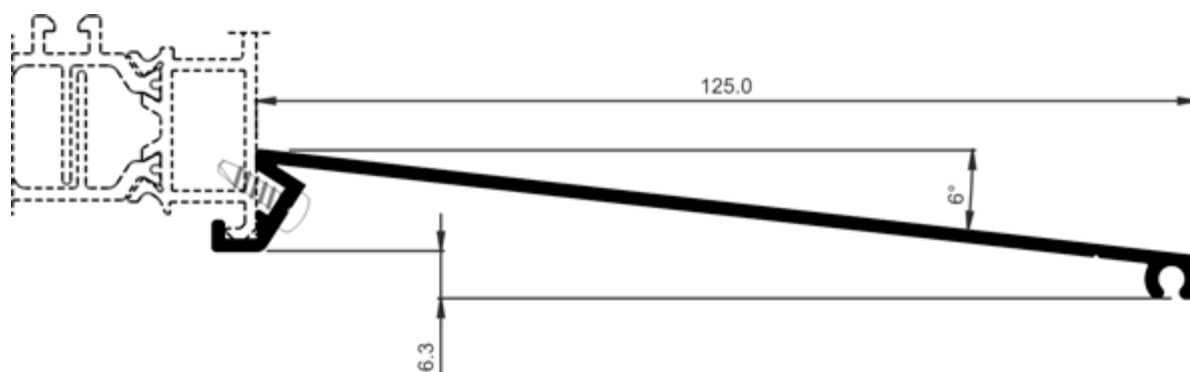

COR-2876	
Descripción Description	Alargadera de 125 mm 125 mm cill
Peso Weight (g/m)	656,1
Superficie Surface (dm <sup>2</sup> /m)	31,93
Ix (cm <sup>4</sup> )	0,51
Iy (cm <sup>4</sup> )	44,06
Observaciones Observations	Tornillo Ø3.9 mm DIN7504N-A2 Ø3.9 mm DIN7504N-A2 screw

COR 70 C16 ST  
Perfis à escala

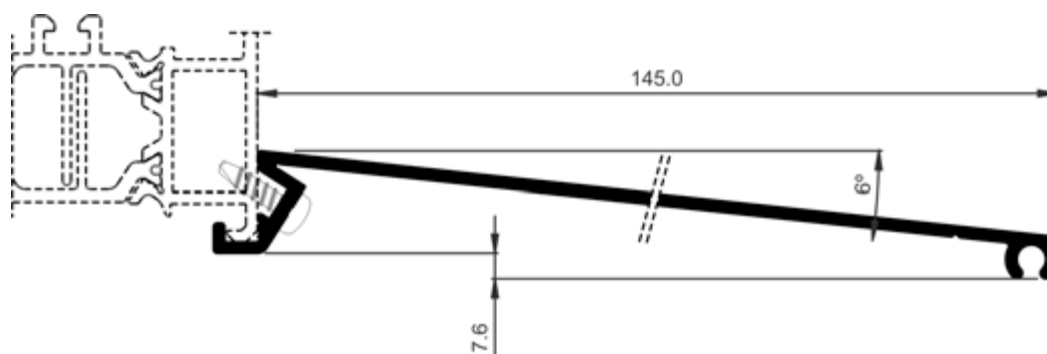

COR-2878	
Descripción Description	Alargadera de 145 mm 145 mm cill
Peso Weight (g/m)	737,1
Superficie Surface (dm²/m)	35,94
Ix (cm⁴)	0,64
Iy (cm⁴)	64,8
Observaciones Observations	Tornillo Ø3.9 mm DIN7504N-A2 Ø3.9 mm DIN7504N-A2 screw

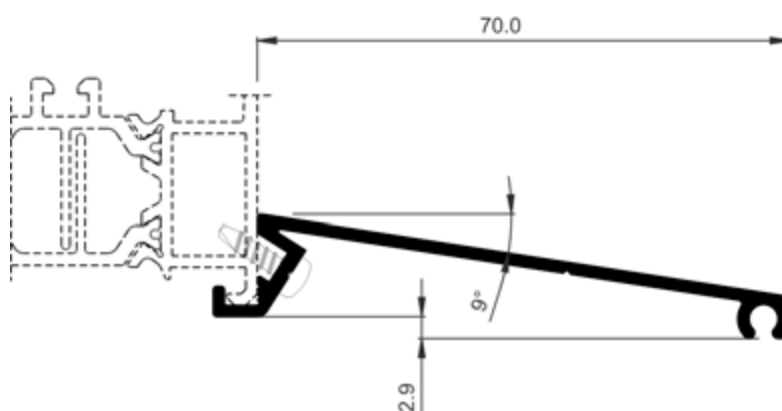

COR-2888	
Descripción Description	Alargadera de 70 mm 70 mm cill
Peso Weight (g/m)	437,4
Superficie Surface (dm²/m)	20,92
Ix (cm⁴)	0,25
Iy (cm⁴)	10,17
Observaciones Observations	Tornillo Ø3.9 mm DIN7504N-A2 Ø3.9 mm DIN7504N-A2 screw

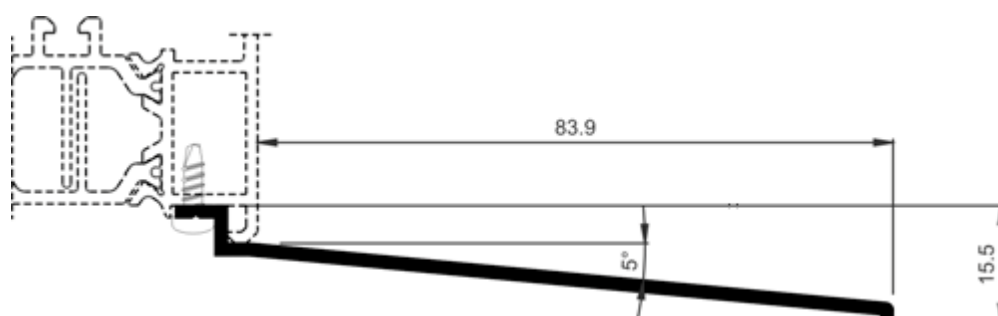

COR-7055	
Descripción Description	Alargadera de 85 mm 85 mm cill
Peso Weight (g/m)	434,7
Superficie Surface (dm²/m)	20,54
Ix (cm⁴)	0,19
Iy (cm⁴)	12,95
Tornillería Screws	812913



ALUMÍNIO IBÉRICA, S.A.



PALA-MIGUEL S REIS, Lda.



ALUMÍNIO DE VISEUGA, Lda.



ANGULAR - Aluminios, Lda.



COR 70 C16 ST  
Perfis à escala

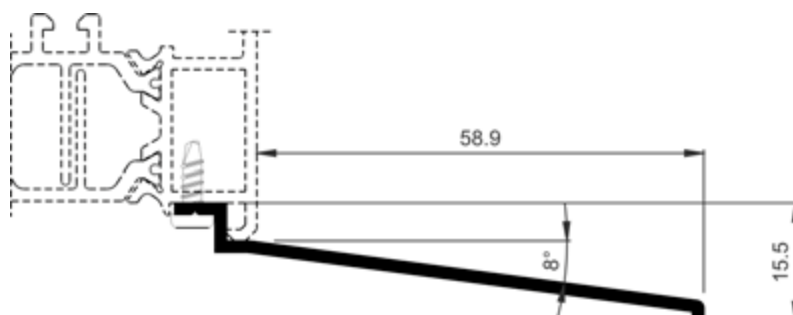

COR-7056	
<b>Descripción</b> Description	Alargadera de 60 mm 60 mm cill
<b>Peso</b> Weight (g/m)	307,8
<b>Superficie</b> Surface (dm <sup>2</sup> /m)	15,57
<b>I<sub>x</sub></b> (cm <sup>4</sup> )	0,15
<b>I<sub>y</sub></b> (cm <sup>4</sup> )	5
<b>Tornillería</b> Screws	812913

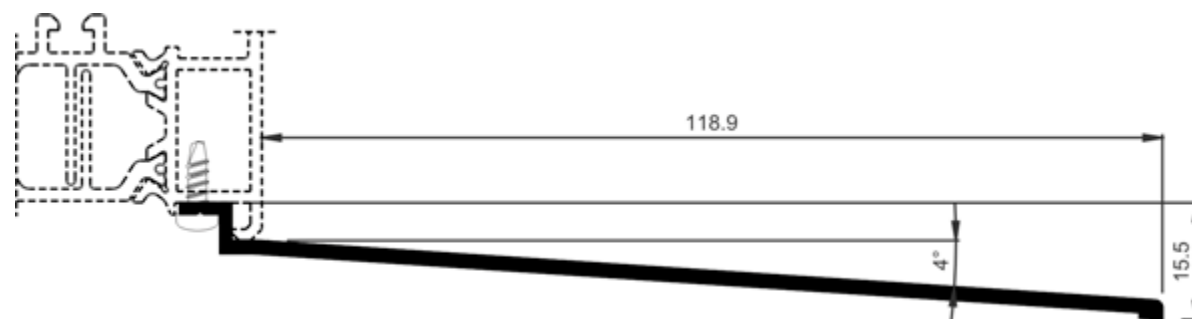

COR-7057	
<b>Descripción</b> Description	Alargadera de 120 mm 120 mm cill
<b>Peso</b> Weight (g/m)	618,3
<b>Superficie</b> Surface (dm <sup>2</sup> /m)	27,5
<b>I<sub>x</sub></b> (cm <sup>4</sup> )	0,23
<b>I<sub>y</sub></b> (cm <sup>4</sup> )	33,9
<b>Tornillería</b> Screws	812913

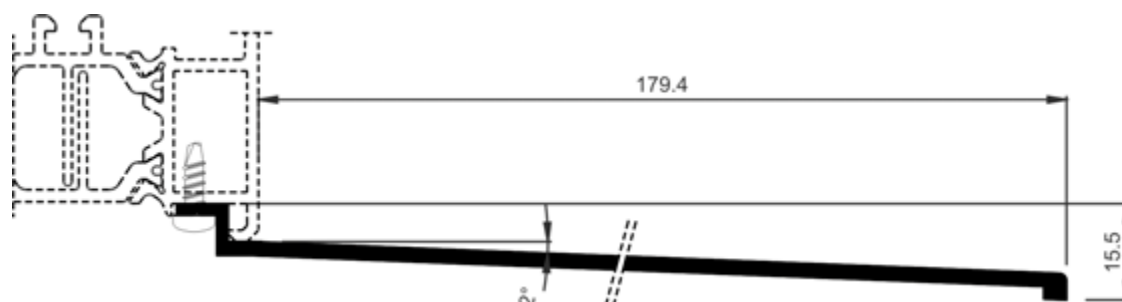

COR-7072	
<b>Descripción</b> Description	Alargadera de 180 mm 180 mm cill
<b>Peso</b> Weight (g/m)	950,4
<b>Superficie</b> Surface (dm <sup>2</sup> /m)	39,66
<b>I<sub>x</sub></b> (cm <sup>4</sup> )	0,26
<b>I<sub>y</sub></b> (cm <sup>4</sup> )	110,95
<b>Tornillería</b> Screws	812913



ALUMINIOS IBÉRICA, S.A.



PALA-MIGUEL S REIS, Lda.



ALUMINIOS DE VISEULDA



ANGULAR - Aluminios, Lda.

COR 70 C16 ST  
Perfis à escala

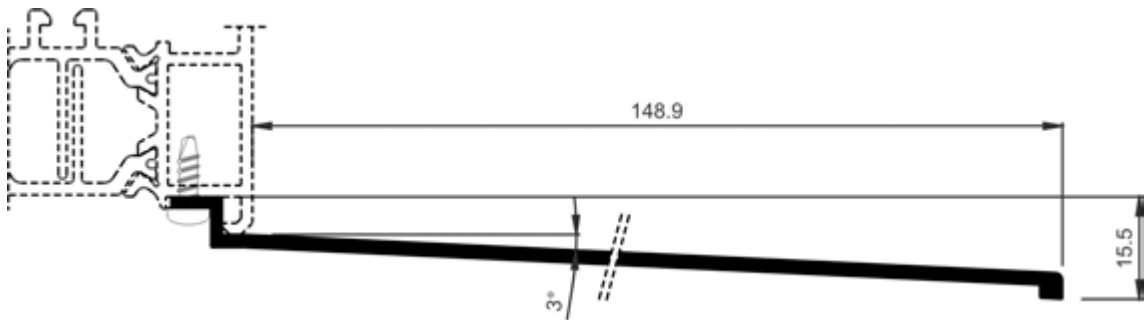

COR-7073	
Descripción Description	Alargadera de 150 mm 150 mm cill
Peso Weight (g/m)	764,1
Superficie Surface (dm²/m)	33,66
Ix (cm⁴)	0,22
Iy (cm⁴)	64,13
Tornillería Screws	812913

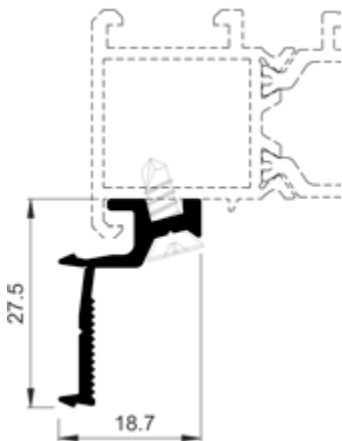

COR-2705	
Descripción Description	Grapa para solapes Clip for overlap
Peso Weight (g/m)	232,2
Superficie Surface (dm²/m)	112,1
Ix (cm⁴)	0,58
Iy (cm⁴)	0,23
Tornillería Screws	853913

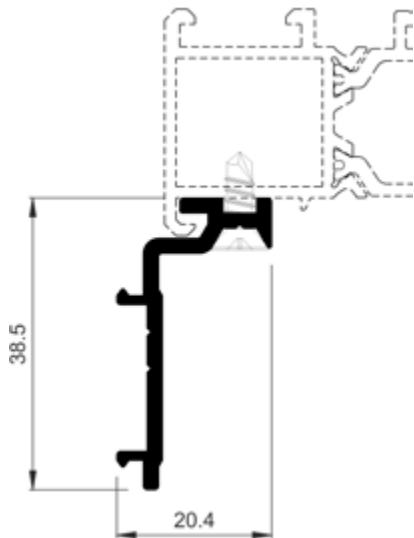

COR-2744	
Descripción Description	Grapa para solapes Clip for overlap
Peso Weight (g/m)	348,3
Superficie Surface (dm²/m)	13,98
Ix (cm⁴)	1,84
Iy (cm⁴)	0,36
Tornillería Screws	853913



COR 70 C16 ST  
Perfis à escala

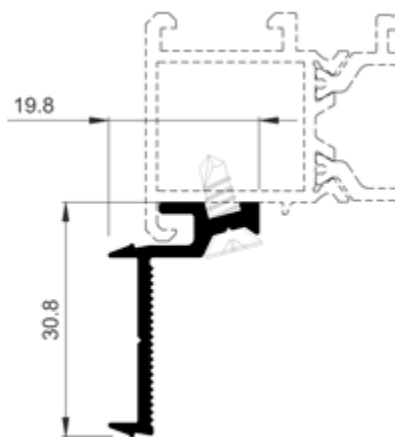

COR-2842	
Descripción Description	Grapa para solapes Clip for overlap
Peso Weight (g/m)	261,9
Superficie Surface (dm²/m)	12,73
Ix (cm⁴)	0,9
Iy (cm⁴)	0,24
Tornillería Screws	853913

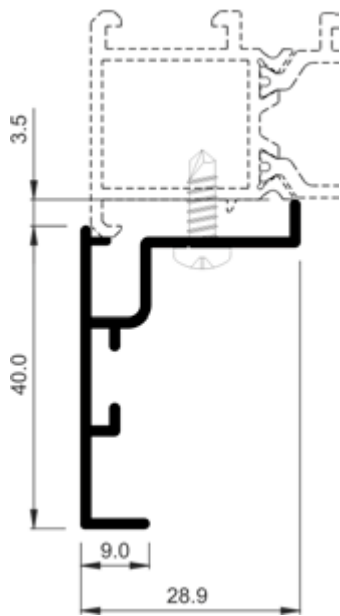

770224	
Descripción Description	Solape de registro recto Straight register overlap
Peso Weight (g/m)	353,7
Superficie Surface (dm²/m)	20,3
Ix (cm⁴)	2,24
Iy (cm⁴)	0,98
Escuadra alineamiento Alignment cleat	245054
Observaciones Observations	Tornillo Ø3.9 mm DIN7504N-A2 Screw Ø3.9 mm DIN7504N-A2

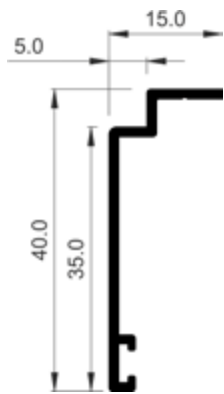

770229	
Descripción Description	Solape de 35 mm 35 mm overlap
Peso Weight (g/m)	205
Superficie Surface (dm²/m)	12
Ix (cm⁴)	1,38
Iy (cm⁴)	0,11
Escuadra alineamiento Alignment cleat	282730

COR 70 C16 ST  
Perfis à escala

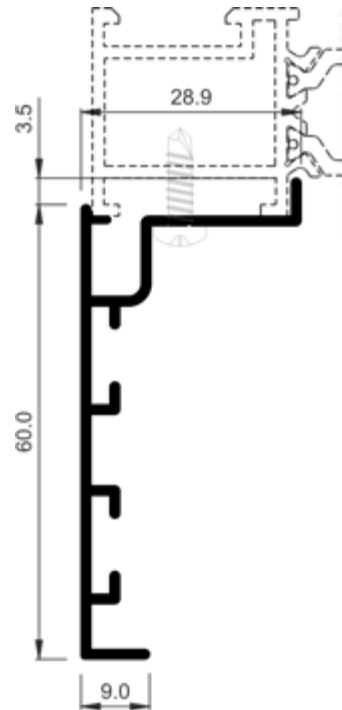

770563	
Descripción Description	Solape 60 mm 60 mm overlap
Peso Weight (g/m)	469,8
Superficie Surface (dm²/m)	26,85
Ix (cm⁴)	6,94
Iy (cm⁴)	1,09
Escuadra alineamiento Alignment cleat	245054
Observaciones Observations	Tornillo Ø3.9 mm DIN7504N-A2 Screw Ø3.9 mm DIN7504N-A2

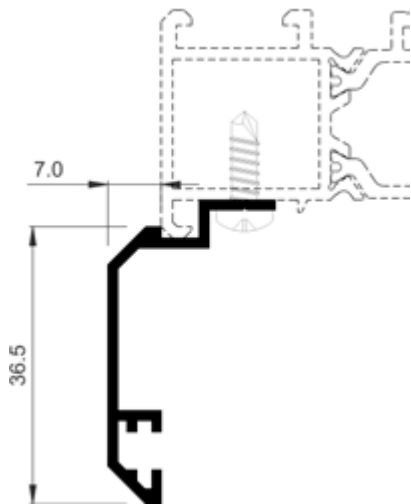

COR-2026	
Descripción Description	Solape 35 mm 35 mm overlap
Peso Weight (g/m)	272,7
Superficie Surface (dm²/m)	15,24
Ix (cm⁴)	1,8
Iy (cm⁴)	0,33
Escuadra alineamiento Alignment cleat	212008
Observaciones Observations	Tornillo Ø3.9 mm DIN7504N-A2. Screw Ø3.9 mm DIN7504N-A2

COR 70 C16 ST  
Perfis à escala

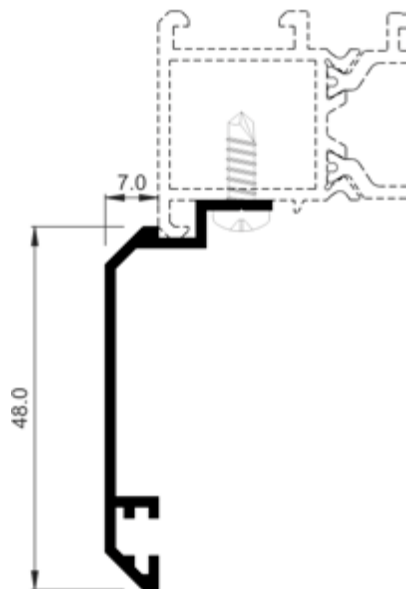

COR-2036	
Descripción Description	Solape 48 mm 48 mm overlap
Peso Weight (g/m)	272,7
Superficie Surface (dm²/m)	17,63
Ix (cm⁴)	3,19
Iy (cm⁴)	0,31
Escuadra alineamiento Alignment cleat	212008
Observaciones Observations	Tornillo Ø3.9 mm DIN7504N-A2. Screw Ø3.9 mm DIN7504N-A2

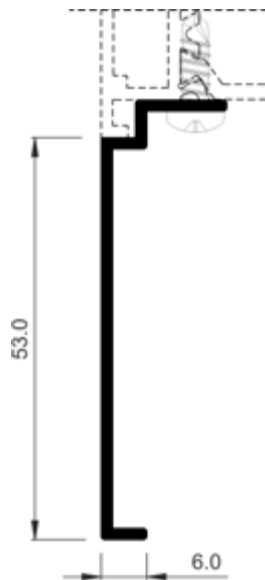

COR-2077	
Descripción Description	Solape recto de 53 mm 53 mm straight overlap
Peso Weight (g/m)	315,9
Superficie Surface (dm²/m)	15,75
Ix (cm⁴)	4,43
Iy (cm⁴)	0,17
Observaciones Observations	Tornillo Ø3.9 mm DIN7504N-A2 Screw Ø3.9 mm DIN7504N-A2

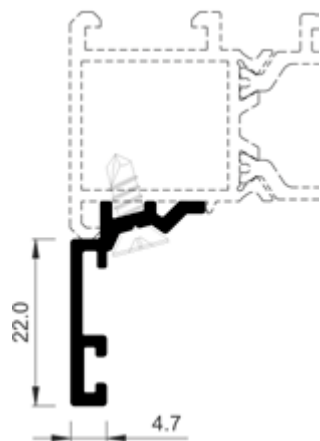

COR-2725	
Descripción Description	Solape recto 22 mm 22 mm straight overlap
Peso Weight (g/m)	245,7
Superficie Surface (dm²/m)	11,2
Ix (cm⁴)	0,71
Iy (cm⁴)	0,2
Escuadra alineamiento Alignment cleat	212007
Observaciones Observations	Tornillo Ø3.9 mm DIN7504P-A2 Screw Ø3.9 mm DIN7504N-A2

COR 70 C16 ST  
Perfis à escala

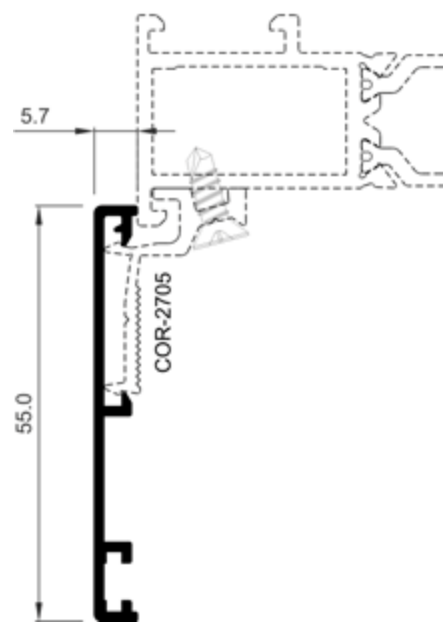

COR-2728	
Descripción Description	Solape recto de 55 mm Straight overlap 55 mm
Peso Weight (g/m)	270
Superficie Surface (dm²/m)	16,03
Ix (cm⁴)	3,19
Iy (cm⁴)	0,02
Escuadra alineamiento Alignment cleat	212008 912100
Observaciones Observations	Grapa 2705 Clip 2705

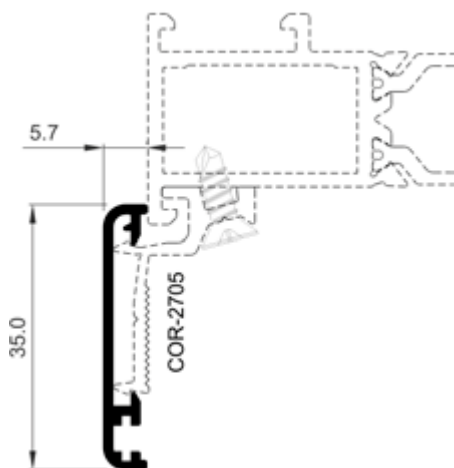

COR-2731	
Descripción Description	Solape de 35 mm Straight overlap 35 mm
Peso Weight (g/m)	183,6
Superficie Surface (dm²/m)	11
Ix (cm⁴)	0,92
Iy (cm⁴)	0,02
Escuadra alineamiento Alignment cleat	212007 912100
Observaciones Observations	Grapa 2705 Clip 2705

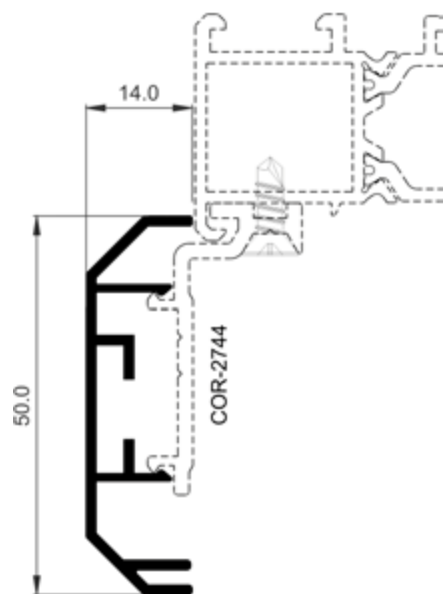

COR-2733	
Descripción Description	Solape chaflán de 50 mm Bevelled overlap 50 mm
Peso Weight (g/m)	367,2
Superficie Surface (dm²/m)	21,82
Ix (cm⁴)	3,42
Iy (cm⁴)	0,21
Escuadra alineamiento Alignment cleat	207004 277004
Observaciones Observations	Grapa 2744 Clip 2744

COR 70 C16 ST  
Perfis à escala

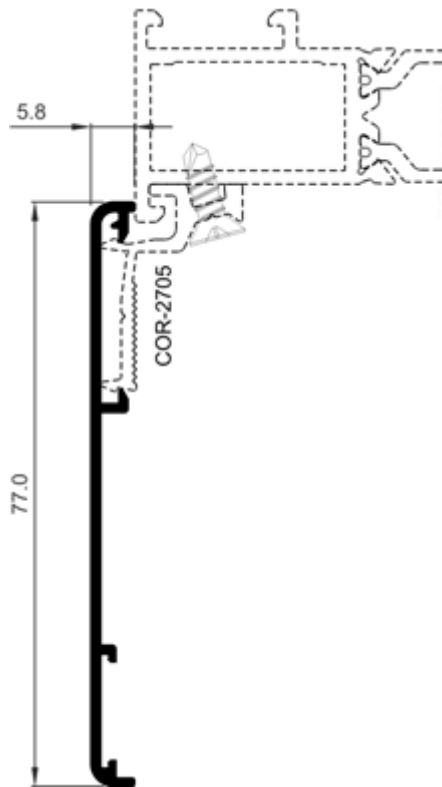

COR-2734	
Descripción Description	Solape de 77 mm 77 mm overlap
Peso Weight (g/m)	337,5
Superficie Surface (dm²/m)	19,66
Ix (cm⁴)	7,31
Iy (cm⁴)	0,02
Escuadra alineamiento Alignment cleat	912100
	920135
Observaciones Observations	Grapa 2705 Clip 2705

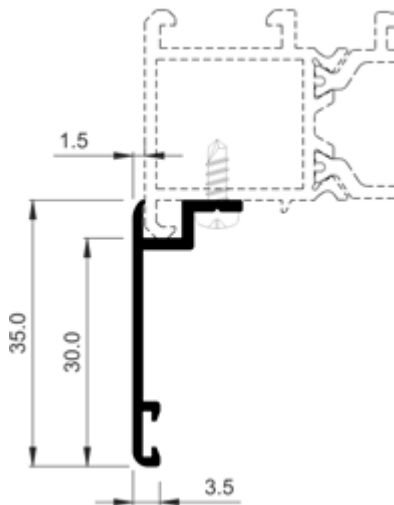

COR-2735	
Descripción Description	Solape para tornillo Screw overlap
Peso Weight (g/m)	205,2
Superficie Surface (dm²/m)	12,02
Ix (cm⁴)	0,99
Iy (cm⁴)	0,11
Tornillería Screws	852913
Escuadra alineamiento Alignment cleat	212007

COR 70 C16 ST  
Perfis à escala

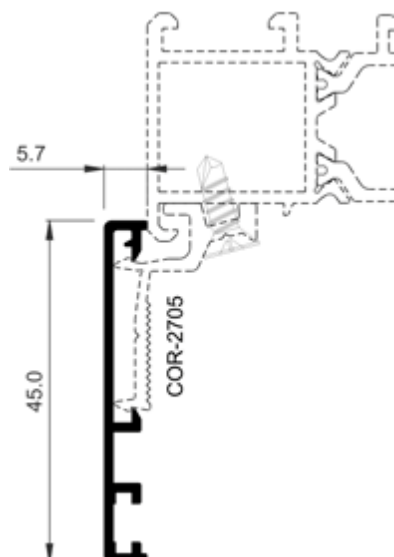

COR-2745	
<b>Descripción</b> Description	Solape recto 45 mm Straight overlap 45 mm
<b>Peso</b> Weight (g/m)	237,6
<b>Superficie</b> Surface (dm <sup>2</sup> /m)	14,03
<b>Ix (cm<sup>4</sup>)</b>	1,88
<b>Iy (cm<sup>4</sup>)</b>	0,02
<b>Escuadra alineamiento</b> Alignment cleat	212008
	912100
<b>Observaciones</b> Observations	Grapa 2705 Clip 2705

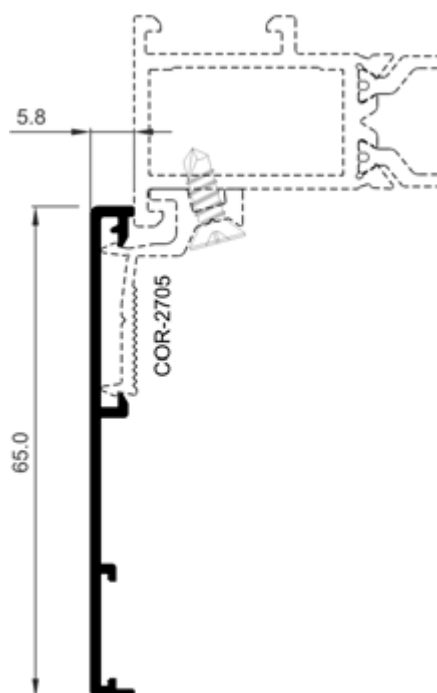

COR-2773	
<b>Descripción</b> Description	Solape recto de 65 mm Straight overlap 65 mm
<b>Peso</b> Weight (g/m)	299,7
<b>Superficie</b> Surface (dm <sup>2</sup> /m)	17,49
<b>Ix (cm<sup>4</sup>)</b>	4,7
<b>Iy (cm<sup>4</sup>)</b>	0,02
<b>Escuadra alineamiento</b> Alignment cleat	912100
	920135
<b>Observaciones</b> Observations	Grapa 2705 Clip 2705



COR 70 C16 ST  
Perfis à escala

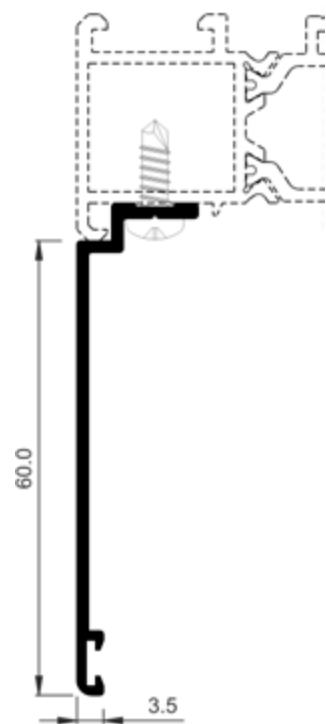

COR-2781	
Descripción Description	Solape recto 60 mm 60 mm straight overlap
Peso Weight (g/m)	337,5
Superficie Surface (dm²/m)	17,32
Ix (cm⁴)	5,59
Iy (cm⁴)	0,18
Escuadra alineamiento Alignment cleat	212007
Observaciones Observations	Tornillo Ø3.9 mm DIN7504N-A2. Screw Ø3.9 mm DIN7504N-A2



COR-2788	
Descripción Description	Solape recto 88 mm 88 mm straight overlap
Peso Weight (g/m)	450,9
Superficie Surface (dm²/m)	22,92
Ix (cm⁴)	14,88
Iy (cm⁴)	0,19
Escuadra alineamiento Alignment cleat	212007
Observaciones Observations	Tornillo Ø3.9 mm DIN7504N-A2. Screw Ø3.9 mm DIN7504N-A2



COR 70 C16 ST  
Perfis à escala

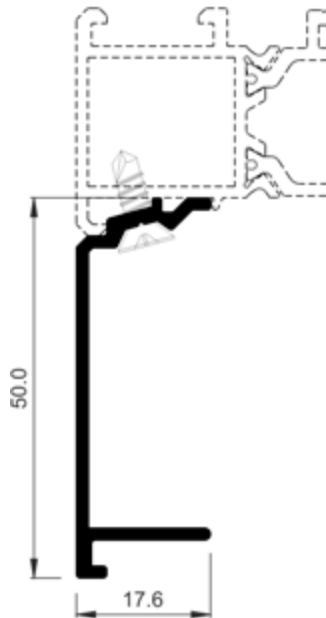

COR-2820	
Descripción Description	Tapa guía Guide end plate
Peso Weight (g/m)	369,9
Superficie Surface (dm²/m)	16,72
Ix (cm⁴)	4,19
Iy (cm⁴)	0,36
Observaciones Observations	Tornillo Ø3.9 mm DIN7504P-A2. Ø2.9 mm DIN7504N-A2 screw

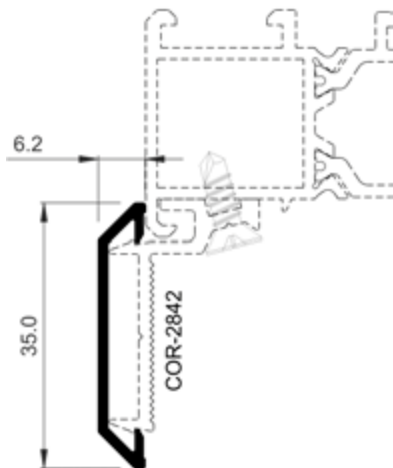

COR-2831	
Descripción Description	Solape de 35 mm 35 mm overlap
Peso Weight (g/m)	159,3
Superficie Surface (dm²/m)	9,31
Ix (cm⁴)	0,76
Iy (cm⁴)	0,02
Escuadra alineamiento Alignment cleat	242831
Observaciones Observations	Grapa 2842 Clip 2842

COR 70 C16 ST  
Perfis à escala

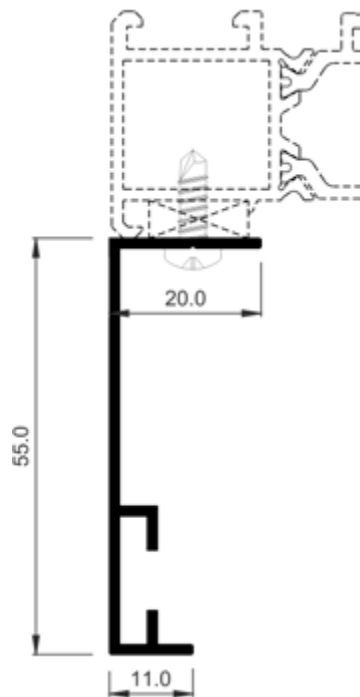

COR-2834	
Descripción Description	Solape de 55 mm atornillar (en L) 55 mm overlap screw (in L)
Peso Weight (g/m)	340,2
Superficie Surface (dm²/m)	19,71
Ix (cm⁴)	4,91
Iy (cm⁴)	0,28
Tornillería Screws	813919
Escuadra alineamiento Alignment cleat	207004
	277004

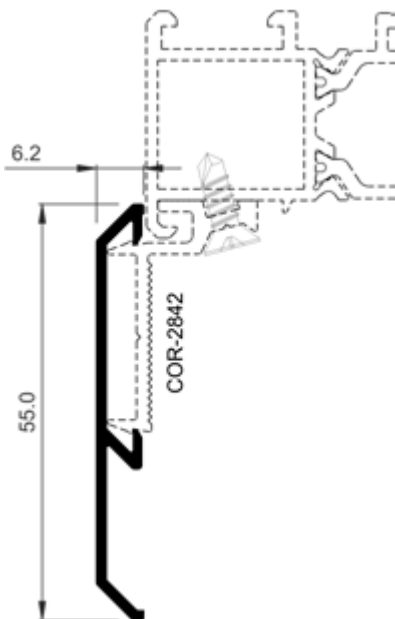

COR-2835	
Descripción Description	Solape de 55 mm 55 mm overlap
Peso Weight (g/m)	253,8
Superficie Surface (dm²/m)	14,4
Ix (cm⁴)	2,44
Iy (cm⁴)	0,03
Escuadra alineamiento Alignment cleat	242831
Observaciones Observations	Grapa 2842 Clip 2842

COR 70 C16 ST  
Perfis à escala

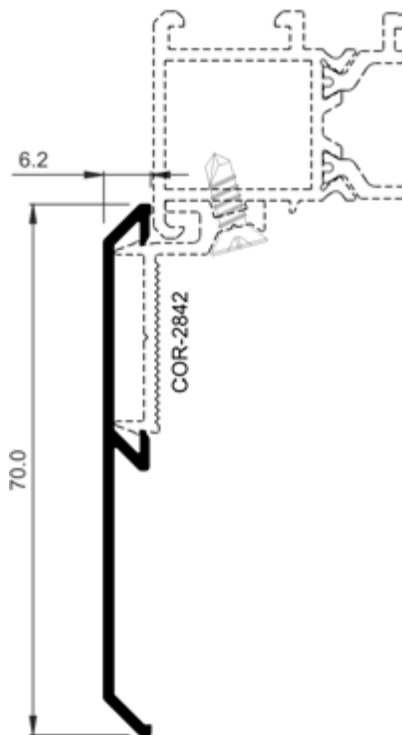

COR-2837	
Descripción Description	Solape de 70 mm 70 mm overlap
Peso Weight (g/m)	305,1
Superficie Surface (dm²/m)	17,4
Ix (cm⁴)	4,74
Iy (cm⁴)	0,03
Escuadra alineamiento Alignment cleat	242831
Observaciones Observations	Grapa 2842 Clip 2842

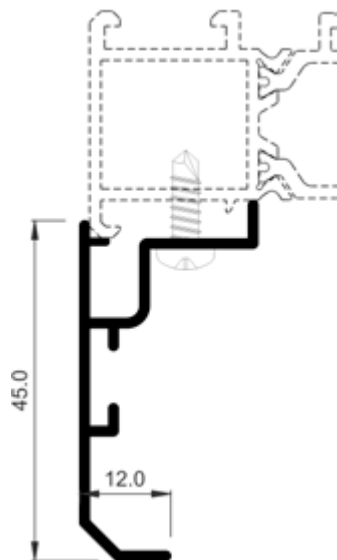

COR-2894	
Descripción Description	Solape de registro de 45 mm 45 mm register overlap
Peso Weight (g/m)	353,7
Superficie Surface (dm²/m)	20,29
Ix (cm⁴)	2,72
Iy (cm⁴)	0,6
Tornillería Screws	813919
Escuadra alineamiento Alignment cleat	245054

COR 70 C16 ST  
Perfis à escala

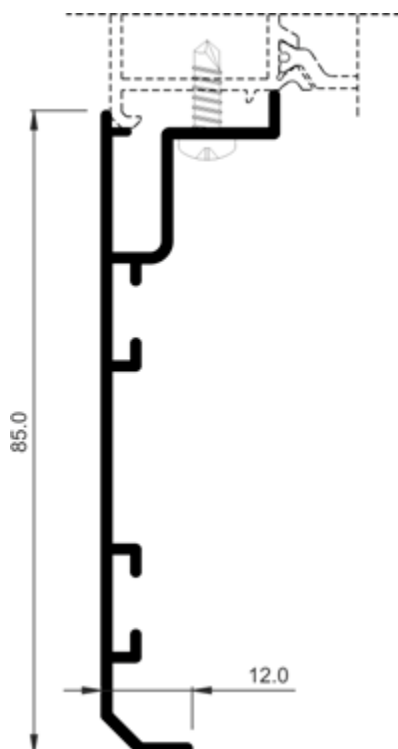

COR-2898	
<b>Descripción</b> Description	Solape de registro de 85 mm 85 mm register overlap
<b>Peso</b> Weight (g/m)	594
<b>Superficie</b> Surface (dm <sup>2</sup> /m)	31,98
<b>I<sub>x</sub></b> (cm <sup>4</sup> )	16,75
<b>I<sub>y</sub></b> (cm <sup>4</sup> )	0,76
<b>Tornillería</b> Screws	813919
<b>Escuadra alineamiento</b> Alignment cleat	245054

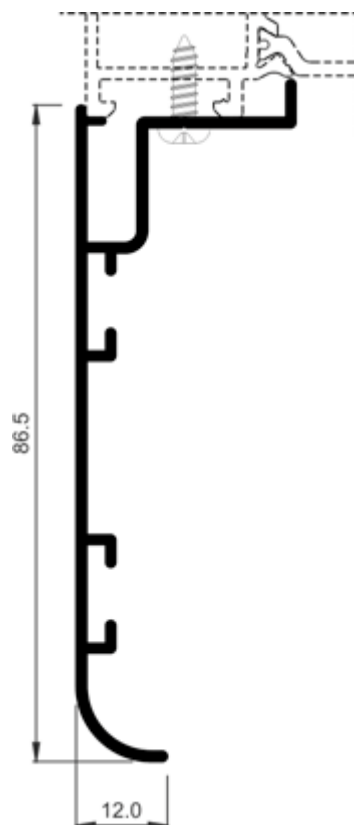

COR-5054	
<b>Descripción</b> Description	Solape de registro curvo de 86.50 mm Curve register overlap of 86,50 mm
<b>Peso</b> Weight (g/m)	621
<b>Superficie</b> Surface (dm <sup>2</sup> /m)	33,11
<b>I<sub>x</sub></b> (cm <sup>4</sup> )	17,92
<b>I<sub>y</sub></b> (cm <sup>4</sup> )	1,23
<b>Tornillería</b> Screws	813919
<b>Escuadra alineamiento</b> Alignment cleat	245054

COR 70 C16 ST  
Perfis à escala

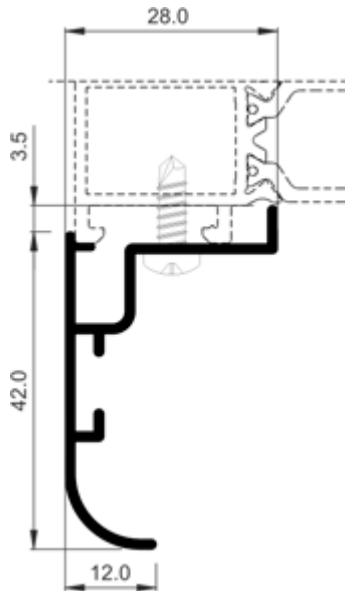

COR-5056	
Descripción Description	Solape de registro Register overlap
Peso Weight (g/m)	353,7
Superficie Surface (dm²/m)	20,31
Ix (cm⁴)	2,36
Iy (cm⁴)	0,89
Tornillería Screws	813919
Escuadra alineamiento Alignment cleat	245054

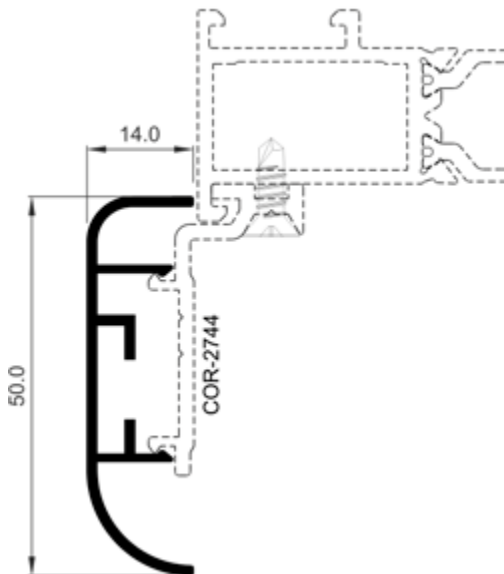

COR-7026	
Descripción Description	Solape de 50 mm 50 mm overlap
Peso Weight (g/m)	340,2
Superficie Surface (dm²/m)	20,45
Ix (cm⁴)	2,99
Iy (cm⁴)	0,18
Escuadra alineamiento Alignment cleat	207004 277004
Observaciones Observations	Grapa 2744 Clip 2744



COR 70 C16 ST  
Perfis à escala

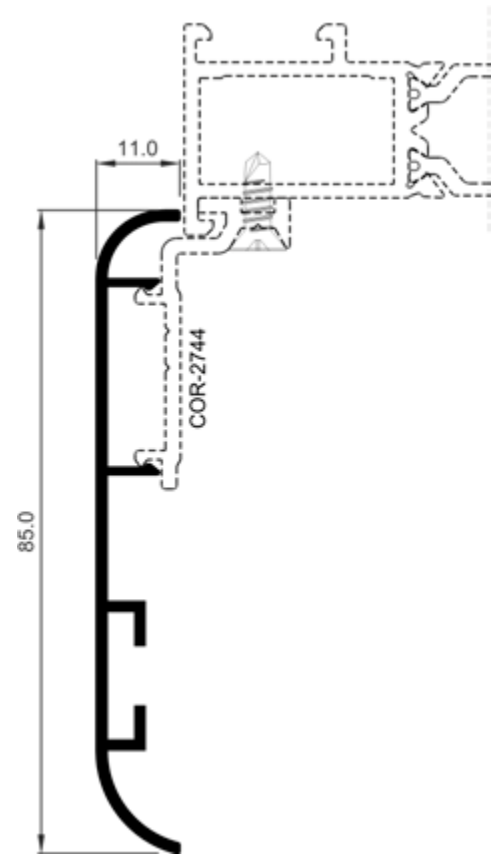

COR-7027	
Descripción Description	Solape de 85 mm 85 mm overlap
Peso Weight (g/m)	464,4
Superficie Surface (dm²/m)	25,82
Ix (cm⁴)	11,36
Iy (cm⁴)	0,12
Escuadra alineamiento Alignment cleat	207004
	277004
Observaciones Observations	Grapa 2744 Clip 2744

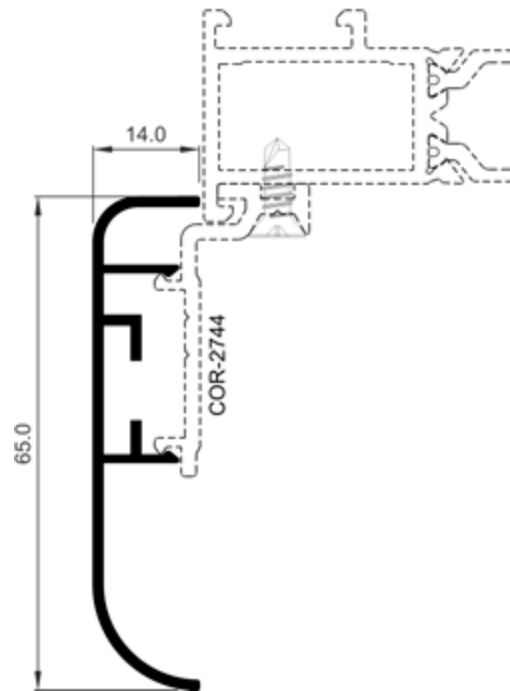

COR-7029	
Descripción Description	Solape de 65 mm 65 mm overlap
Peso Weight (g/m)	394,2
Superficie Surface (dm²/m)	23,45
Ix (cm⁴)	5,75
Iy (cm⁴)	0,2
Escuadra alineamiento Alignment cleat	207004
	277004
Observaciones Observations	Grapa 2744 Clip 2744

COR 70 C16 ST  
Perfis à escala

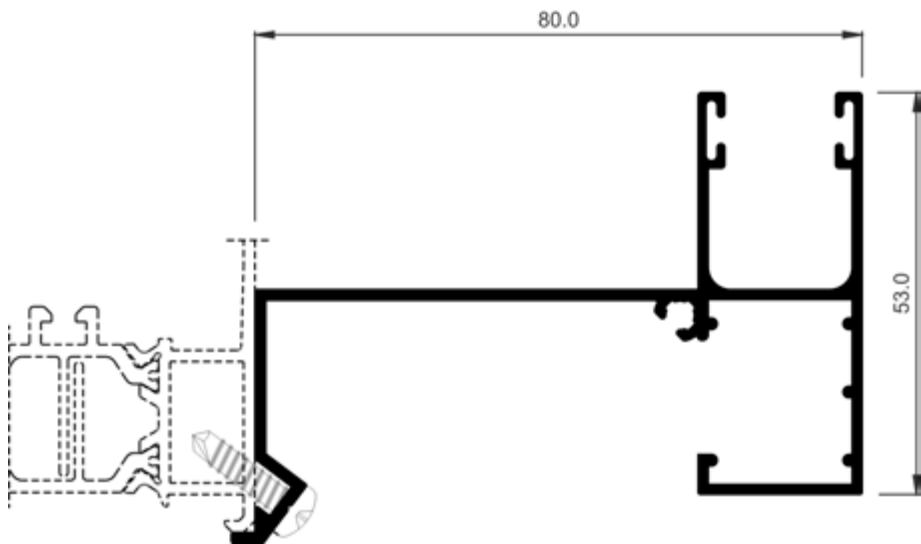

COR-2708	
Descripción Description	Guía de 80 mm 80 mm guide
Peso Weight (g/m)	926,1
Superficie Surface (dm²/m)	50,34
Ix (cm⁴)	7,61
Iy (cm⁴)	29,27
Observaciones Observations	Tornillo Ø3.9 mm DIN7504N-A2. Sólo válida para persianas motorizadas Ø3.9 mm DIN7504N-A2 screw. Only for motorized shutters

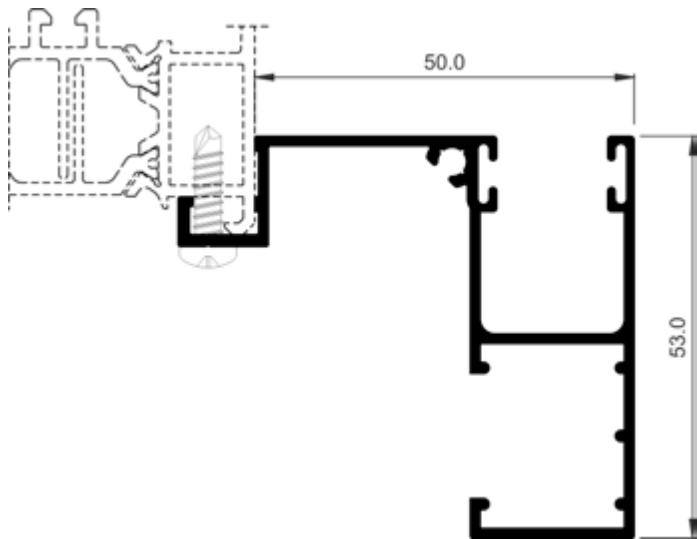

COR-2752	
Descripción Description	Guía de 50 mm Guide of 50 mm
Peso Weight (g/m)	758,7
Superficie Surface (dm²/m)	41,84
Ix (cm⁴)	8,43
Iy (cm⁴)	9,58
Observaciones Observations	Tornillo Ø3.9 mm DIN7504N-A2 Screw Ø3.9 mm DIN7504N-A2



COR 70 C16 ST  
Perfis à escala

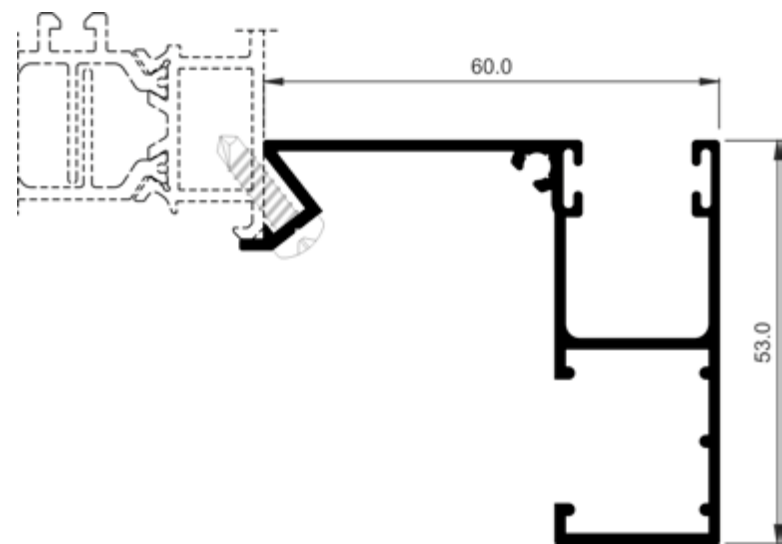

COR-2753	
Descripción Description	Guía de 60 mm Guide of 60 mm
Peso Weight (g/m)	761,4
Superficie Surface (dm²/m)	42,42
Ix (cm⁴)	8,9
Iy (cm⁴)	10,72
Observaciones Observations	Tornillo Ø3.9 mm DIN7504N-A2 Screw Ø3.9 mm DIN7504N-A2

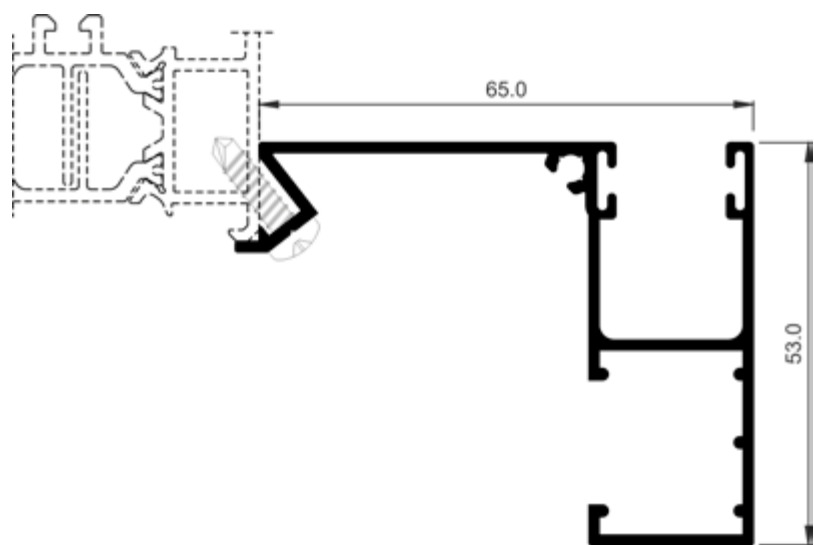

COR-2754	
Descripción Description	Guía de 65 mm Guide of 65 mm
Peso Weight (g/m)	777,6
Superficie Surface (dm²/m)	43,42
Ix (cm⁴)	9,13
Iy (cm⁴)	13
Observaciones Observations	Tornillo Ø3.9 mm DIN7504N-A2 Screw Ø3.9 mm DIN7504N-A2

COR 70 C16 ST  
Perfis à escala

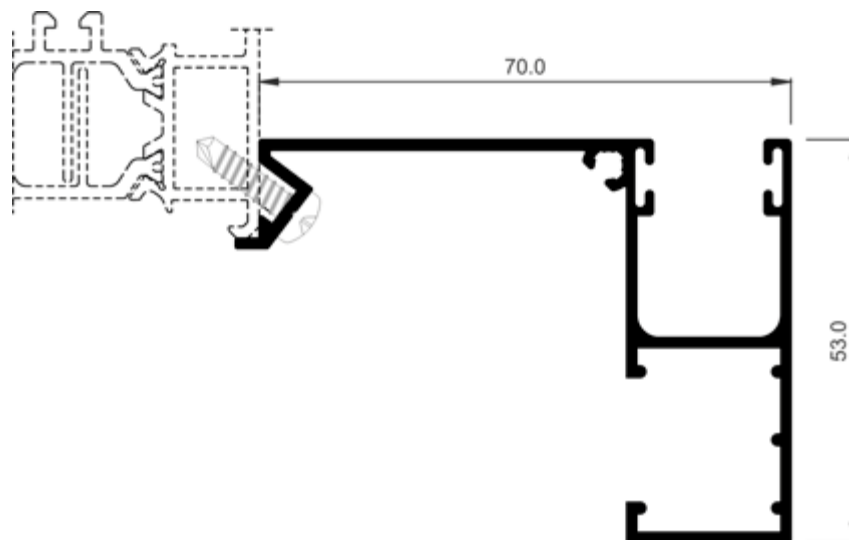

**COR-2755**

<b>Descripción</b> Description	Guía de 70 mm Guide of 70 mm
<b>Peso</b> Weight (g/m)	810
<b>Superficie</b> Surface (dm <sup>2</sup> /m)	44,33
<b>I<sub>x</sub></b> (cm <sup>4</sup> )	9,48
<b>I<sub>y</sub></b> (cm <sup>4</sup> )	16,21
<b>Observaciones</b> Observations	Tornillo Ø3.9 mm DIN7504N-A2 Screw Ø3.9 mm DIN7504N-A2

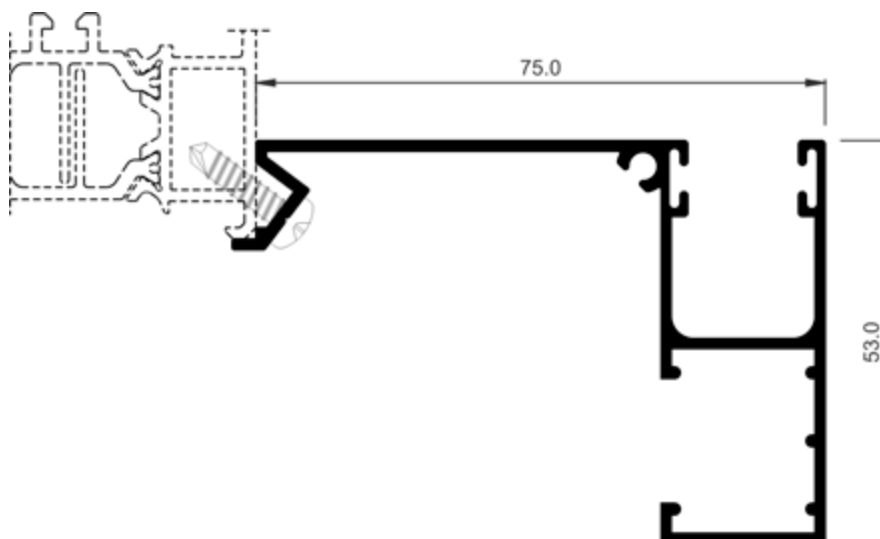

**COR-2756**

<b>Descripción</b> Description	Guía de 75 mm Guide of 75 mm
<b>Peso</b> Weight (g/m)	828,9
<b>Superficie</b> Surface (dm <sup>2</sup> /m)	44,99
<b>I<sub>x</sub></b> (cm <sup>4</sup> )	9,72
<b>I<sub>y</sub></b> (cm <sup>4</sup> )	18,84
<b>Observaciones</b> Observations	Tornillo Ø3.9 mm DIN7504N-A2 Screw Ø3.9 mm DIN7504N-A2

COR 70 C16 ST  
Perfis à escala

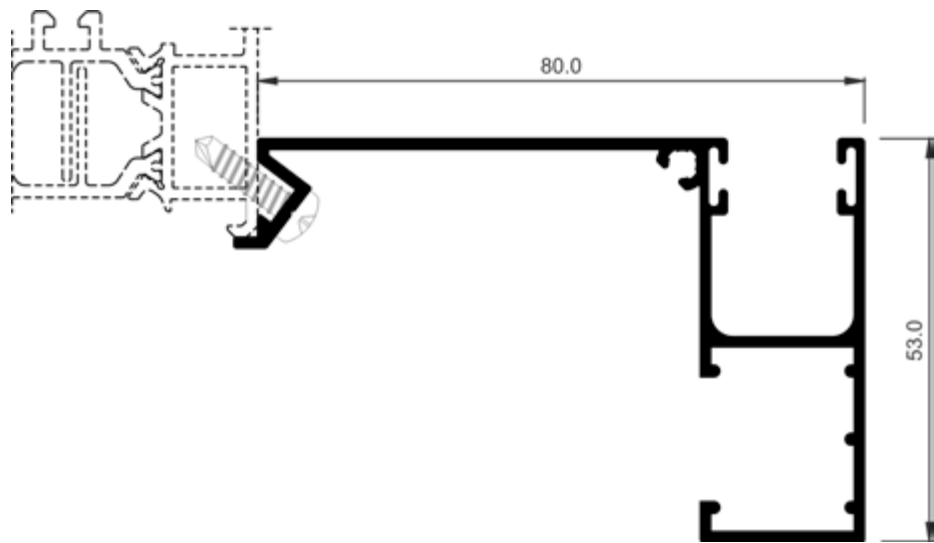

COR-2757	
Descripción Description	Guía de 80 mm Guide of 80 mm
Peso Weight (g/m)	847,8
Superficie Surface (dm²/m)	46,33
Ix (cm⁴)	9,91
Iy (cm⁴)	22,59
Observaciones Observations	Tornillo Ø3.9 mm DIN7504N-A2 Screw Ø3.9 mm DIN7504N-A2

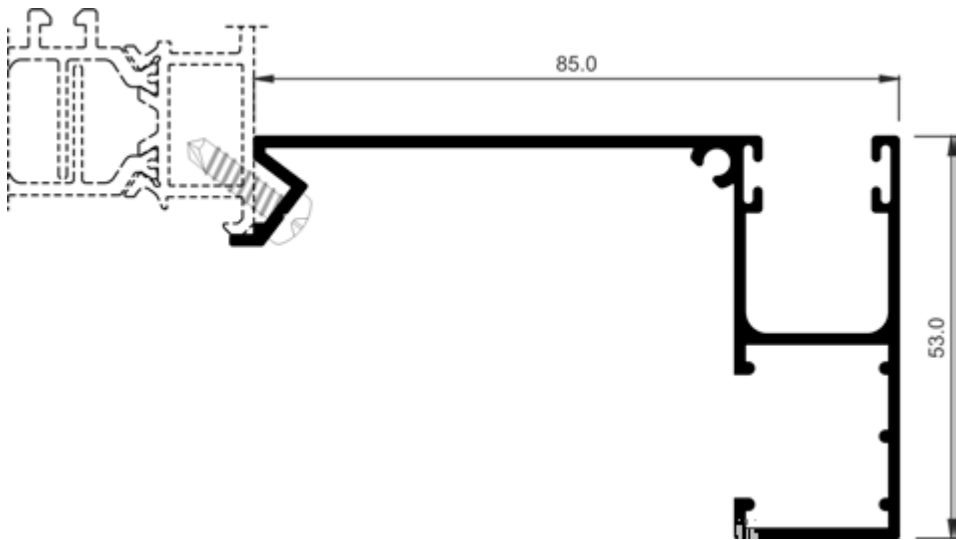

COR-2758	
Descripción Description	Guía de 85 mm Guide of 85 mm
Peso Weight (g/m)	866,7
Superficie Surface (dm²/m)	46,99
Ix (cm⁴)	10,13
Iy (cm⁴)	25,79
Observaciones Observations	Tornillo Ø3.9 mm DIN7504N-A2 Screw Ø3.9 mm DIN7504N-A2



COR 70 C16 ST  
Perfis à escala

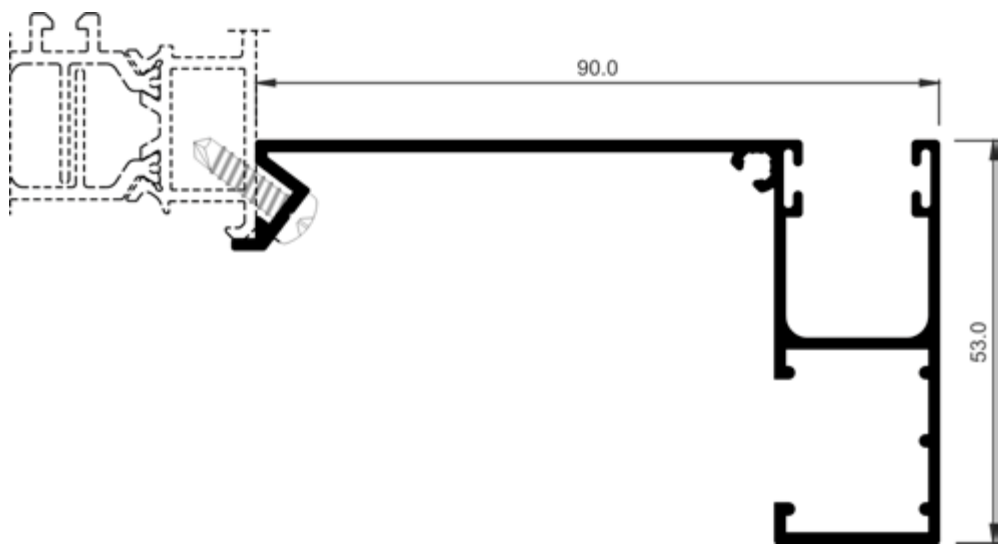

COR-2759	
Descripción Description	Guía de 90 mm Guide of 90 mm
Peso Weight (g/m)	885,6
Superficie Surface (dm²/m)	48,32
Ix (cm⁴)	10,3
Iy (cm⁴)	30,36
Observaciones Observations	Tornillo Ø3.9 mm DIN7504N-A2 Screw Ø3.9 mm DIN7504N-A2

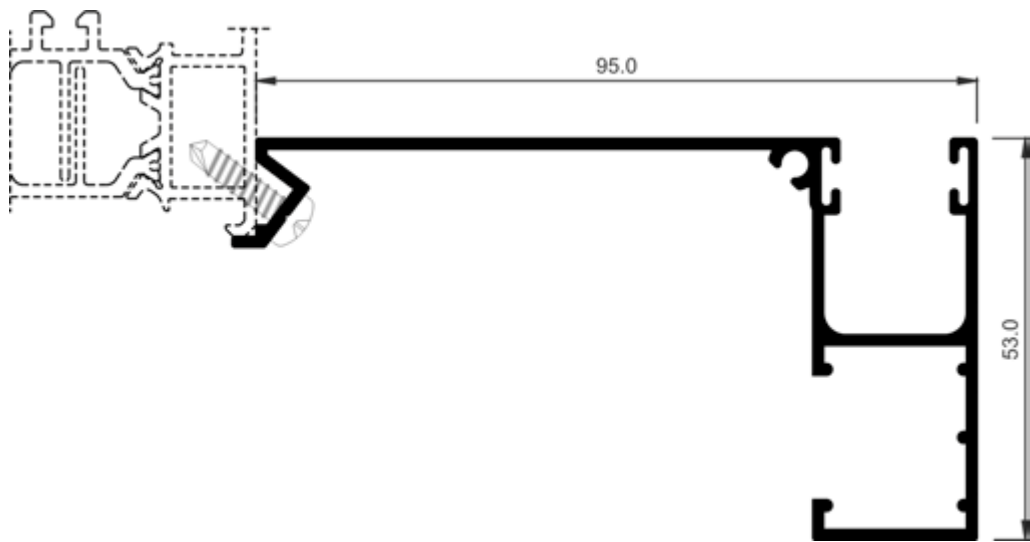

COR-2760	
Descripción Description	Guía de 95 mm Guide of 95 mm
Peso Weight (g/m)	918
Superficie Surface (dm²/m)	48,83
Ix (cm⁴)	10,72
Iy (cm⁴)	34,47
Observaciones Observations	Tornillo Ø3.9 mm DIN7504N-A2 Screw Ø3.9 mm DIN7504N-A2



ALUMINIOS IBÉRICA, S.A.



PALA-MIGUEL S REIS, Lda.



ALUMINIOS DE VISEULDA



ANGULAR - Aluminios, Lda.

COR 70 C16 ST  
Perfis à escala

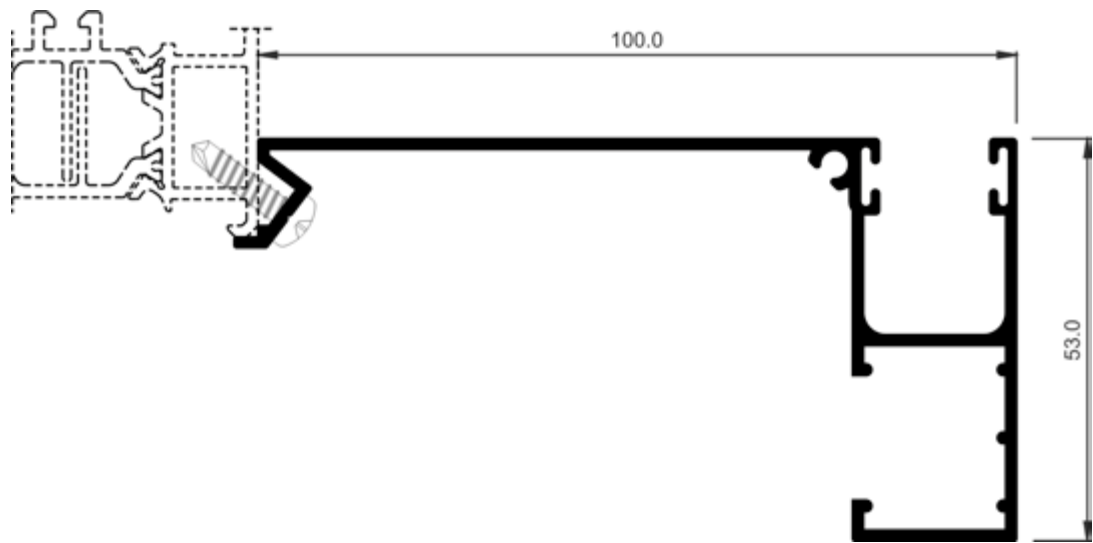

COR-2761	
Descripción Description	Guía de 100 mm Guide of 100 mm
Peso Weight (g/m)	950,4
Superficie Surface (dm²/m)	49,73
Ix (cm⁴)	11,1
Iy (cm⁴)	39,59
Observaciones Observations	Tornillo Ø3.9 mm DIN7504N-A2 Screw Ø3.9 mm DIN7504N-A2



COR-2763	
Descripción Description	Guía de 110 mm Guide of 110 mm
Peso Weight (g/m)	977,4
Superficie Surface (dm²/m)	52,13
Ix (cm⁴)	11,4
Iy (cm⁴)	50,19
Observaciones Observations	Tornillo Ø3.9 mm DIN7504N-A2. CONSULTAR DISPONIBILIDAD Screw Ø3.9 mm DIN7504N-A2 CHECK AVAILABILITY

COR 70 C16 ST  
Perfis à escala

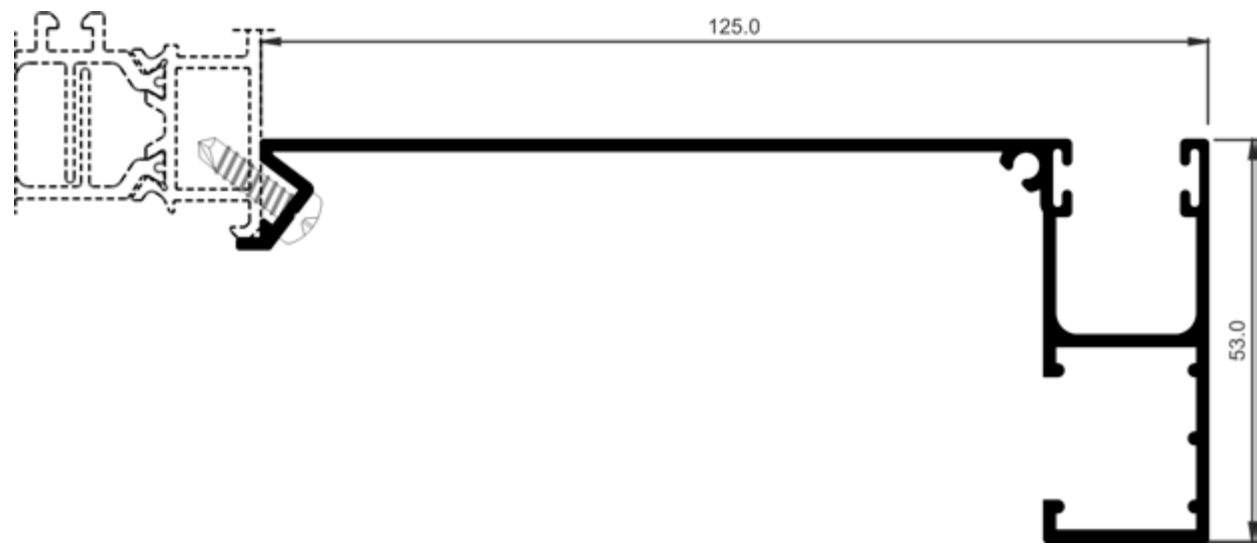

COR-2766	
Descripción Description	Guía de 125 mm 125 mm guide
Peso Weight (g/m)	1047,6
Superficie Surface (dm²/m)	54,82
Ix (cm⁴)	11,93
Iy (cm⁴)	70,69
Observaciones Observations	Tornillo Ø3.9 mm DIN7504N-A2 Screw Ø3.9 mm DIN7504N-A2

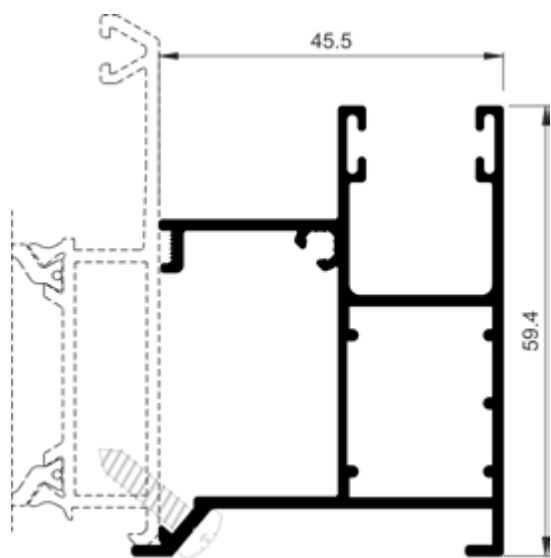

COR-2800	
Descripción Description	Guía de 45,5 mm embutir recogedor Cram scoop 45,5 mm guide
Peso Weight (g/m)	907,2
Superficie Surface (dm²/m)	47,85
Ix (cm⁴)	10,85
Iy (cm⁴)	7,1
Observaciones Observations	Tornillo Ø3.9 mm DIN7504N-A2 Screw Ø3.9 mm DIN7504N-A2

COR 70 C16 ST  
Perfis à escala

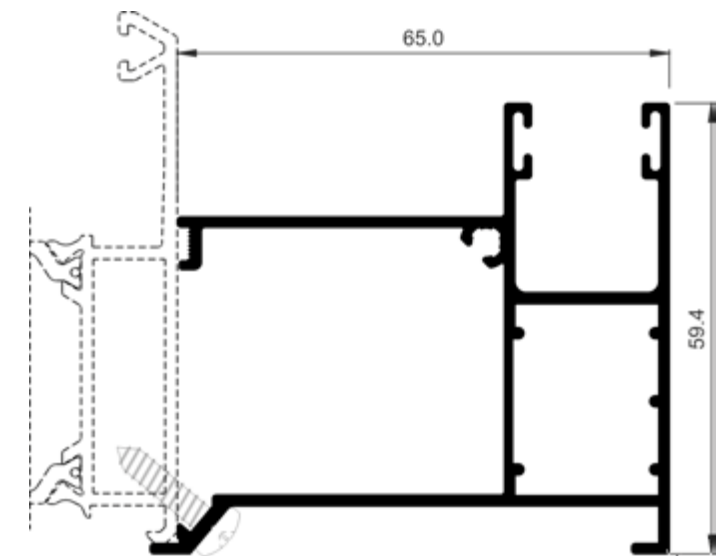

COR-2802	
Descripción Description	Guía de 65 mm embutir recogedor Cram scoop 65 mm guide
Peso Weight (g/m)	1061,1
Superficie Surface (dm²/m)	55,65
Ix (cm⁴)	12,79
Iy (cm⁴)	16,98
Observaciones Observations	Tornillo Ø3.9 mm DIN7504N-A2 Screw Ø3.9 mm DIN7504N-A2

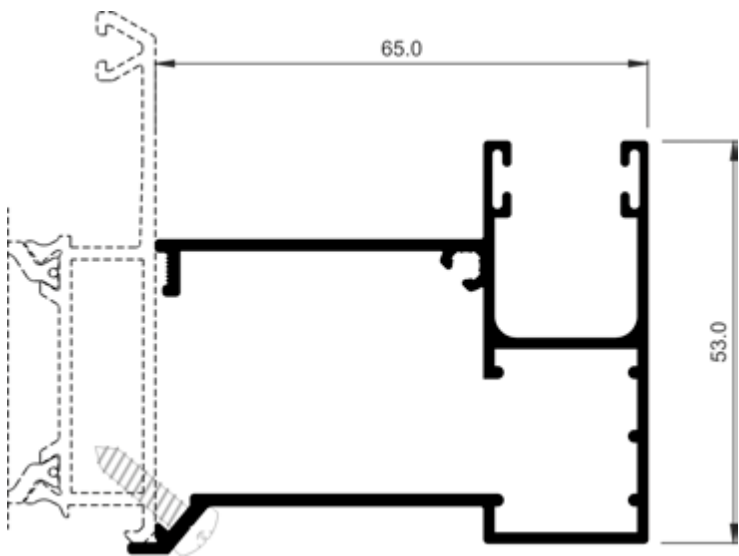

COR-2810	
Descripción Description	Guía de 65 mm embutir recogedor Cram scoop 65 mm guide
Peso Weight (g/m)	953,1
Superficie Surface (dm²/m)	50,76
Ix (cm⁴)	10,16
Iy (cm⁴)	15,92
Observaciones Observations	Tornillo Ø3.9 mm DIN7504N-A2 Screw Ø3.9 mm DIN7504N-A2

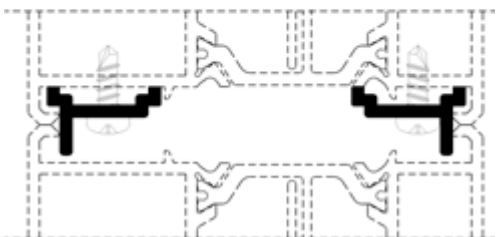
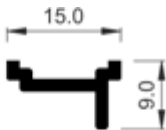

COR-7251	
Descripción Description	Unión de marcos oculta Concealed frame joint profile
Peso Weight (g/m)	105,3
Superficie Surface (dm²/m)	5,15
Ix (cm⁴)	0,02
Iy (cm⁴)	0,08
Observaciones Observations	Tornillo Ø2.9 mm DIN7504N-A2 Ø2.9 mm DIN7504N-A2 screw

**aluminiosiberica.pai.pt**



**ALUMÍNIOS IBÉRICA, S.A.**

**Sede e Fábrica: Rua do Parque Industrial, nº 126  
4720-5 Lago Amarelo**

**Telefs. 253 310 250 — 253 310 251 Fax 253 311 830**

**Email: aluminiosiberica@mail.telepac.pt**

**Filiais:**

**Rua da Mina, 562 - 4405-234 Canelas - V.N.Gaia**

**Telefs: 227 929 539 Fax 227 629 514**

**Zona Industrial de Constantim, Lote 53**

**5000-062 Constantim - Vila Real**

**Telefs: 259 331 778 Fax 259 338 552**



**ALUMÍNIOS DE VISEU, L.D.A.**

**Armazém: Est. do Campo de Aviação - CAMPO  
3510-824 VISEU**

**Telefs. 232 459 138—232 459 741**

**Fax 232 450 140**

**E-mail: geral@alviz.pt**



**P.A.L.A. - MIGUEL & REIS, LDA.**

**Ilhavo**

**Sede: Zona Industrial da Mota, Rua 7 lote 21—A  
Gafanha da Encarnação — Apartado 523**

**3834-909 Ilhavo**

**Telefs: 234 329 120 — Fax 234 329 121**

**E-mail: pala.aluminio@sapo.pt**

**Leiria**

**Armazéns: Canhestro—Pousas 2410-235 LEIRIA**

**Telefs: 244 801 593 Fax 244 855 702**

**E-mail: pala.leiria@sapo.pt**

**Algarve**

**Zona Industrial de Vilamoura**

**Lote 28—Apartado 841 , 8126-910 Quarteira**

**Telefs: 289 322 748—Fax 289 301 928**

**E-mail: pala.loulé@sapo.pt**



**ANGULAR - Aluminios, Lda**

**Armazém: Av.Almirante Gago Coutinho**

**Portela de Sintra—Apartado 212**

**2711-901 SINTRA**

**Telefs. 219 244 074—219 244 101**

**Fax 219 241 015**