



ALUMÍNIOS IBÉRICA, S.A.



P.A.L.A. - MIGUEL & REIS, LDA.



ALUMÍNIOS DE VISEU, LDA.



ANGULAR - Alumínios, Lda.

Catálogo COR 80 INDUSTRIAL



Sistema
► COR 80 INDUSTRIAL

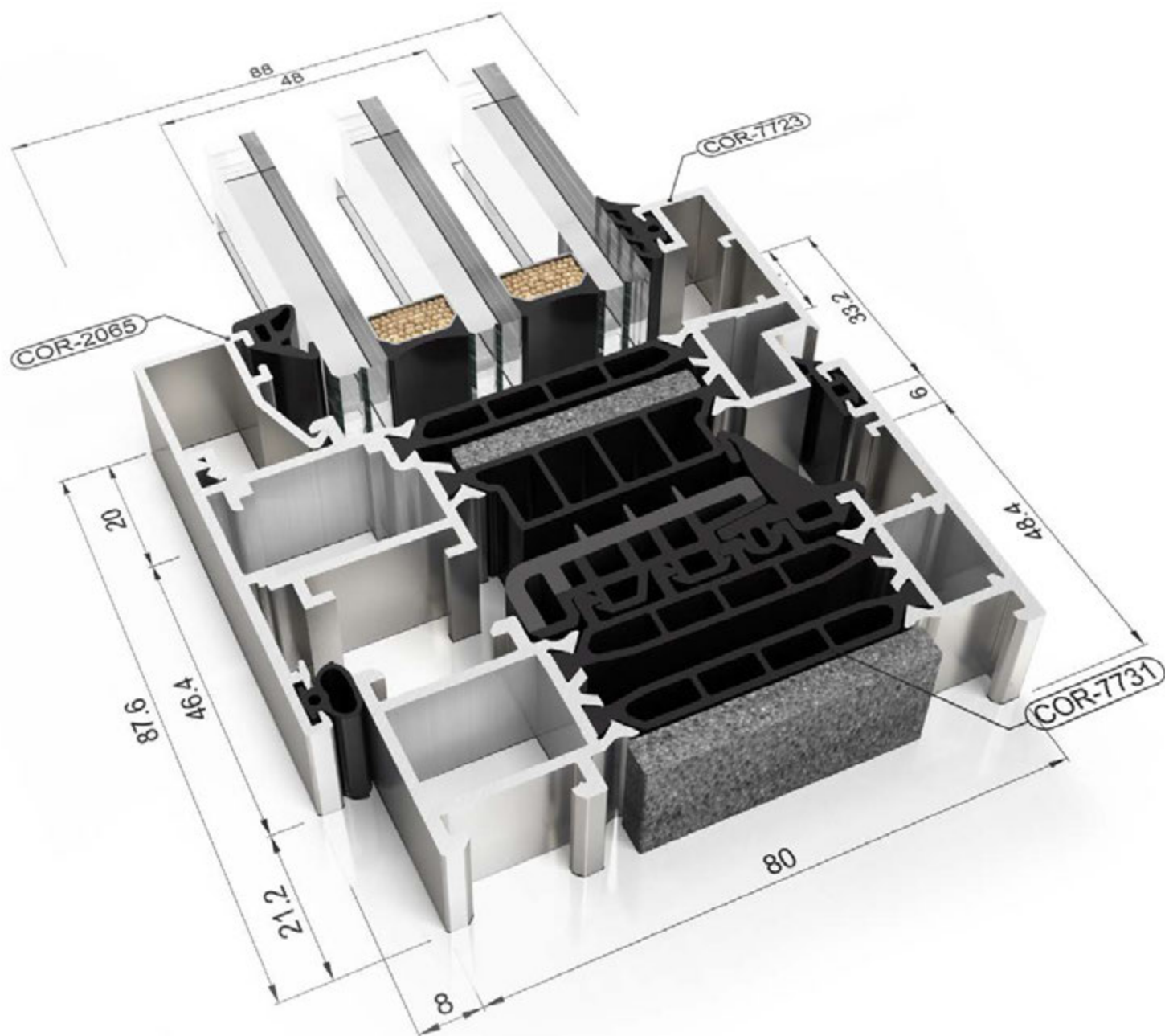

ALUMINIOS IBÉRICA, S.A.



PALA-MIGUEL S REIS, Lda.



ALUMINIOS DE VISEU, Lda.



ANGULAR - Aluminios, Lda.

Sistema
➤ **COR 80 INDUSTRIAL**



ALUMINIOS IBÉRICA, S.A.



PALA-MIGUEL S REIS, LDA.



ALUMINIOS DE VISEU, LDA.



ANGULAR - Aluminios, Lda.

Transmitancia

$$U_w \geq 0,8 \text{ (W/m}^2\text{K)}$$

Consultar tipología, dimensión y vidrio.

CTE - Apto para zonas climáticas*: α A B C D E

*En función de la transmitancia del vidrio.

Aislamiento acústico /

Máximo acristalamiento 65 mm

Máximo aislamiento acústico $R_w = 46 \text{ dB}$

Secciones **Espesor perfilería**

Marco	80 mm	Ventana	1,5 mm
Hoja	88 mm	Puerta	1,7 mm

Longitud varilla poliamida 45 mm

Presenta la posibilidad de incorporar herraje con bisagras ocultas y herraje de seguridad Evo Security.

Categorías alcanzadas en banco de ensayos

Permeabilidad al aire
(UNE-EN 12207:2000): Clase 4

Estanqueidad al agua
(UNE-EN 12208:2000): Clase E1950

Resistencia al viento
(UNE-EN 12210:2000): Clase C5

Ensayo de referencia ventana 1,23 x 1,48 m, 2 hojas.

Acabados

Posibilidad bicolor

Lacado colores (RAL, moteados y rugosos)

Lacado imitación madera

Lacado antibacteriano

Anodizado

Posibilidades de apertura

Apertura interior: practicable, oscilo-batiente, oscilo-parallel y abatible.

Apertura exterior: Practicable, proyectante deslizante.

Dimensiones máximas/hoja

Ancho (L) = 1.600 mm

Alto (H) = 2.600 mm

Consultar peso y dimensiones máximas según tipología.

Peso máximo/hoja 120 Kg.

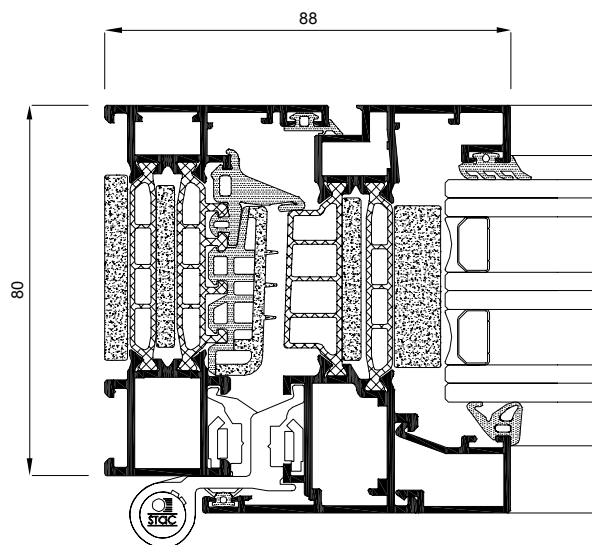

COR 80 INDUSTRIAL

Perfiles a escala

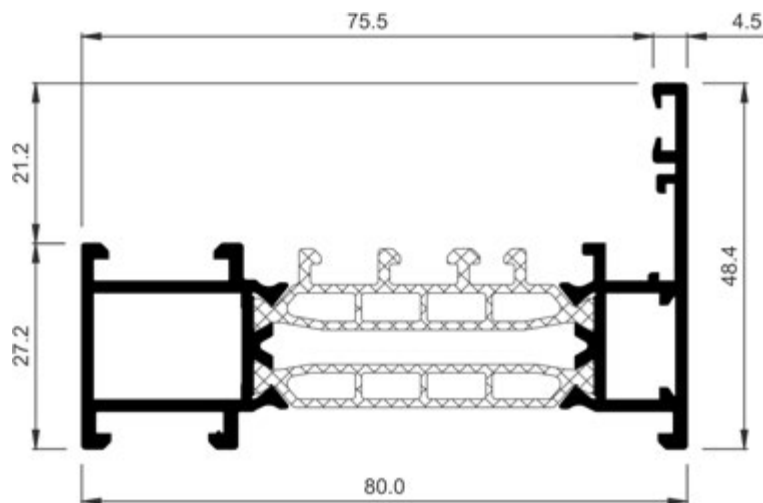

COR-7730	
Descripción Description	Marco ventana apertura interior Inside opening window frame
Peso Weight (g/m)	1599
Superficie Surface (dm ² /m)	47,28
Ix (cm ⁴)	4,82
Iy (cm ⁴)	37,15
Escuadra principal Main cleat	347922
Troquel Die	337999 347799
Escuadra secundaria Secondary cleat	327920
Escuadra alineamiento Alignment cleat	296838

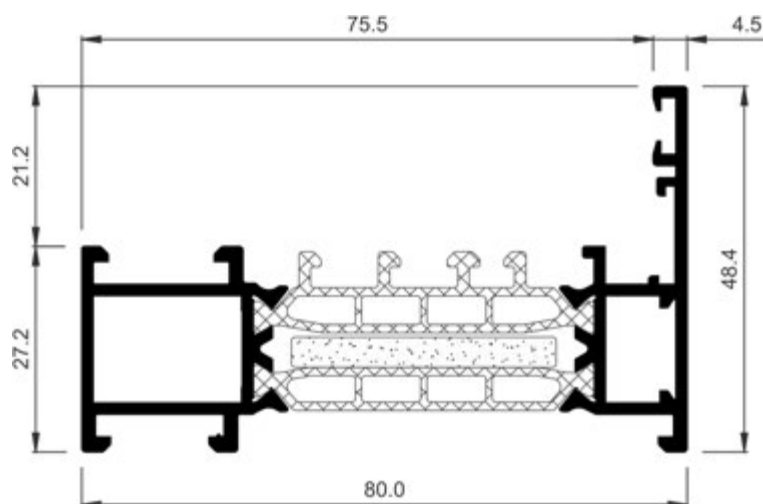

COR-7731	
Descripción Description	Marco ventana apertura interior HI HI inside opening window frame
Peso Weight (g/m)	1599
Superficie Surface (dm ² /m)	47,28
Ix (cm ⁴)	4,82
Iy (cm ⁴)	37,15
Escuadra principal Main cleat	347922
Troquel Die	337999 347799
Escuadra secundaria Secondary cleat	327920
Escuadra alineamiento Alignment cleat	296838



ALUMINIOS IBÉRICA, S.A.



PALA-MIGUEL S REIS, Lda.



ALUMINIOS DE VISEULDA.



ANGULAR - Aluminios, Lda.

COR 80 INDUSTRIAL

Perfiles a escala

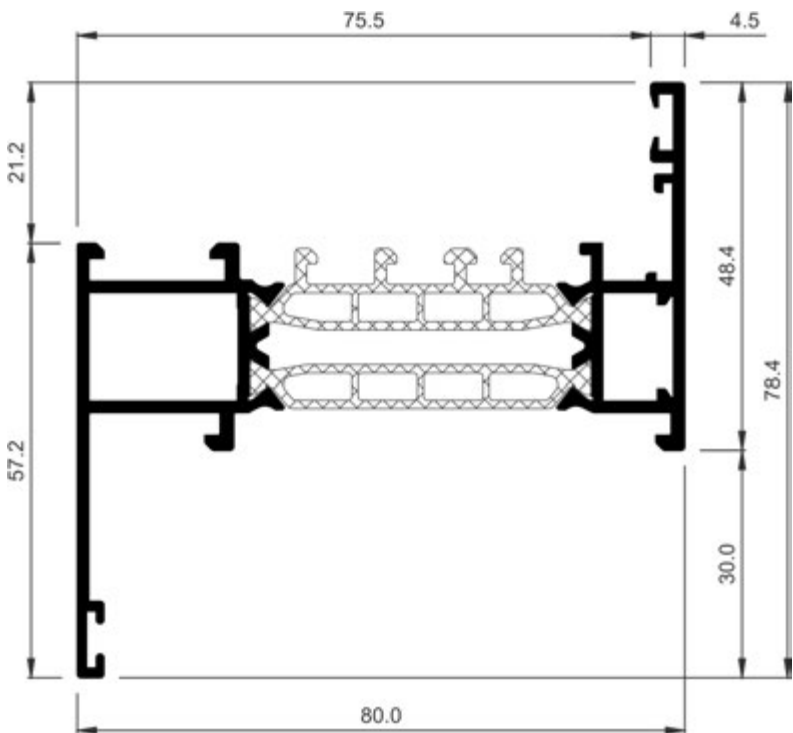

COR-7732	
Descripción Description	Marco ventana apertura interior con solape de 30 mm Inside opening window frame with 30 mm overlap
Peso Weight (g/m)	1723,2
Superficie Surface (dm²/m)	54,36
Ix (cm⁴)	10,1
Iy (cm⁴)	44,77
Escuadra principal Main cleat	347922
Troquel Die	337999 347799
Escuadra secundaria Secondary cleat	327920
Escuadra alineamiento Alignment cleat	296838 960023

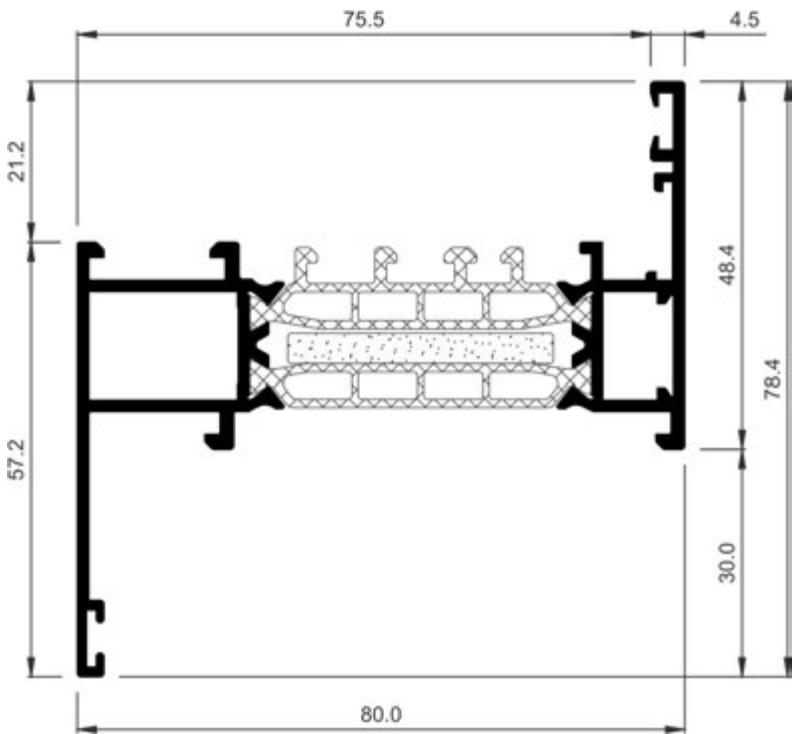

COR-7733	
Descripción Description	Marco ventana apertura interior HI con solape de 30 mm HI inside opening window frame with 30 mm overlap
Peso Weight (g/m)	1723,2
Superficie Surface (dm²/m)	54,36
Ix (cm⁴)	10,1
Iy (cm⁴)	44,77
Escuadra principal Main cleat	347922
Troquel Die	337999 347799
Escuadra secundaria Secondary cleat	327920
Escuadra alineamiento Alignment cleat	296838 960023



ALUMINIOS IBÉRICA, S.A.



PALA-MIGUEL S REIS, Lda.



ALUMINIOS DE VISEU Lda.



ANGULAR - Aluminios, Lda.

COR 80 INDUSTRIAL

Perfiles a escala

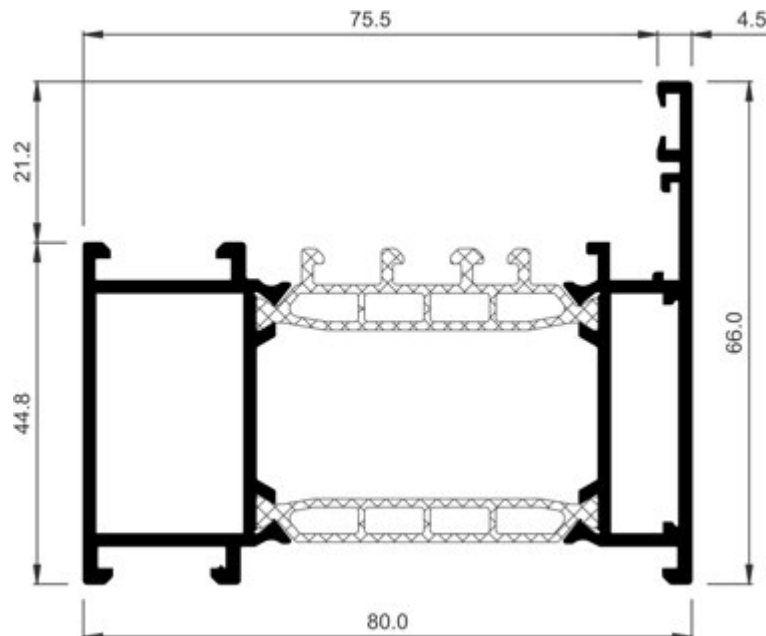

COR-7735	
Descripción Description	Marco balconera apertura interior Inside opening balcony frame
Peso Weight (g/m)	1939,2
Superficie Surface (dm ² /m)	61,19
I_x (cm ⁴)	14,27
I_y (cm ⁴)	50,47
Escuadra principal Main cleat	247231
Troquel Die	337999
	347799
Escuadra secundaria Secondary cleat	327924
Escuadra alineamiento Alignment cleat	296838

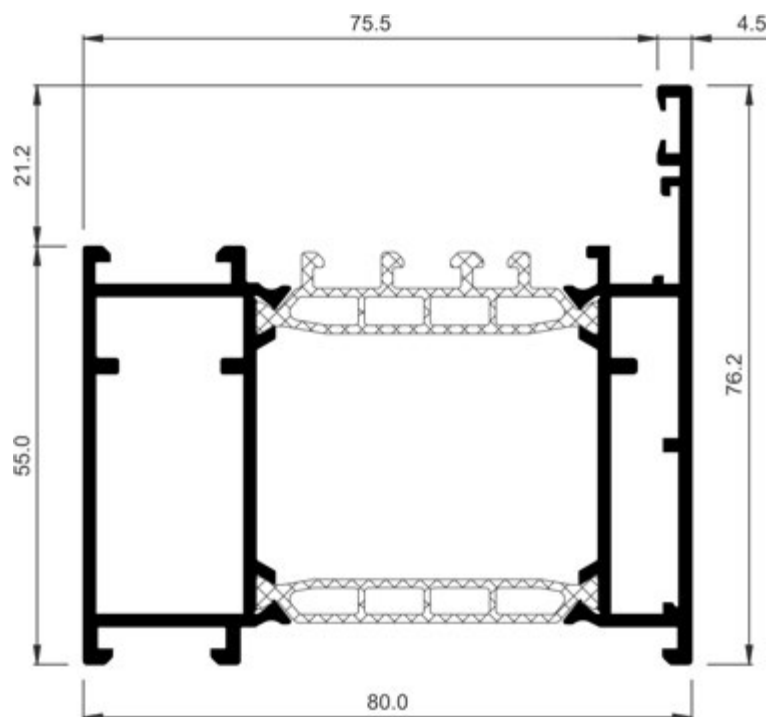

COR-7736	
Descripción Description	Marco balconera embutir recogedor Cram balcony frame
Peso Weight (g/m)	2171,4
Superficie Surface (dm ² /m)	71,38
I_x (cm ⁴)	23,17
I_y (cm ⁴)	59,37
Escuadra principal Main cleat	247231
Troquel Die	337999
	347799
Escuadra secundaria Secondary cleat	327924
Escuadra alineamiento Alignment cleat	296838



ALUMINIOS IBÉRICA, S.A.



PALA-MIGUEL S REIS, Lda.



ALUMINIOS DE VISEU Lda.



ANGULAR - Aluminios, Lda.

COR 80 INDUSTRIAL

Perfiles a escala

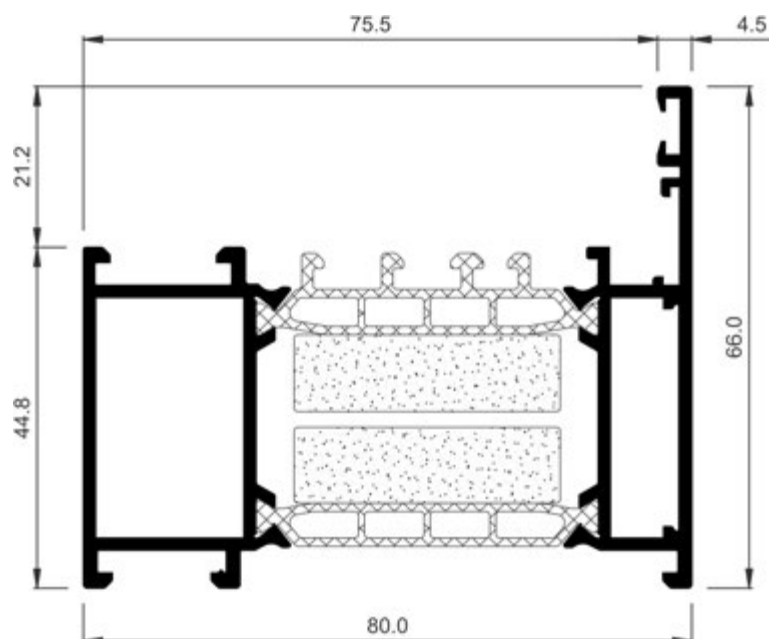

COR-7737	
Descripción Description	Marco balconera apertura interior HI HI inside opening balcony frame
Peso Weight (g/m)	1939,2
Superficie Surface (dm ² /m)	61,19
I_x (cm ⁴)	14,27
I_y (cm ⁴)	50,47
Escuadra principal Main cleat	247231
Troquel Die	337999
Escuadra secundaria Secondary cleat	347799
Escuadra alineamiento Alignment cleat	327924
	296838

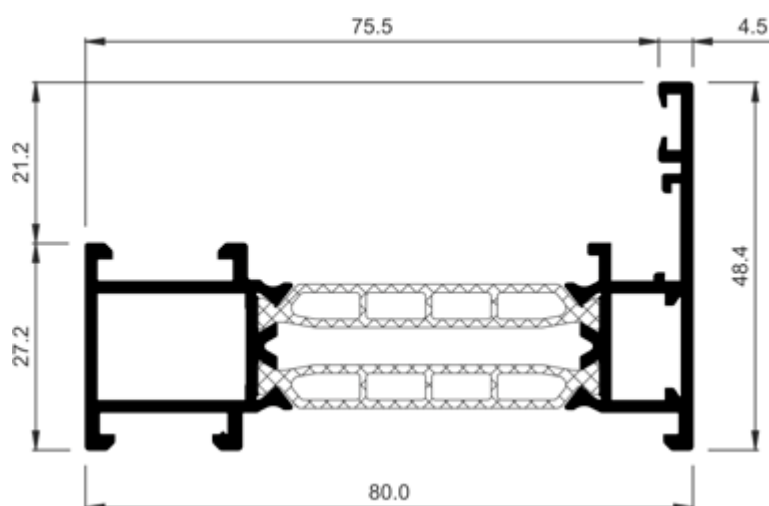

COR-7738	
Descripción Description	Marco ventana apertura exterior Outer opening window frame
Peso Weight (g/m)	1599,2
Superficie Surface (dm ² /m)	47,28
I_x (cm ⁴)	4,82
I_y (cm ⁴)	37,15
Escuadra principal Main cleat	347922
Troquel Die	337999
Escuadra secundaria Secondary cleat	327920
Escuadra alineamiento Alignment cleat	296838

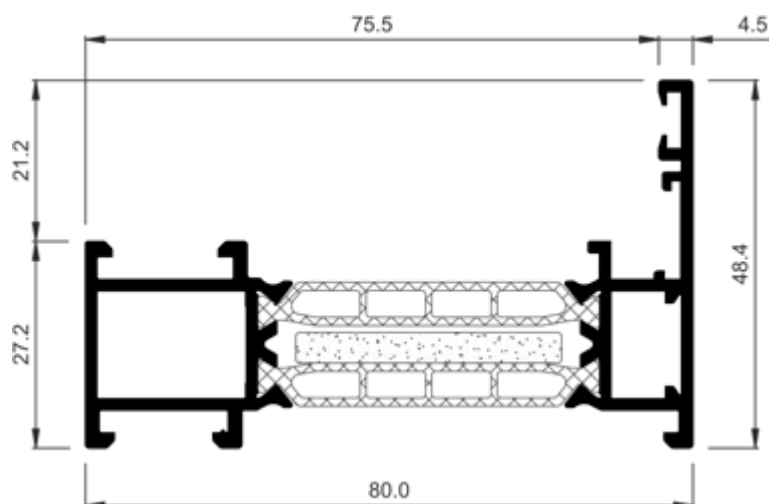

COR-7739	
Descripción Description	Marco ventana apertura exterior HI Outer opening HI window frame
Peso Weight (g/m)	1599,2
Superficie Surface (dm ² /m)	47,28
I_x (cm ⁴)	4,82
I_y (cm ⁴)	37,15
Escuadra principal Main cleat	347922
Troquel Die	337999
Escuadra secundaria Secondary cleat	327920
Escuadra alineamiento Alignment cleat	296838



ALUMINIOS IBÉRICA, S.A.



PALA-MIGUEL S REIS, LDA.



ALUMINIOS DE VISEULDA



ANGULAR - Aluminios, Lda.

COR 80 INDUSTRIAL

Perfiles a escala

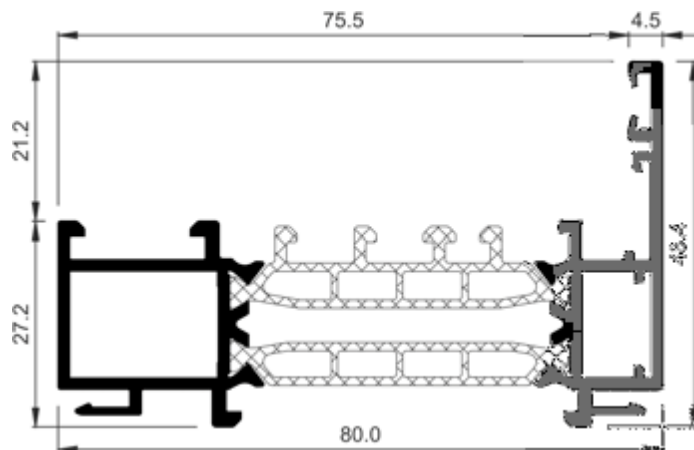

COR-7750	
Descripción Description	Marco ventana apertura interior con enganche Inside opening window frame with hook
Peso Weight (g/m)	1612,5
Superficie Surface (dm ² /m)	49,63
I_x (cm ⁴)	4,93
I_y (cm ⁴)	36,1
Escuadra principal Main cleat	347950
Troquel Die	347799 349902
Escuadra secundaria Secondary cleat	327920
Escuadra alineamiento Alignment cleat	296838
Observaciones Observations	Para el mecanizado de los enganches añadir el kit 349902 al troquel de escuadras 347799 For hooks machining add kit 349902 to cleat punch tool 347799

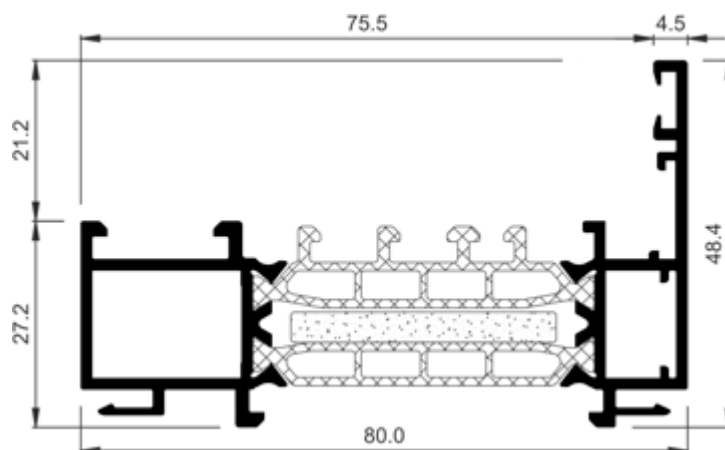

COR-7751	
Descripción Description	Marco ventana apertura interior HI con enganche HI inside opening window with hook
Peso Weight (g/m)	1612,5
Superficie Surface (dm ² /m)	49,63
I_x (cm ⁴)	4,93
I_y (cm ⁴)	36,1
Escuadra principal Main cleat	347950
Troquel Die	347799 349902
Escuadra secundaria Secondary cleat	327920
Escuadra alineamiento Alignment cleat	296838
Observaciones Observations	Para el mecanizado de los enganches añadir el kit 349902 al troquel de escuadras 347799 For hooks machining add kit 349902 to cleat punch tool 347800



ALUMINIOS IBÉRICA, S.A.



PALA-MIGUEL S REIS, Lda.



ALUMINIOS DE VISEU, Lda.



ANGULAR - Aluminios, Lda.

COR 80 INDUSTRIAL

Perfiles a escala

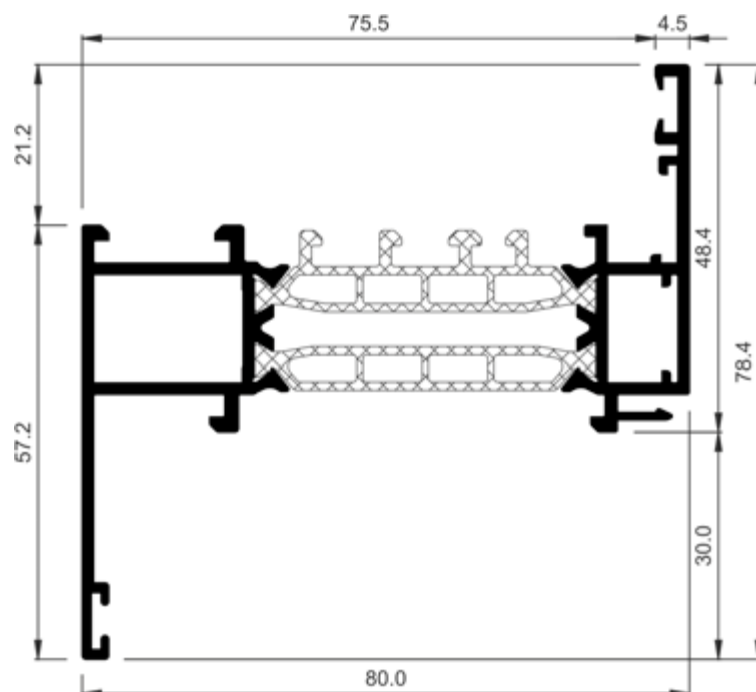

COR-7752	
Descripción Description	Marco ventana apertura interior con solape 30 mm y enganche Inside opening window frame with 30 mm overlap and hook
Peso Weight (g/m)	1736,7
Superficie Surface (dm ² /m)	55,95
I_x (cm ⁴)	10,17
I_y (cm ⁴)	44,51
Escuadra principal Main cleat	347922
Troquel Die	347799 349902
Escuadra secundaria Secondary cleat	327920
Escuadra alineamiento Alignment cleat	296838 960023
Observaciones Observations	Para el mecanizado de los enganches añadir el kit 349902 al troquel de escuadras 347799 For hooks machining add kit 349902 to cleat punch tool 347801

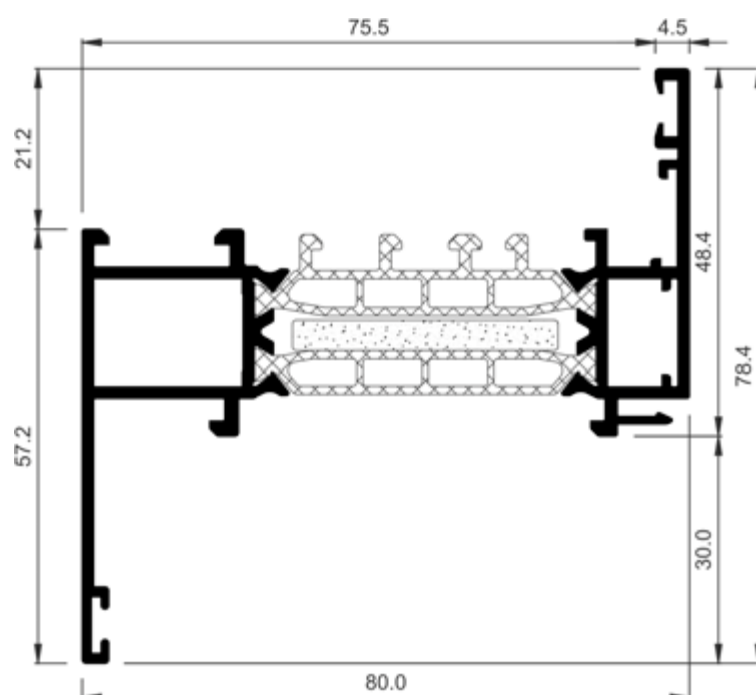

COR-7753	
Descripción Description	Marco ventana apertura interior HI con solpae 30 mm y enganche HI inside opening window frame with 30 mm overlap and hook
Peso Weight (g/m)	1736,7
Superficie Surface (dm ² /m)	55,95
I_x (cm ⁴)	10,17
I_y (cm ⁴)	44,51
Escuadra principal Main cleat	347922
Troquel Die	347799 349902
Escuadra secundaria Secondary cleat	327920
Escuadra alineamiento Alignment cleat	296838 960023
Observaciones Observations	Para el mecanizado de los enganches añadir el kit 349902 al troquel de escuadras 347799 For hooks machining add kit 349902 to cleat punch tool 347802



ALUMINIOS IBÉRICA, S.A.



P.A.L.A. - MIGUEL S. REIS, Lda.



ALUMINIOS DE VISEUGUA



ANGULAR - Aluminios, Lda.

COR 80 INDUSTRIAL

Perfiles a escala

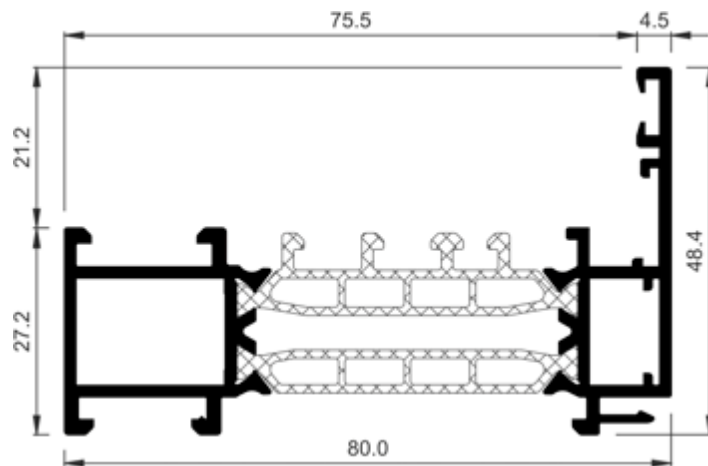

COR-7756	
Descripción Description	Marco ventana con enganche Window frame with hook
Peso Weight (g/m)	1612,5
Superficie Surface (dm ² /m)	48,87
I_x (cm ⁴)	4,95
I_y (cm ⁴)	36,87
Escuadra principal Main cleat	347922
Troquel Die	347799 349902
Escuadra secundaria Secondary cleat	327920
Escuadra alineamiento Alignment cleat	296838
Observaciones Observations	Para el mecanizado de los enganches añadir el kit 349902 al troquel de escuadras 347799 For hooks machining add kit 349902 to cleat punch tool 347803

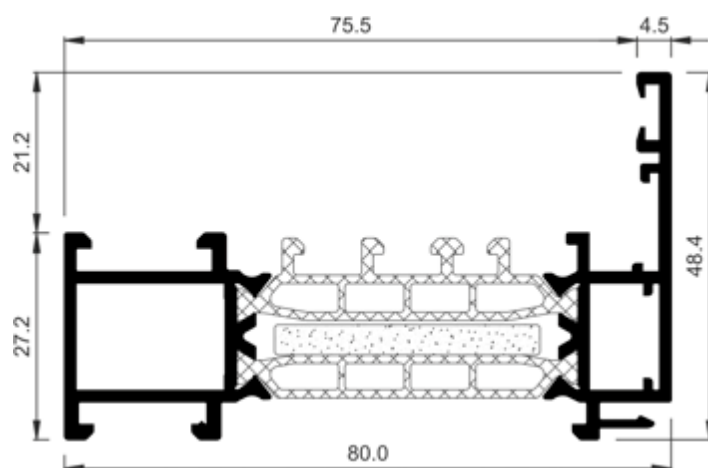

COR-7757	
Descripción Description	Marco ventana con enganche HI HI window frame with hook
Peso Weight (g/m)	1612,5
Superficie Surface (dm ² /m)	48,87
I_x (cm ⁴)	4,95
I_y (cm ⁴)	36,87
Escuadra principal Main cleat	347922
Troquel Die	347999 349902
Escuadra secundaria Secondary cleat	327920
Escuadra alineamiento Alignment cleat	296838
Observaciones Observations	Para el mecanizado de los enganches añadir el kit 349902 al troquel de escuadras 347799 For hooks machining add kit 349902 to cleat punch tool 347804



ALUMINIOS IBÉRICA, S.A.



PALA-MIGUEL S REIS, Lda.



ALUMINIOS DE VISEULDA



ANGULAR - Aluminios, Lda.

COR 80 INDUSTRIAL

Perfiles a escala

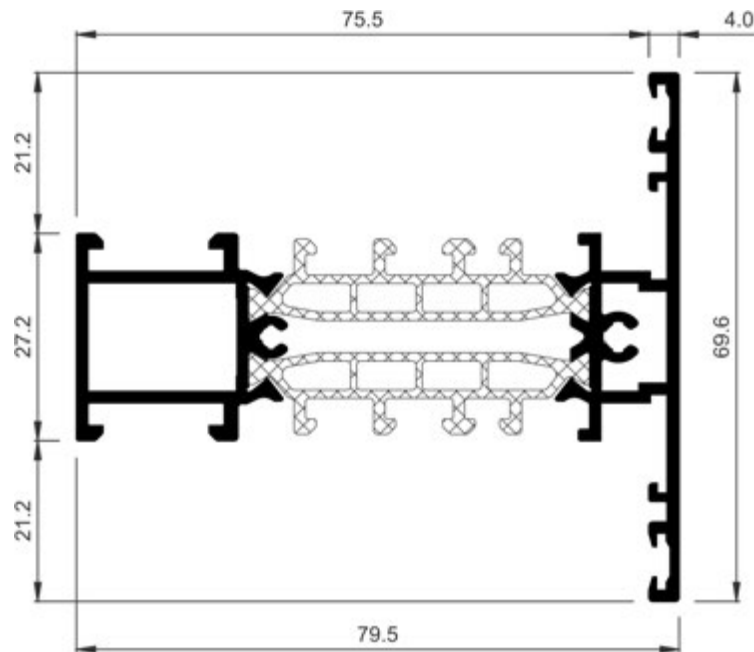

COR-7770	
Descripción Description	Travesaño ventana apertura interior Inside opening window transom
Peso Weight (g/m)	1779,9
Superficie Surface (dm ² /m)	57,01
Ix (cm ⁴)	8,07
Iy (cm ⁴)	41,99
Fresa Miller	327991
	347791
Troquel Die	337999
Tope travesaño interior Internal transom stop	920140
Tope travesaño exterior External transom stop	327971

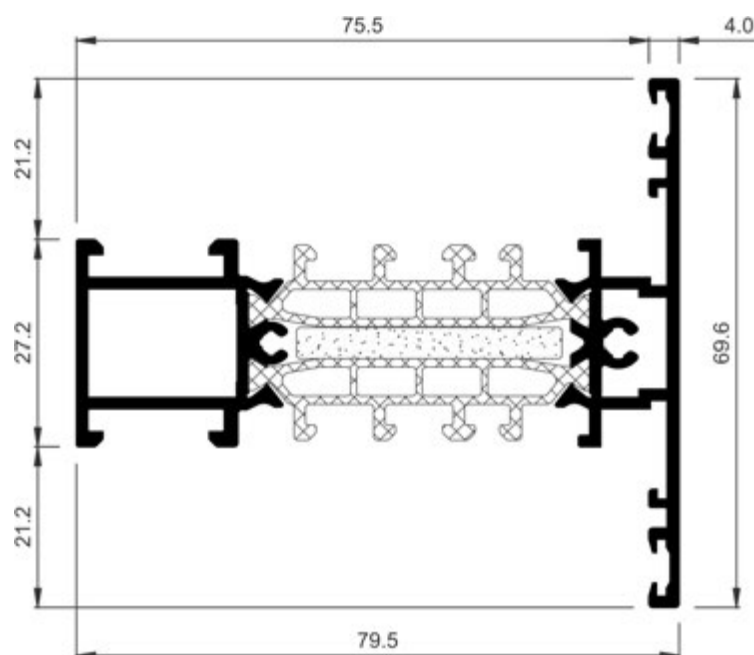

COR-7771	
Descripción Description	Travesaño ventana apertura interior HI HI inside opening window transom
Peso Weight (g/m)	1779,9
Superficie Surface (dm ² /m)	57,01
Ix (cm ⁴)	8,07
Iy (cm ⁴)	41,99
Fresa Miller	327991
	347791
Troquel Die	337999
Tope travesaño interior Internal transom stop	920140
Tope travesaño exterior External transom stop	327971



ALUMINIOS IBÉRICA, S.A.



PALA-MIGUEL S REIS, Lda.



ALUMINIOS DE VISEU Lda.



ANGULAR - Aluminios, Lda.

COR 80 INDUSTRIAL

Perfiles a escala

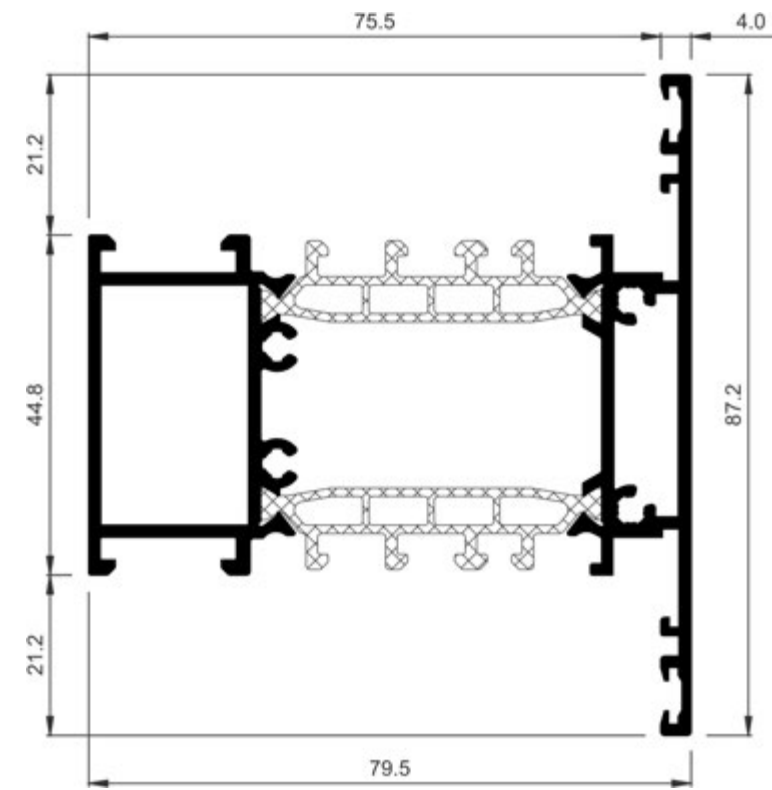

COR-7775	
Descripción Description	Travesaño balconera apertura interior inside opening balcony transom
Peso Weight (g/m)	2171,4
Superficie Surface (dm²/m)	72,45
Ix (cm⁴)	20,38
Iy (cm⁴)	56,4
Fresa Miller	327991
	347791
Troquel Die	337999
Tope travesaño interior Internal transom stop	920150
Tope travesaño exterior External transom stop	327971

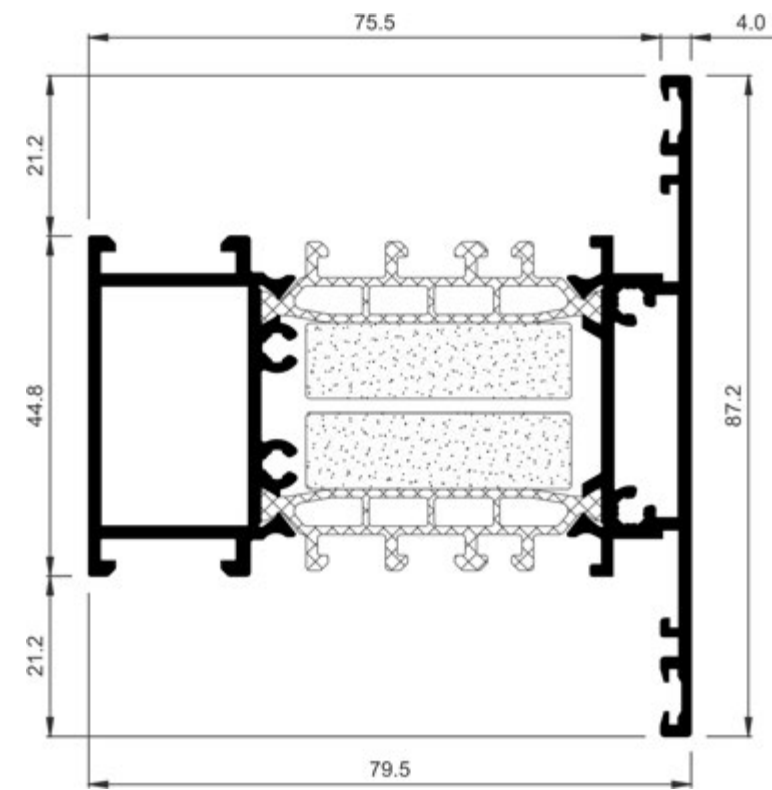

COR-7776	
Descripción Description	Travesaño balconera apertura interior HI HI inside opening balcony transom
Peso Weight (g/m)	2171,4
Superficie Surface (dm²/m)	72,45
Ix (cm⁴)	20,38
Iy (cm⁴)	56,4
Fresa Miller	327991
	347791
Troquel Die	337999
Tope travesaño interior Internal transom stop	920150
Tope travesaño exterior External transom stop	327971

COR 80 INDUSTRIAL

Perfiles a escala

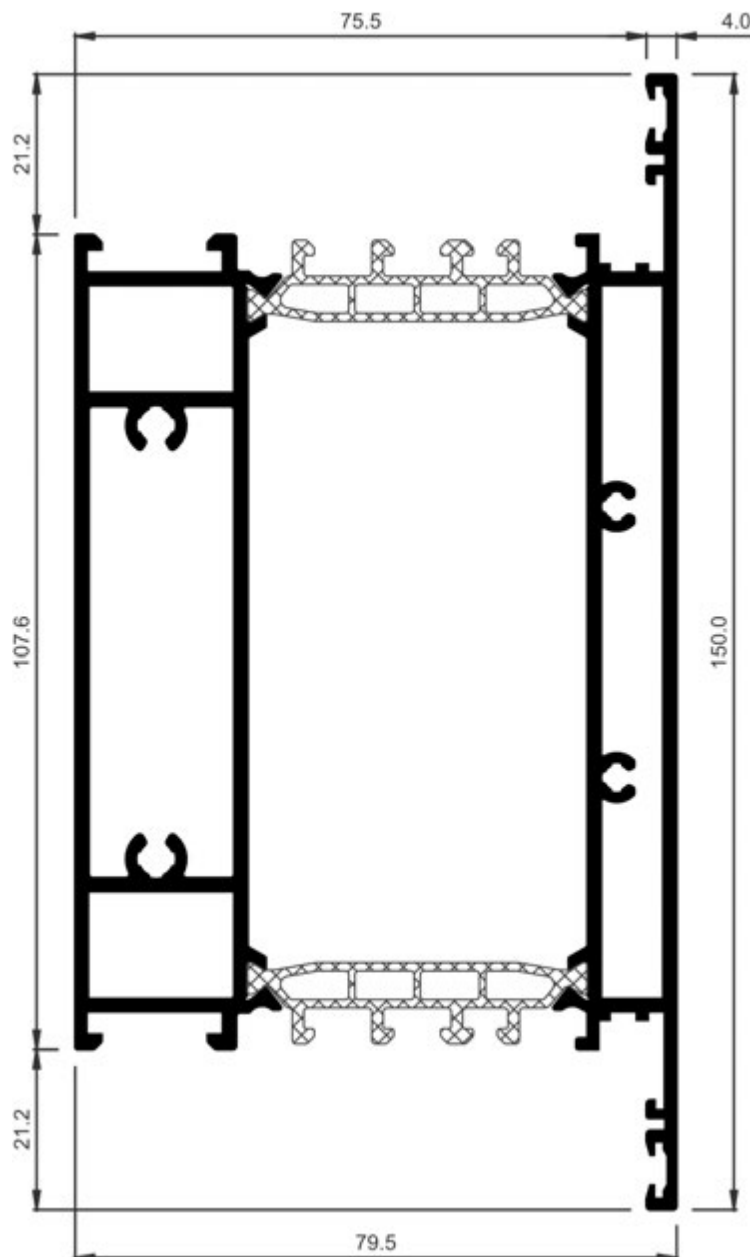

COR-7777	
Descripción Description	Travesaño de 150 mm apertura interior Inside opening 150 mm transom
Peso Weight (g/m)	3713,1
Superficie Surface (dm ² /m)	133,34
I _x (cm ⁴)	160,11
I _y (cm ⁴)	117,21
Fresa Miller	327991
	347791
Troquel Die	337999
Tope travesaño interior Internal transom stop	920140
Tope travesaño exterior External transom stop	327971

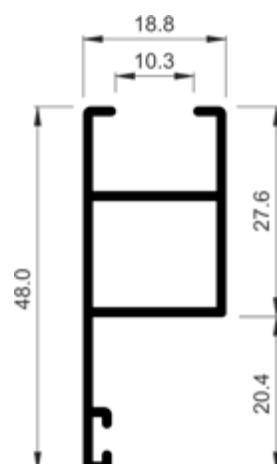

770226	
Descripción Description	Hoja de contra recta Straight shutter sash
Peso Weight (g/m)	399,6
Superficie Surface (dm ² /m)	24,06
I _x (cm ⁴)	2,5
I _y (cm ⁴)	0,81
Escuadra principal Main cleat	920425
Troquel Die	337999
Observaciones Observations	CONSULTAR DISPONIBILIDAD CHECK AVAILABILITY



ALUMINIOS IBÉRICA, S.A.



P.A.L.A. - MIGUEL S. REIS, Lda.



ALUMINIOS DE VISEU Lda.



ANGULAR - Aluminios, Lda.

COR 80 INDUSTRIAL

Perfiles a escala

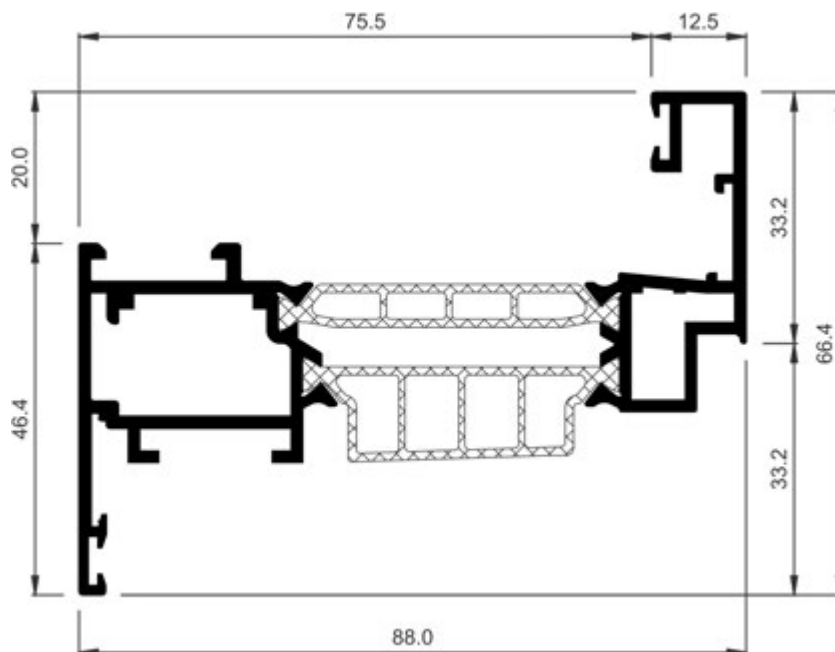

COR-7720	
Descripción Description	Hoja ventana apertura interior inside opening window sash
Peso Weight (g/m)	1855,5
Superficie Surface (dm ² /m)	60,06
I _x (cm ⁴)	9,49
I _y (cm ⁴)	54,61
Escuadra principal Main cleat	347922
Troquel Die	337999
	347799
Escuadra secundaria Secondary cleat	327920
Escuadra alineamiento Alignment cleat	296838
	920135

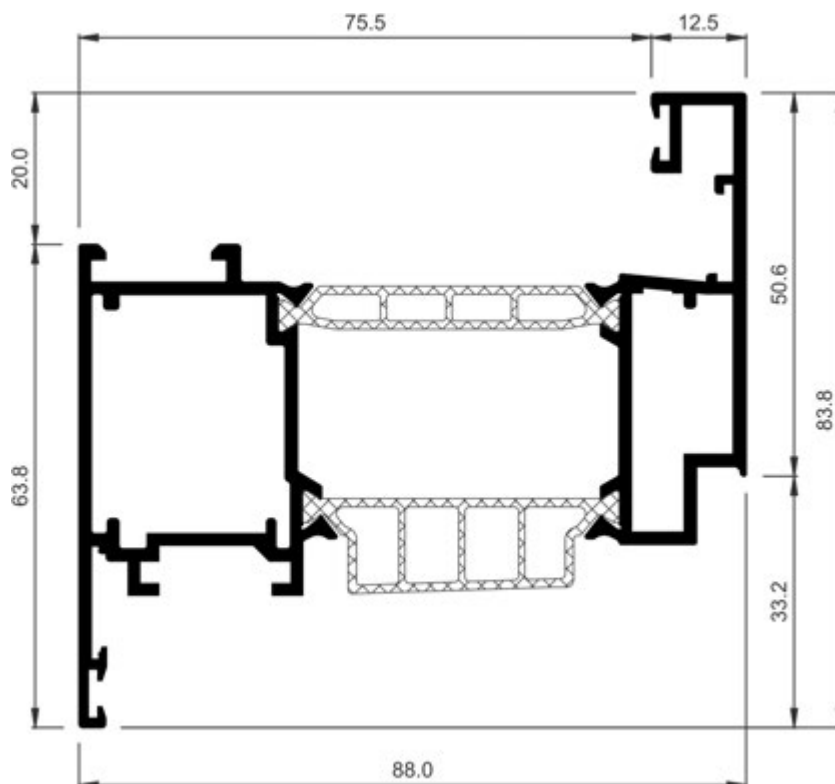

COR-7721	
Descripción Description	Hoja balconera apertura interior inside opening balcony sash
Peso Weight (g/m)	2198,4
Superficie Surface (dm ² /m)	75,21
I _x (cm ⁴)	22,66
I _y (cm ⁴)	69,67
Escuadra principal Main cleat	247231
Troquel Die	337999
	347799
Escuadra secundaria Secondary cleat	327924
Escuadra alineamiento Alignment cleat	296838
	920135



ALUMINIOS IBÉRICA, S.A.



PALA-MIGUEL S REIS, Lda.



ALUMINIOS DE VISEU Lda.



ANGULAR - Aluminios, Lda.

COR 80 INDUSTRIAL

Perfiles a escala

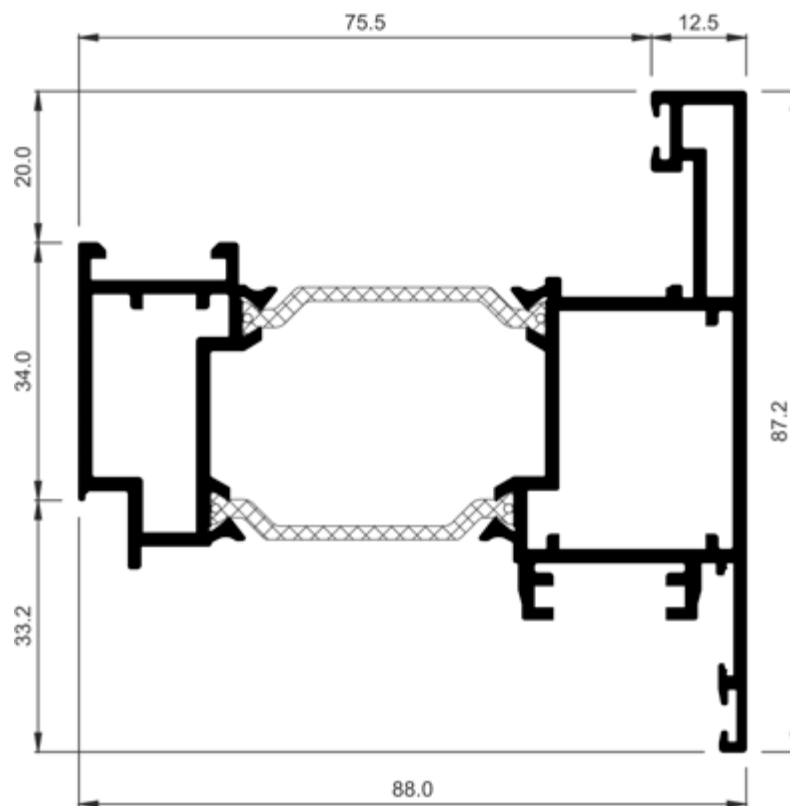

COR-7722	
Descripción Description	Hoja ventana apertura exterior Outer opening window sash
Peso Weight (g/m)	2238,6
Superficie Surface (dm ² /m)	83,82
Ix (cm ⁴)	28,67
Iy (cm ⁴)	73,42
Escuadra principal Main cleat	247231
Troquel Die	337999
Escuadra secundaria Secondary cleat	327924
Escuadra alineamiento Alignment cleat	287310
	920135

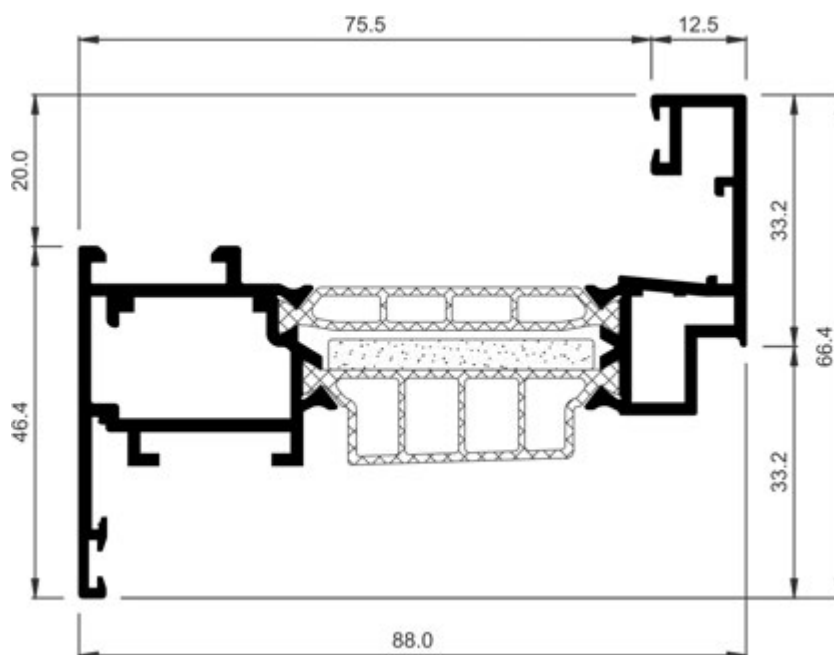

COR-7723	
Descripción Description	Hoja ventana apertura interior HI HI inside opening window sash
Peso Weight (g/m)	1855,5
Superficie Surface (dm ² /m)	60,06
Ix (cm ⁴)	9,49
Iy (cm ⁴)	54,61
Escuadra principal Main cleat	347922
Troquel Die	337999
	347799
Escuadra secundaria Secondary cleat	327920
Escuadra alineamiento Alignment cleat	296838
	920135



ALUMINIOS IBÉRICA, S.A.



PALA-MIGUEL S REIS, LDA.



ALUMINIOS DE VISEULDA



ANGULAR - Aluminios, Lda.

COR 80 INDUSTRIAL

Perfiles a escala

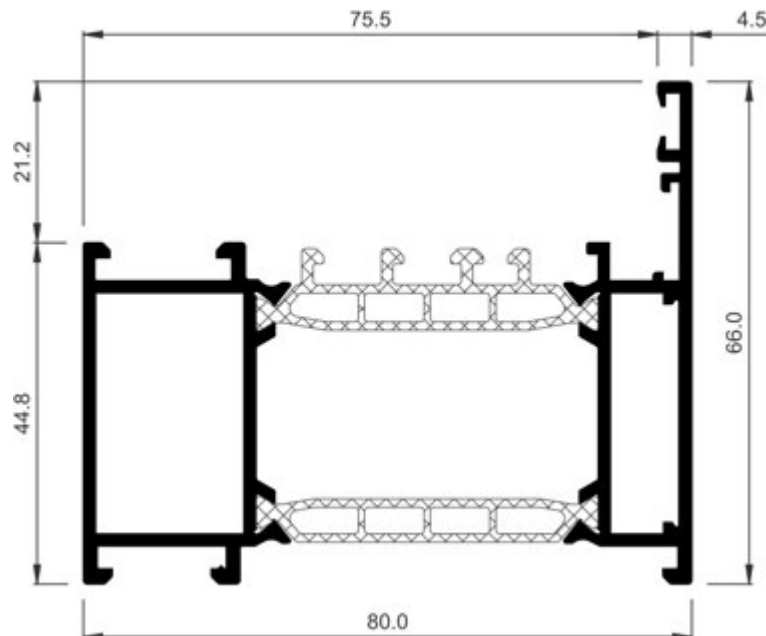

COR-7735	
Descripción Description	Marco balconera apertura interior Inside opening balcony frame
Peso Weight (g/m)	1939,2
Superficie Surface (dm ² /m)	61,19
I_x (cm ⁴)	14,27
I_y (cm ⁴)	50,47
Escuadra principal Main cleat	247231
Troquel Die	337999
	347799
Escuadra secundaria Secondary cleat	327924
Escuadra alineamiento Alignment cleat	296838

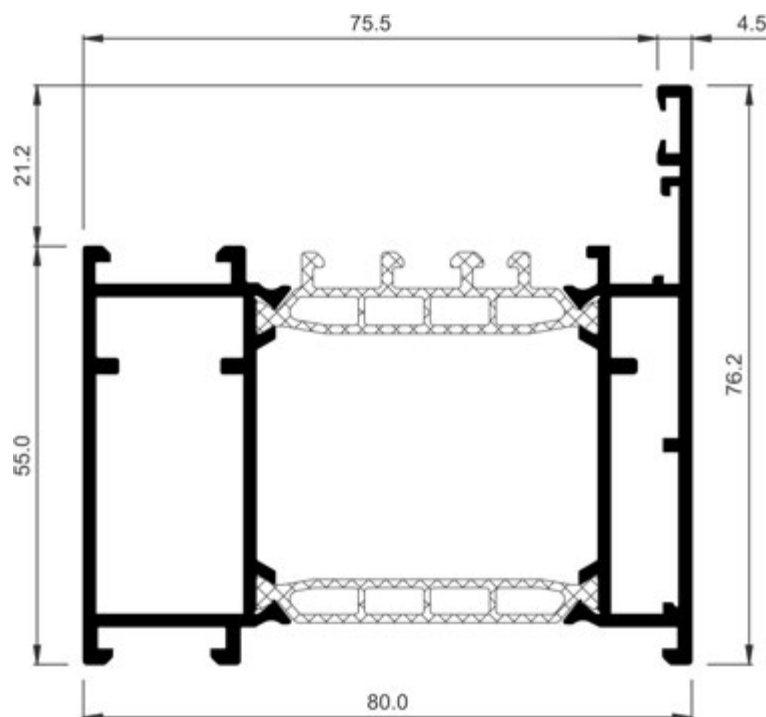

COR-7736	
Descripción Description	Marco balconera embutir recogedor Cram balcony frame
Peso Weight (g/m)	2171,4
Superficie Surface (dm ² /m)	71,38
I_x (cm ⁴)	23,17
I_y (cm ⁴)	59,37
Escuadra principal Main cleat	247231
Troquel Die	337999
	347799
Escuadra secundaria Secondary cleat	327924
Escuadra alineamiento Alignment cleat	296838



ALUMINIOS IBÉRICA, S.A.



PALA-MIGUEL S REIS, Lda.



ALUMINIOS DE VISEU Lda.



ANGULAR - Aluminios, Lda.

COR 80 INDUSTRIAL

Perfiles a escala

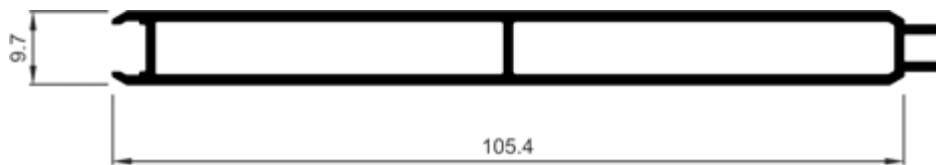

COR-2366	
Descripción Description	Lama contra de ventana Window louvre
Peso Weight (g/m)	796,5
Superficie Surface (dm²/m)	47,49
Ix (cm⁴)	0,48
Iy (cm⁴)	30,48

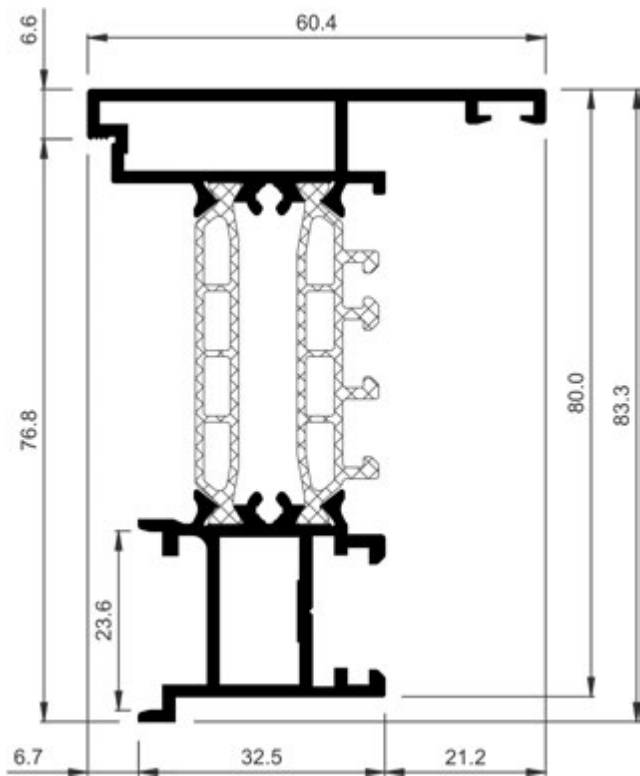

COR-7740	
Descripción Description	Inversor apertura interior Inside opening inverter
Peso Weight (g/m)	1798,8
Superficie Surface (dm²/m)	57,51
Ix (cm⁴)	43,33
Iy (cm⁴)	7,71
Tapas Covers	347740
Tornillería Screws	813922

COR 80 INDUSTRIAL Perfiles a escala

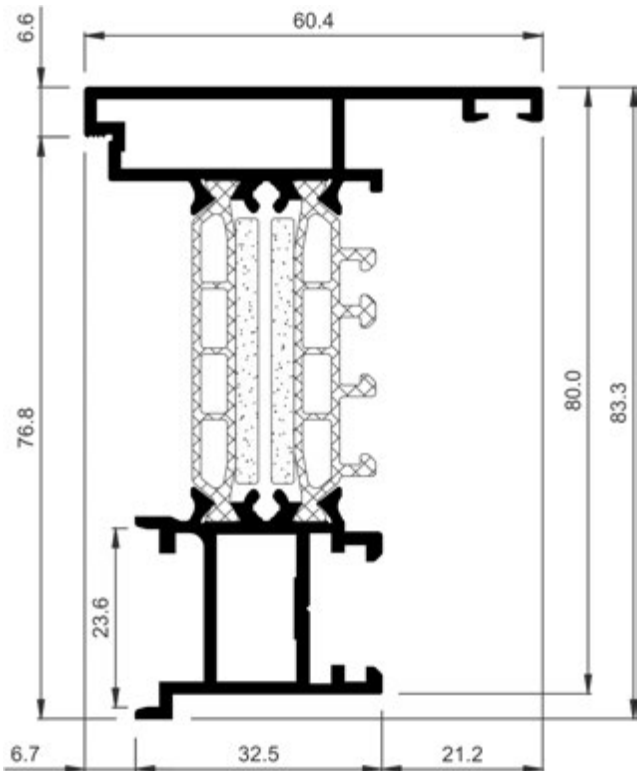

COR-7741	
Descripción Description	Inversor apertura interior HI HI inside opening inverter
Peso Weight (g/m)	1798,8
Superficie Surface (dm²/m)	57,51
Ix (cm⁴)	43,33
Iy (cm⁴)	7,71
Tapas Covers	347740
Tornillería Screws	813922

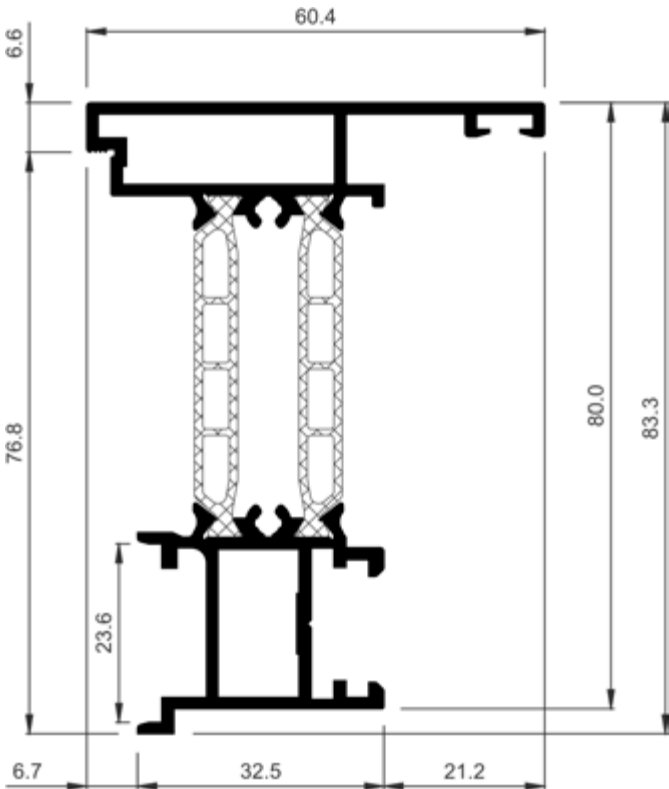

COR-7742	
Descripción Description	Inversor apertura exterior Outer opening inverter
Peso Weight (g/m)	1798,2
Superficie Surface (dm²/m)	57,51
Ix (cm⁴)	43,33
Iy (cm⁴)	7,71
Tapas Covers	347740
Tornillería Screws	813922



ALUMINIOS IBÉRICA, S.A.



PALA-MIGUEL S REIS, Lda.



ALUMINIOS DE VISEU Lda.



ANGULAR - Aluminios, Lda.

COR 80 INDUSTRIAL

Perfiles a escala

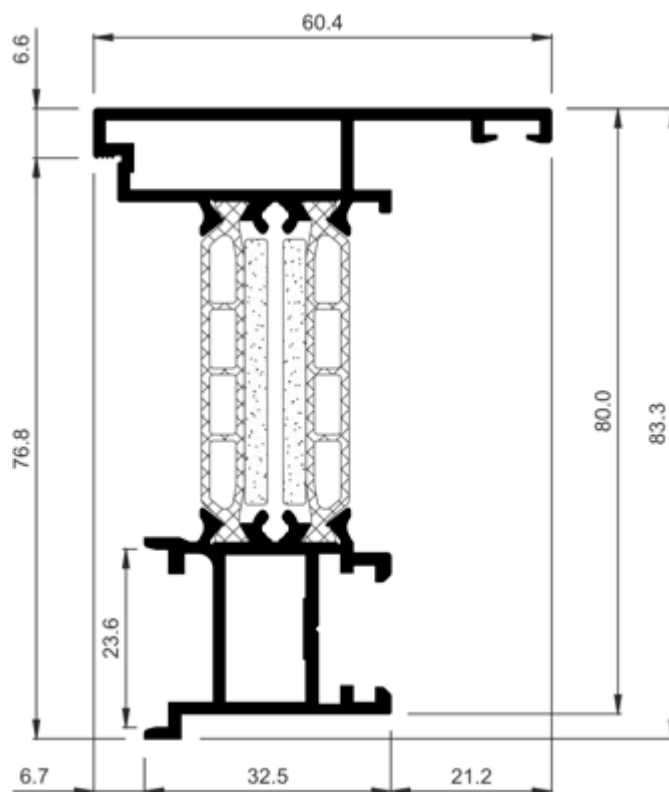

COR-7743	
Descripción Description	Inversor apertura exterior HI HI outer opening inverter
Peso Weight (g/m)	1798,2
Superficie Surface (dm ² /m)	57,51
I_x (cm ⁴)	43,33
I_y (cm ⁴)	7,71
Tapas Covers	347740
Tornillería Screws	813922



COR-2013	
Descripción Description	Junquillo curvo grapa 26 mm Curve glazing bead clip 26 mm
Peso Weight (g/m)	280,8
Superficie Surface (dm ² /m)	15,71
I_x (cm ⁴)	0,42
I_y (cm ⁴)	0,74
Varios Various	252012

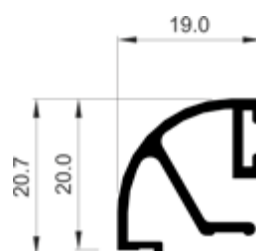

COR-2014	
Descripción Description	Junquillo curvo grapa 19 mm Curve glazing bead clip 19 mm
Peso Weight (g/m)	256,5
Superficie Surface (dm ² /m)	14,31
I_x (cm ⁴)	0,35
I_y (cm ⁴)	0,35
Varios Various	252012



ALUMINIOS IBÉRICA, S.A.



PALA-MIGUEL S REIS, Lda.



ALUMINIOS DE VISEU Lda.



ANGULAR - Aluminios, Lda.

COR 80 INDUSTRIAL

Perfiles a escala

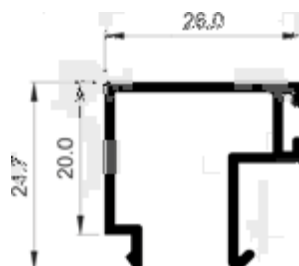

COR-2015	
Descripción Description	Junquillo clip recto de 26 mm Straight glazing bead clip 26 mm
Peso Weight (g/m)	321,3
Superficie Surface (dm ² /m)	18,04
I_x (cm ⁴)	0,75
I_y (cm ⁴)	0,97

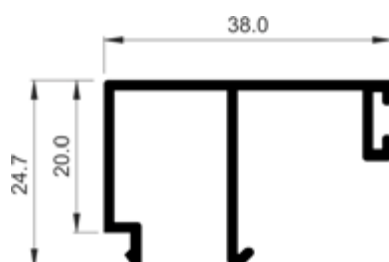

COR-2016	
Descripción Description	Junquillo clip recto de 38 mm Straight glazing bead clip 38 mm
Peso Weight (g/m)	375,3
Superficie Surface (dm ² /m)	21,15
I_x (cm ⁴)	0,87
I_y (cm ⁴)	2,18

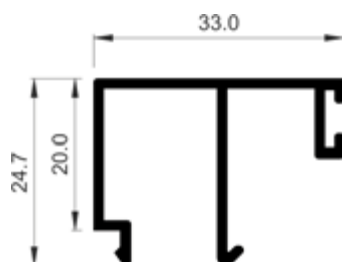

COR-2017	
Descripción Description	Junquillo clip recto de 33 mm Straight glazing bead clip 33 mm
Peso Weight (g/m)	356,4
Superficie Surface (dm ² /m)	20,15
I_x (cm ⁴)	0,83
I_y (cm ⁴)	1,56

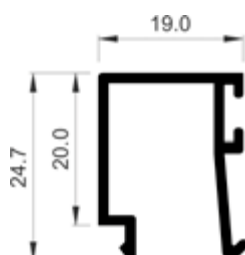

COR-2018	
Descripción Description	Junquillo clip recto de 19 mm Straight glazing bead clip 19 mm
Peso Weight (g/m)	275,4
Superficie Surface (dm ² /m)	15,52
I_x (cm ⁴)	0,67
I_y (cm ⁴)	0,53

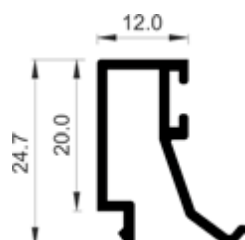

COR-2019	
Descripción Description	Junquillo clip recto de 12 mm Straight glazing bead clip 12 mm
Peso Weight (g/m)	261,9
Superficie Surface (dm ² /m)	14,77
I_x (cm ⁴)	0,61
I_y (cm ⁴)	0,27



ALUMINIOS IBÉRICA, S.A.



PALA-MIGUEL S REIS, LDA.



ALUMINIOS DE VISEU LDA.



ANGULAR - Aluminios, Lda.

COR 80 INDUSTRIAL

Perfiles a escala

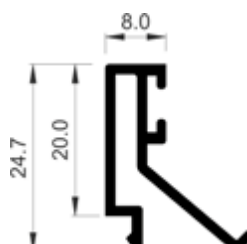
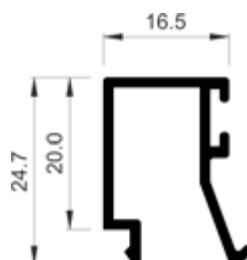
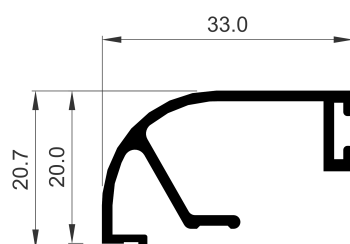
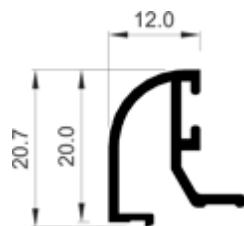

COR-2021	
Descripción Description	Junquillo curvo grapa 12 mm Curve glazing bead clip 12 mm
Peso Weight (g/m)	216
Superficie Surface (dm ² /m)	12,55
I_x (cm ⁴)	0,31
I_y (cm ⁴)	0,18
Varios Various	252012

COR-2023	
Descripción Description	Junquillo recto de 2,5 mm 2,5 Straight glazing bead clip
Peso Weight (g/m)	151,2
Superficie Surface (dm ² /m)	8,71
I_x (cm ⁴)	0,32
I_y (cm ⁴)	0,21

COR-2038	
Descripción Description	Junquillo curvo grapa 33 mm Curve glazing bead clip 33 mm
Peso Weight (g/m)	307,8
Superficie Surface (dm ² /m)	17,32
I_x (cm ⁴)	0,47
I_y (cm ⁴)	1,37
Varios Various	252012

COR-2065	
Descripción Description	Junquillo clip recto de 16.50 mm Straight glazing bead clip 16,50 mm
Peso Weight (g/m)	270
Superficie Surface (dm ² /m)	15,13
I_x (cm ⁴)	0,65
I_y (cm ⁴)	0,41

COR-2093	
Descripción Description	Junquillo clip recto de 8 mm Straight glazing bead clip 8 mm
Peso Weight (g/m)	256,5
Superficie Surface (dm ² /m)	14,51
I_x (cm ⁴)	0,56
I_y (cm ⁴)	0,23



ALUMINIOS IBÉRICA, S.A.



PALA-MIGUEL S REIS, Lda.



ALUMINIOS DE VISEULDA



ANGULAR - Alumínios, Lda.

COR 80 INDUSTRIAL

Perfiles a escala

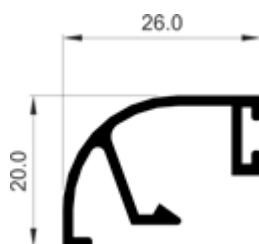

COR-2113	
Descripción Description	Junquillo curvo grapa plástica 26 mm Curve glazing bead plastic clip 26 mm
Peso Weight (g/m)	272,7
Superficie Surface (dm ² /m)	15
I_x (cm ⁴)	0,36
I_y (cm ⁴)	0,72
Varios Various	212001

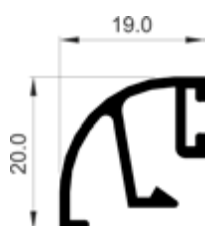

COR-2114	
Descripción Description	Junquillo curvo grapa plástica 19 mm Curve glazing bead plastic clip 19 mm
Peso Weight (g/m)	251,1
Superficie Surface (dm ² /m)	13,74
I_x (cm ⁴)	0,31
I_y (cm ⁴)	0,31
Varios Various	212001

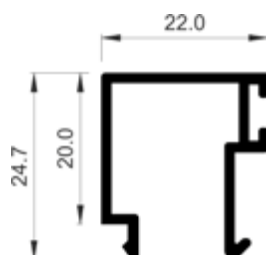

COR-2117	
Descripción Description	Junquillo clip recto de 22 mm Straight glazing bead clip 22 mm
Peso Weight (g/m)	294,3
Superficie Surface (dm ² /m)	16,44
I_x (cm ⁴)	0,7
I_y (cm ⁴)	0,69

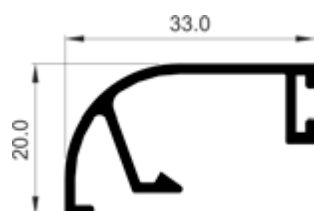

COR-2138	
Descripción Description	Junquillo curvo grapa plástica 33 mm Curve glazing bead plastic clip 33 mm
Peso Weight (g/m)	294,3
Superficie Surface (dm ² /m)	16,15
I_x (cm ⁴)	0,41
I_y (cm ⁴)	1,35
Varios Various	212001

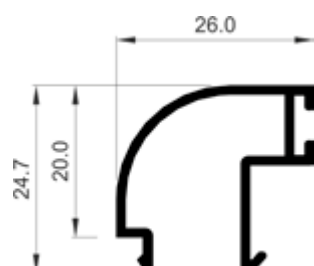

COR-2313	
Descripción Description	Junquillo curvo 26 mm Curve glazing bead 26 mm
Peso Weight (g/m)	278,1
Superficie Surface (dm ² /m)	16,99
I_x (cm ⁴)	0,61
I_y (cm ⁴)	0,76



ALUMINIOS IBÉRICA, S.A.



PALA-MIGUEL S REIS, Lda.



ALUMINIOS DE VISEU Lda.



ANGULAR - Aluminios, Lda.

COR 80 INDUSTRIAL

Perfiles a escala

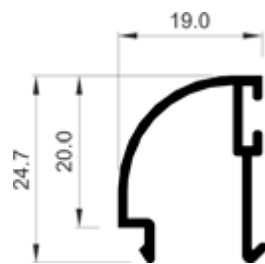

COR-2314	
Descripción Description	Junquillo curvo 19 mm Curve glazing bead 19 mm
Peso Weight (g/m)	237,6
Superficie Surface (dm ² /m)	14,5
Ix (cm⁴)	0,52
Iy (cm⁴)	0,41

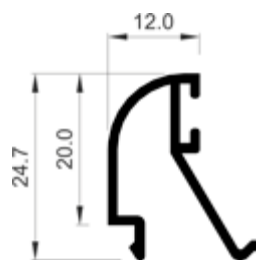

COR-2321	
Descripción Description	Junquillo curvo 12 mm Curve glazing bead 12 mm
Peso Weight (g/m)	228,5
Superficie Surface (dm ² /m)	13,98
Ix (cm⁴)	0,49
Iy (cm⁴)	0,24

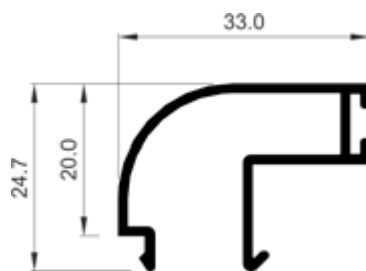

COR-2338	
Descripción Description	Junquillo curvo 33 mm Curve glazing bead 33 mm
Peso Weight (g/m)	326,7
Superficie Surface (dm ² /m)	19,91
Ix (cm⁴)	0,68
Iy (cm⁴)	1,35



603003	
Descripción Description	Pletina de 30x3 mm Plate 30x3mm
Peso Weight (g/m)	243
Superficie Surface (dm ² /m)	6,6
Ix (cm⁴)	-
Iy (cm⁴)	-



COR-2030	
Descripción Description	Pletina falleba aluminio Aluminium espagnolette
Peso Weight (g/m)	143,1
Superficie Surface (dm ² /m)	5
Ix (cm⁴)	0,01
Iy (cm⁴)	0,16



ALUMINIOS IBÉRICA, S.A.



PALA-MIGUEL S REIS, LDA.



ALUMINIOS DE VISEULDA.



ANGULAR - Aluminios, Lda.

COR 80 INDUSTRIAL

Perfiles a escala

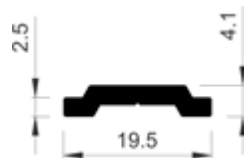

COR-2130	
Descripción Description	Pletina falleba poliamida Polyamide espagnolette
Peso Weight (g/m)	-
Superficie Surface (dm ² /m)	-
I_x (cm ⁴)	-
I_y (cm ⁴)	-

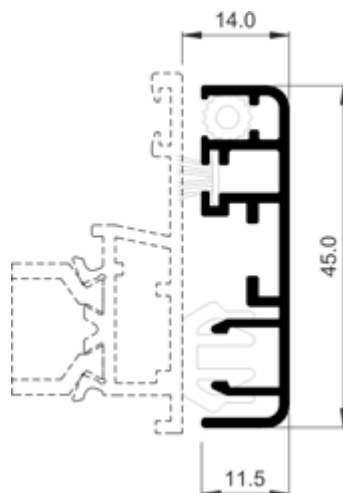

COR-2170	
Descripción Description	Mosquitera fija Fixed insect screen
Peso Weight (g/m)	405
Superficie Surface (dm ² /m)	24,41
I_x (cm ⁴)	3,02
I_y (cm ⁴)	0,19
Varios Various	272170
Juntas Gaskets	272100 950040
Escuadra alineamiento Alignment cleat	245054
Observaciones Observations	Telas mosquitera 272125/26/27/28 Mosquito net 272125/26/27/28

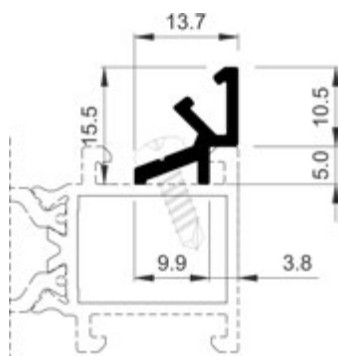

COR-2714	
Descripción Description	Acople esquinero regulable Adjustable corner attachment
Peso Weight (g/m)	162
Superficie Surface (dm ² /m)	7,34
I_x (cm ⁴)	0,1
I_y (cm ⁴)	0,08
Observaciones Observations	Tornillo Ø3.5 mm DIN7504N. Ø3.5 mm DIN7504Nscrew.

COR 80 INDUSTRIAL Perfiles a escala

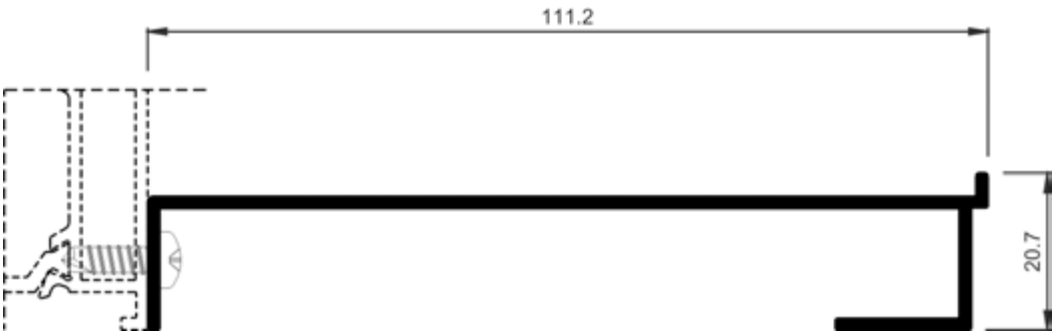

COR-2778	
Descripción Description	Peana de 110 mm 110 mm stand
Peso Weight (g/m)	696,6
Superficie Surface (dm²/m)	32,73
Ix (cm⁴)	0,89
Iy (cm⁴)	38,59
Tornillería Screws	853913

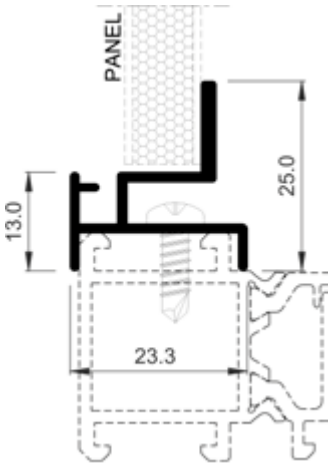

COR-2890	
Descripción Description	Complemento tapa registro (para panel) Register cover complement (for pannel)
Peso Weight (g/m)	264,6
Superficie Surface (dm²/m)	14,57
Ix (cm⁴)	0,36
Iy (cm⁴)	0,53
Juntas Gaskets	262810
Tornillería Screws	853913

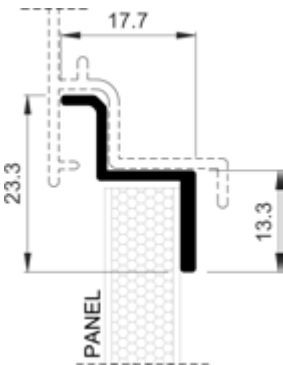

COR-2891	
Descripción Description	Asiento tapa registro Register cover seat
Peso Weight (g/m)	159,3
Superficie Surface (dm²/m)	7,92
Ix (cm⁴)	0,23
Iy (cm⁴)	0,19
Juntas Gaskets	262810



COR 80 INDUSTRIAL

Perfiles a escala

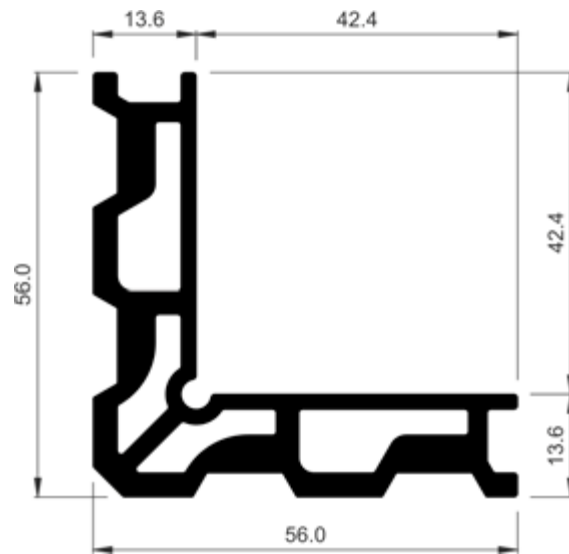

COR-3160	
Descripción Description	Perfil para escuadra de ensamblar de 13,60 mm Profile for assembly cleat - 13.60 mm
Peso Weight (g/m)	1884,6
Superficie Surface (dm ² /m)	45,94
I_x (cm ⁴)	18,6
I_y (cm ⁴)	18,6

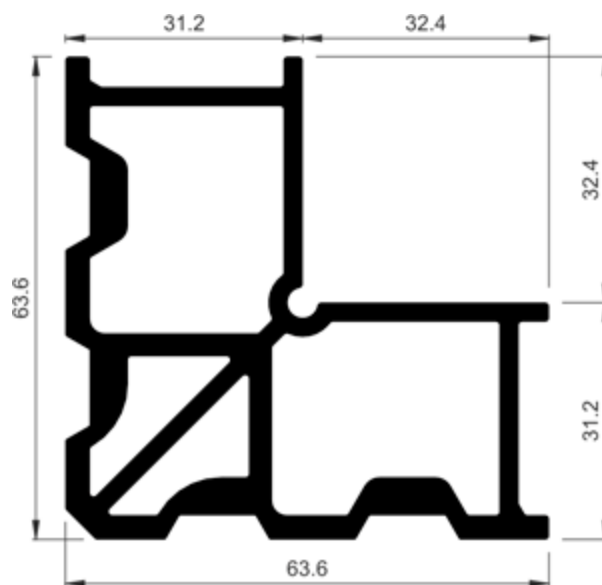

COR-3161	
Descripción Description	Perfil para escuadra de ensamblar de 31,20 mm Profile for assembly cleat - 31.20 mm
Peso Weight (g/m)	2651,4
Superficie Surface (dm ² /m)	62,87
I_x (cm ⁴)	34,52
I_y (cm ⁴)	34,52

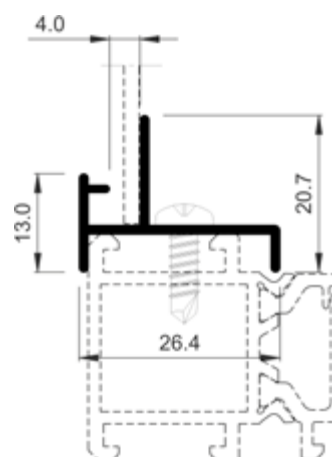

COR-5057	
Descripción Description	Complemento tapa registro (para chapa) Register cover complement (for plate)
Peso Weight (g/m)	191,7
Superficie Surface (dm ² /m)	12,06
I_x (cm ⁴)	0,14
I_y (cm ⁴)	0,5
Juntas Gaskets	262810
Tornillería Screws	853913



ALUMINIOS IBÉRICA, S.A.



PALA-MIGUEL S REIS, Lda.



ALUMINIOS DE VISEU Lda.



ANGULAR - Aluminios, Lda.

COR 80 INDUSTRIAL

Perfiles a escala

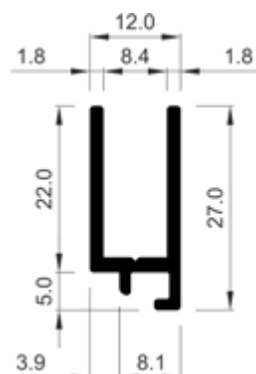

COR-7997	
Descripción Description	Acople para junta de dilatación Expansion gasket attachment
Peso Weight (g/m)	297
Superficie Surface (dm ² /m)	12,56
I_x (cm ⁴)	0,63
I_y (cm ⁴)	0,24
Juntas Gaskets	347901
Tornillería Screws	813919

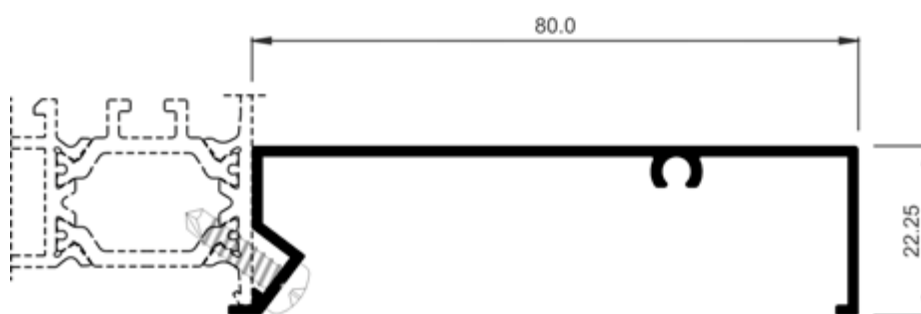

COR-2724	
Descripción Description	Cubre premarco 80 mm Pre-frame cover 80 mm
Peso Weight (g/m)	537,3
Superficie Surface (dm ² /m)	28,05
I_x (cm ⁴)	0,99
I_y (cm ⁴)	17,3
Observaciones Observations	Tornillo Ø3.9 mm DIN7504N-A2 Ø3.9 mm DIN7504N-A2 screw

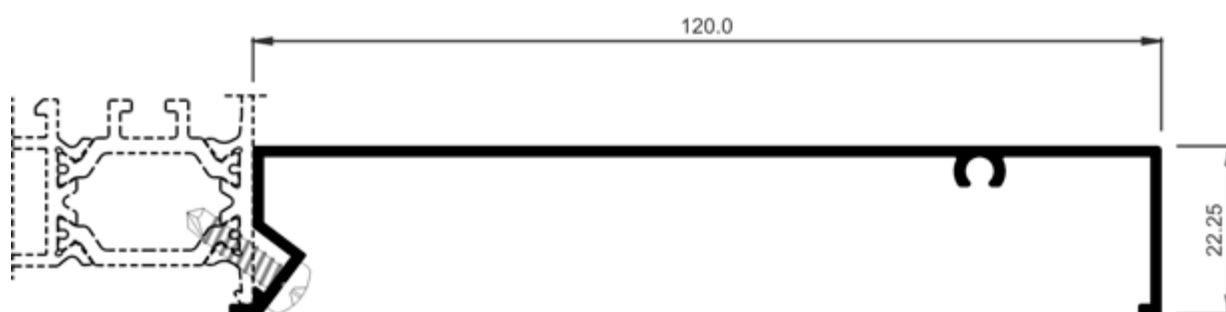

COR-2726	
Descripción Description	Cubre premarco 120 mm Pre-frame cover 120 mm
Peso Weight (g/m)	688,5
Superficie Surface (dm ² /m)	36,05
I_x (cm ⁴)	1,09
I_y (cm ⁴)	47,2
Observaciones Observations	Tornillo Ø3.9 mm DIN7504N-A2 Ø3.9 mm DIN7504N-A2 screw



ALUMINIOS IBÉRICA, S.A.



PALA-MIGUEL S REIS, Lda.



ALUMINIOS DE VISEULDA



ANGULAR - Aluminios, Lda.

COR 80 INDUSTRIAL

Perfiles a escala

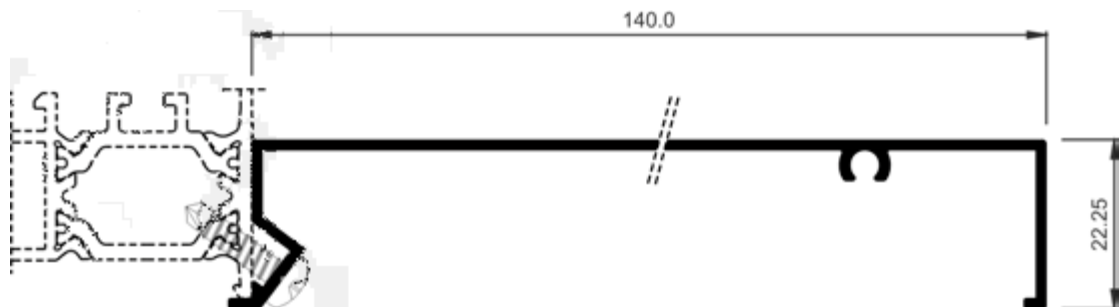

COR-2727

Descripción Description	Cubre premarco 140 mm Pre-frame cover 140 mm
Peso Weight (g/m)	764,1
Superficie Surface (dm ² /m)	40,05
I_x (cm ⁴)	1,13
I_y (cm ⁴)	69,51
Observaciones Observations	Tornillo Ø3.9 mm DIN7504N-A2 Ø3.9 mm DIN7504N-A2 screw

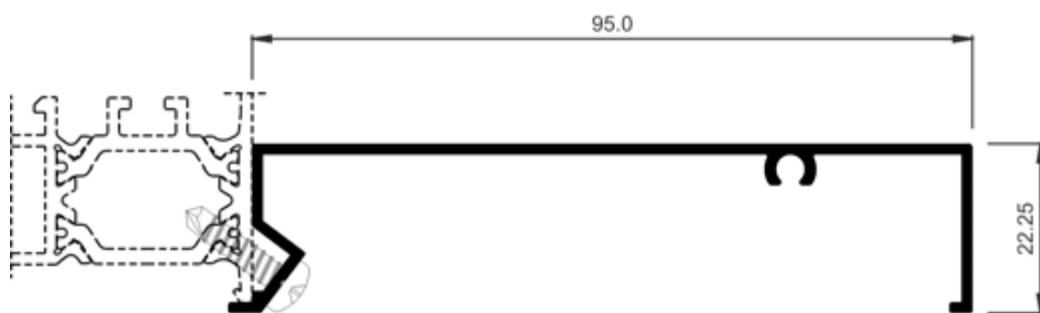

COR-2790

Descripción Description	Cubre premarco 95 mm Pre-frame cover 95 mm
Peso Weight (g/m)	591,3
Superficie Surface (dm ² /m)	30,96
I_x (cm ⁴)	1,02
I_y (cm ⁴)	26,25
Observaciones Observations	Tornillo Ø3.9 mm DIN7504N-A2 Ø3.9 mm DIN7504N-A2 screw

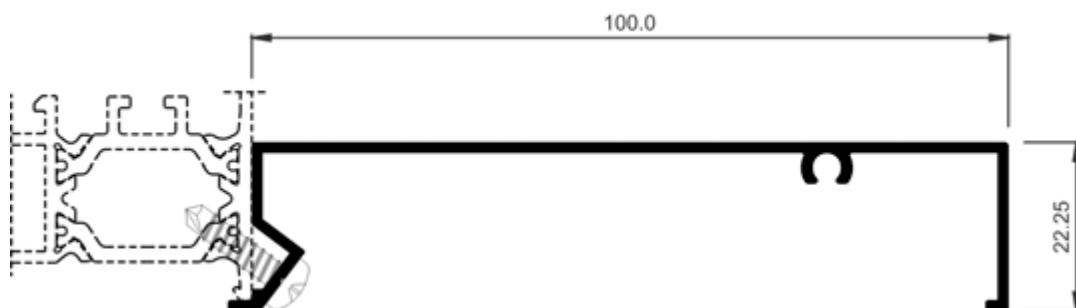

COR-2791

Descripción Description	Cubre premarco 100 mm Pre-frame cover 100 mm
Peso Weight (g/m)	610,2
Superficie Surface (dm ² /m)	31,96
I_x (cm ⁴)	1,03
I_y (cm ⁴)	29,81
Observaciones Observations	Tornillo Ø3.9 mm DIN7504N-A2 Ø3.9 mm DIN7504N-A2 screw



ALUMINIOS IBÉRICA, S.A.



PALA-MIGUEL S REIS, Lda.



ALUMINIOS DE VISEULDA



ANGULAR - Aluminios, Lda.

COR 80 INDUSTRIAL

Perfiles a escala

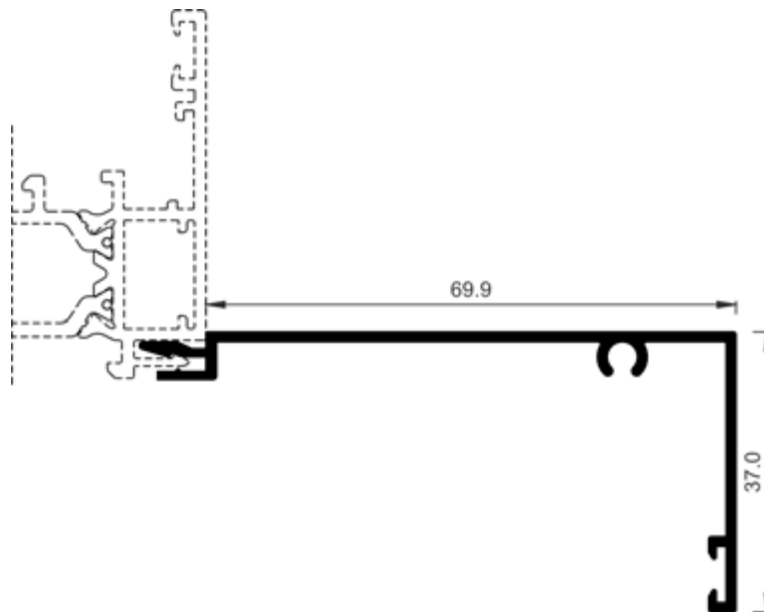

COR-2815	
Descripción Description	Tapé recto de 70 mm Straight cap of 70 mm
Peso Weight (g/m)	499,5
Superficie Surface (dm ² /m)	28,54
I _x (cm ⁴)	2,16
I _y (cm ⁴)	13,69

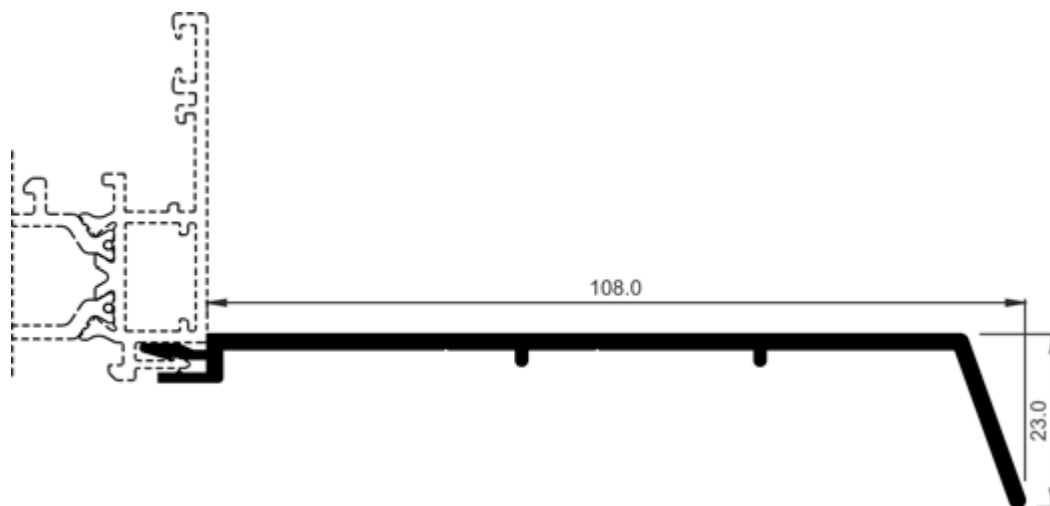

COR-2816	
Descripción Description	Tapé achaflanado de 108 mm Bevelled cap of 108 mm
Peso Weight (g/m)	753,3
Superficie Surface (dm ² /m)	29,58
I _x (cm ⁴)	0,64
I _y (cm ⁴)	37,19



ALUMINIOS IBÉRICA, S.A.



PALA-MIGUEL S REIS, Lda.



ALUMINIOS DE VISEULDA



ANGULAR - Aluminios, Lda.

COR 80 INDUSTRIAL

Perfiles a escala

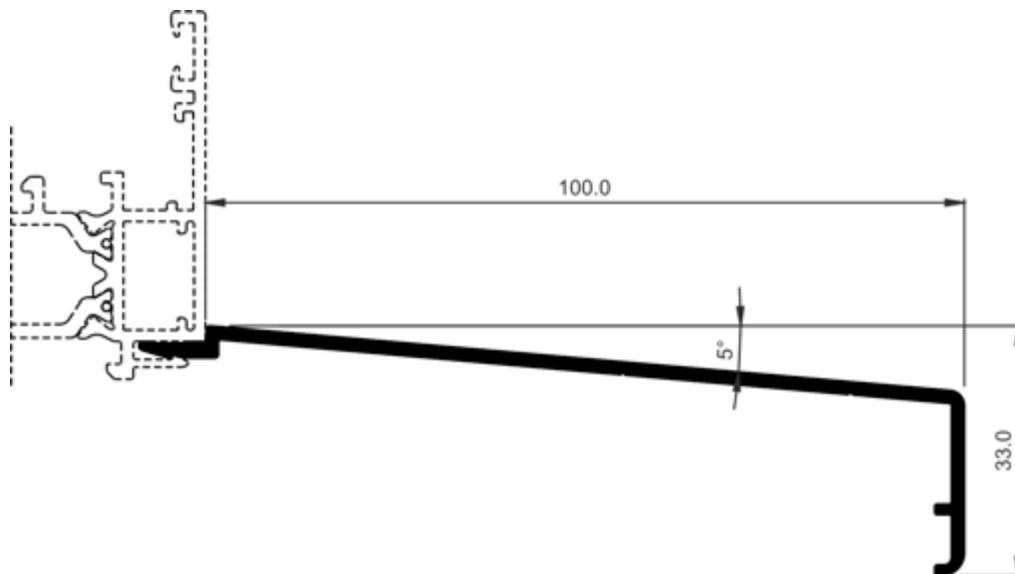

COR-2817

Descripción Description	Alargadera con enganche de 100 mm Extension with attachment of 100 mm
Peso Weight (g/m)	626,4
Superficie Surface (dm ² /m)	27,69
Ix (cm ⁴)	1,34
Iy (cm ⁴)	29,29

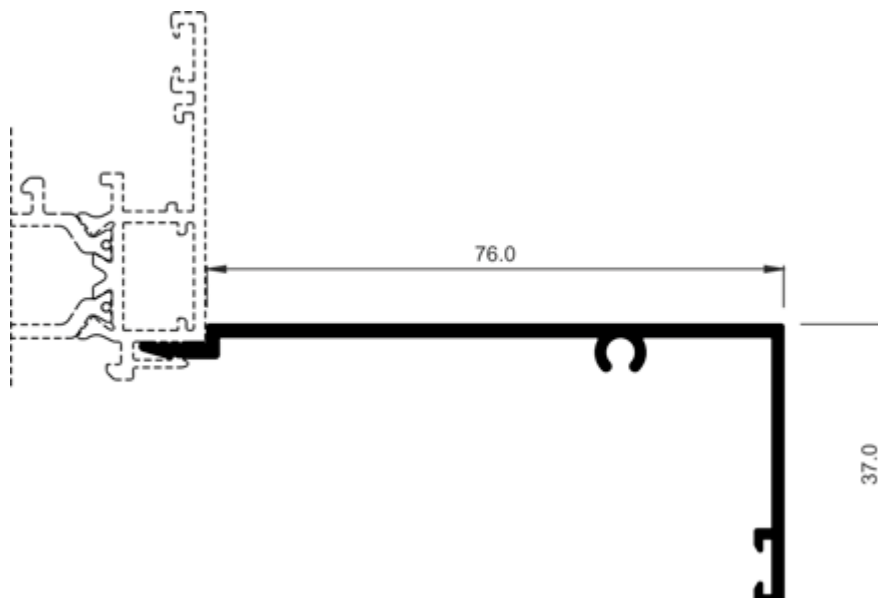

COR-2824

Descripción Description	Tapé recto de 75 mm Straight cap of 75 mm
Peso Weight (g/m)	604,8
Superficie Surface (dm ² /m)	27,93
Ix (cm ⁴)	2,46
Iy (cm ⁴)	17,14



ALUMINIOS IBÉRICA, S.A.



PALA-MIGUEL S REIS, Lda.



ALUMINIOS DE VISEULDA



ANGULAR - Aluminios, Lda.

COR 80 INDUSTRIAL

Perfiles a escala

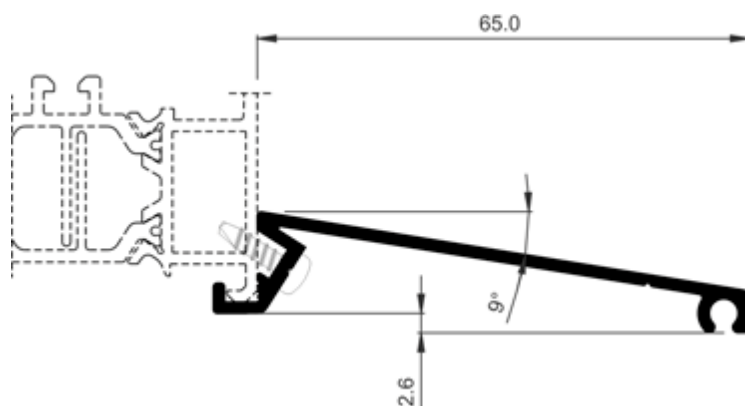

COR-2870	
Descripción Description	Alargadera de 65 mm 65 mm Cill
Peso Weight (g/m)	415,8
Superficie Surface (dm ² /m)	19,92
Ix (cm ⁴)	0,23
Iy (cm ⁴)	8,45
Observaciones Observations	Tornillo Ø3.9 mm DIN7504N-A2 Ø3.9 mm DIN7504N-A2 screw

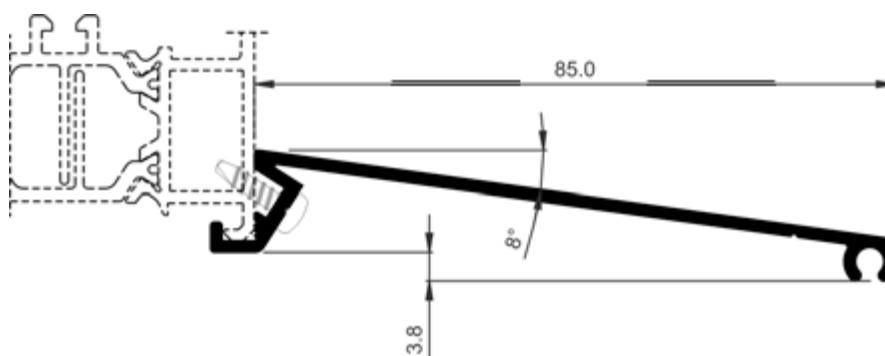

COR-2872	
Descripción Description	Alargadera de 85 mm 85 mm Cill
Peso Weight (g/m)	496,8
Superficie Surface (dm ² /m)	23,92
Ix (cm ⁴)	0,3
Iy (cm ⁴)	16,49
Observaciones Observations	Tornillo Ø3.9 mm DIN7504N-A2 Ø3.9 mm DIN7504N-A2 screw

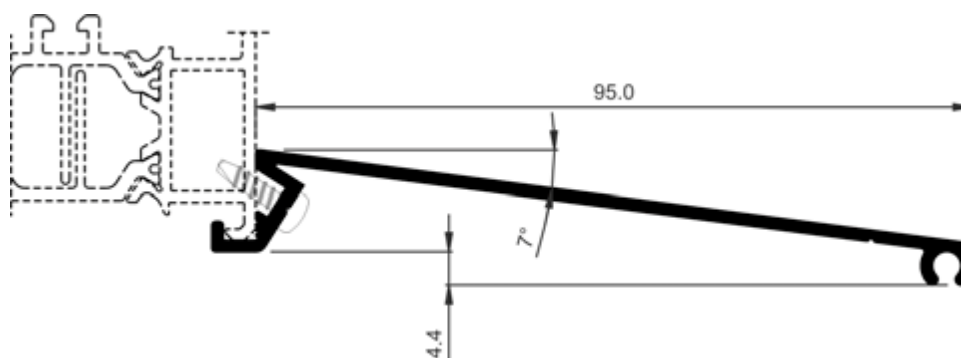

COR-2873	
Descripción Description	Alargadera de 95 mm 95 mm Cill
Peso Weight (g/m)	537,3
Superficie Surface (dm ² /m)	25,92
Ix (cm ⁴)	0,35
Iy (cm ⁴)	21,83
Observaciones Observations	Tornillo Ø3.9 mm DIN7504N-A2 Ø3.9 mm DIN7504N-A2 screw



ALUMÍNIO IBÉRICA, S.A.



PALA-MIGUEL S REIS, Lda.



ALUMÍNIO DE VISEU Lda.



ANGULAR - Aluminios, Lda.

COR 80 INDUSTRIAL

Perfiles a escala

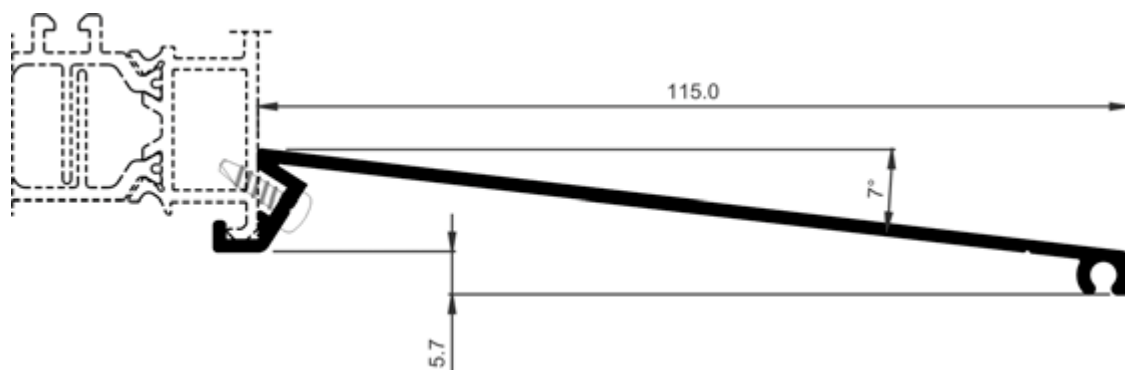

COR-2875	
Descripción Description	Alargadera de 115 mm 115 mm Cill
Peso Weight (g/m)	618,3
Superficie Surface (dm ² /m)	29,93
Ix (cm ⁴)	0,45
Iy (cm ⁴)	35,54
Observaciones Observations	Tornillo Ø3.9 mm DIN7504N-A2 Ø3.9 mm DIN7504N-A2 screw

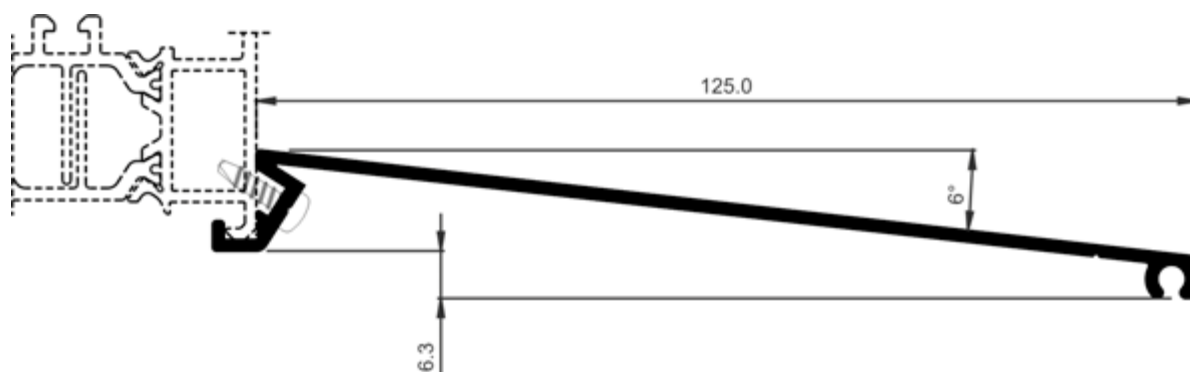

COR-2876	
Descripción Description	Alargadera de 125 mm 125 mm Cill
Peso Weight (g/m)	656,1
Superficie Surface (dm ² /m)	31,93
Ix (cm ⁴)	0,51
Iy (cm ⁴)	44,06
Observaciones Observations	Tornillo Ø3.9 mm DIN7504N-A2 Ø3.9 mm DIN7504N-A2 screw

COR 80 INDUSTRIAL

Perfiles a escala

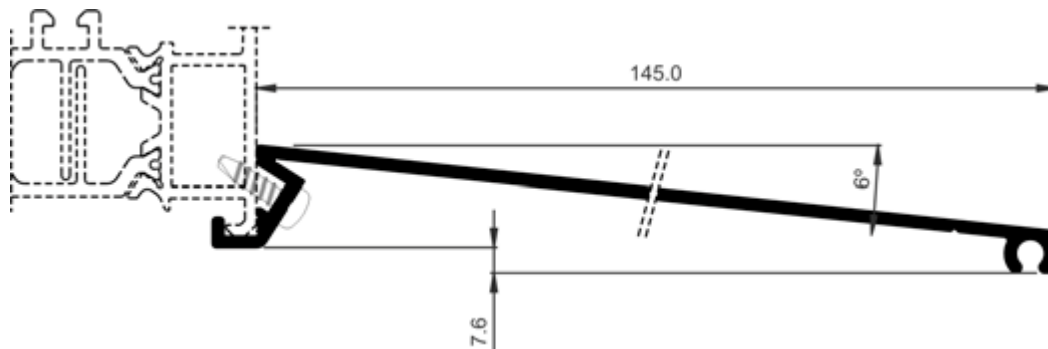

COR-2878

Descripción Description	Alargadera de 145 mm 145 mm Cill
Peso Weight (g/m)	737,1
Superficie Surface (dm ² /m)	35,94
Ix (cm ⁴)	0,64
Iy (cm ⁴)	64,8
Observaciones Observations	Tornillo Ø3.9 mm DIN7504N-A2 Ø3.9 mm DIN7504N-A2 screw

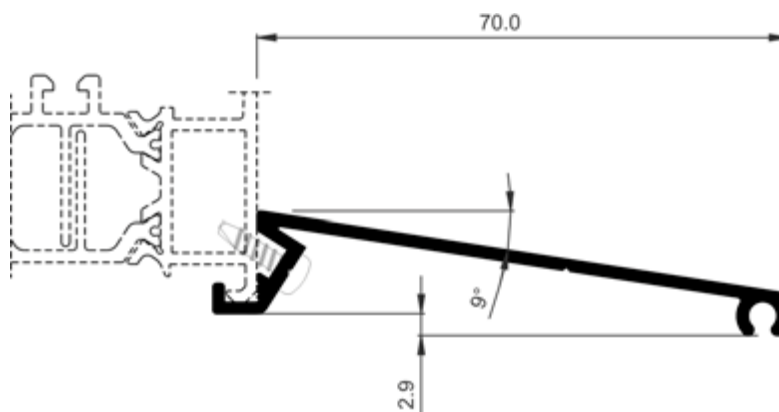

COR-2888

Descripción Description	Alargadera de 70 mm 70 mm Cill
Peso Weight (g/m)	437,4
Superficie Surface (dm ² /m)	20,92
Ix (cm ⁴)	0,25
Iy (cm ⁴)	10,17
Observaciones Observations	Tornillo Ø3.9 mm DIN7504N-A2 Ø3.9 mm DIN7504N-A2 screw

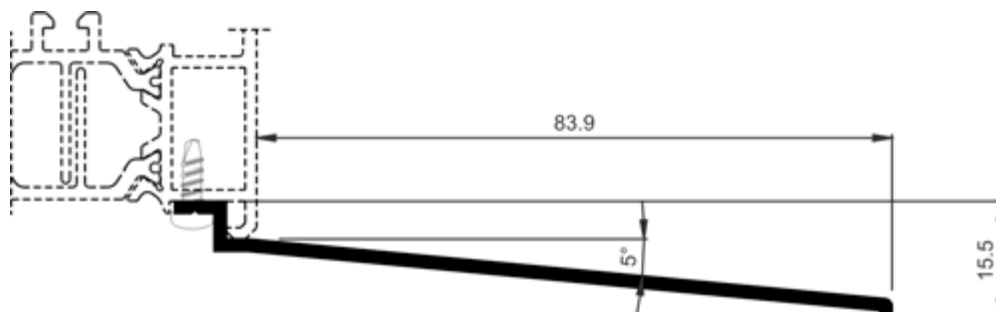

COR-7055

Descripción Description	Alargadera de 85 mm 85 mm Cill
Peso Weight (g/m)	434,7
Superficie Surface (dm ² /m)	20,54
Ix (cm ⁴)	0,19
Iy (cm ⁴)	12,95
Tornillería Screws	812913



ALUMINIOS IBÉRICA, S.A.



PALA-MIGUEL S REIS, Lda.



ALUMINIOS DE VISEULDA.



ANGULAR - Aluminios, Lda.

COR 80 INDUSTRIAL

Perfiles a escala

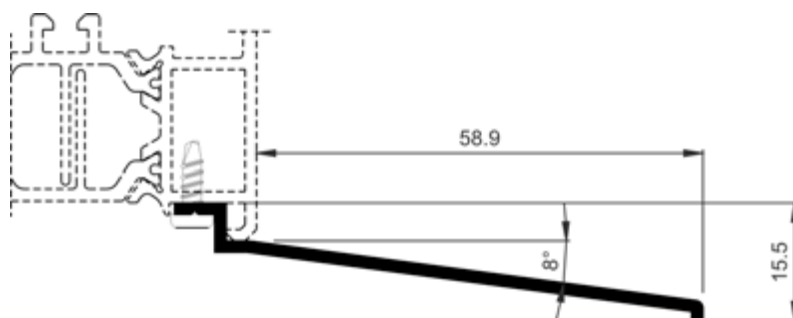

COR-7056	
Descripción Description	Alargadera de 60 mm 60 mm Cill
Peso Weight (g/m)	307,8
Superficie Surface (dm ² /m)	15,57
I _x (cm ⁴)	0,15
I _y (cm ⁴)	5
Tornillería Screws	812913

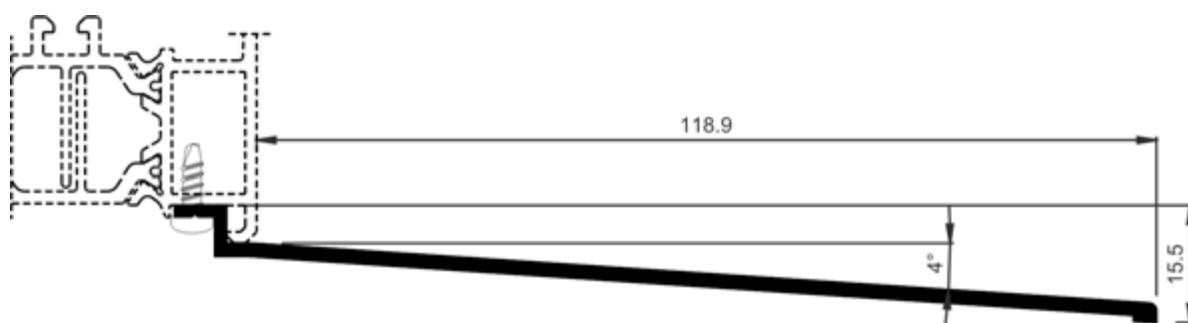

COR-7057	
Descripción Description	Alargadera de 120 mm 120 mm Cill
Peso Weight (g/m)	618,3
Superficie Surface (dm ² /m)	27,5
I _x (cm ⁴)	0,23
I _y (cm ⁴)	33,9
Tornillería Screws	812913

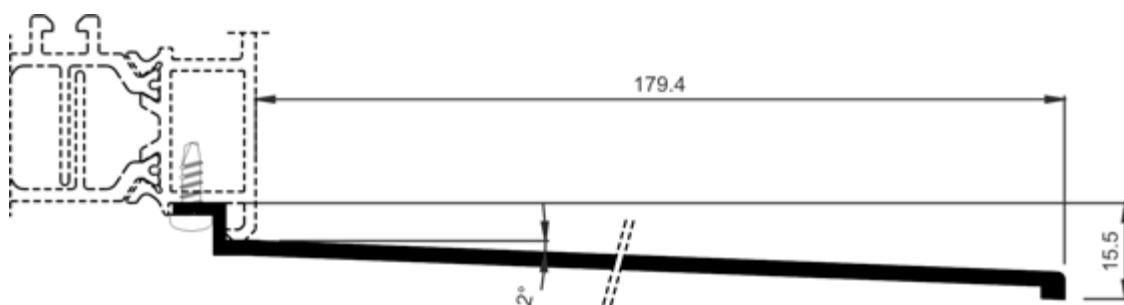

COR-7072	
Descripción Description	Alargadera de 180 mm 180 mm Cill
Peso Weight (g/m)	950,4
Superficie Surface (dm ² /m)	39,66
I _x (cm ⁴)	0,26
I _y (cm ⁴)	110,95
Tornillería Screws	812913



ALUMÍNIO IBÉRICA, S.A.



PALA-MIGUEL S. REIS, Lda.



ALUMÍNIO DE VISEU Lda.



ANGULAR - Aluminios, Lda.

COR 80 INDUSTRIAL

Perfiles a escala

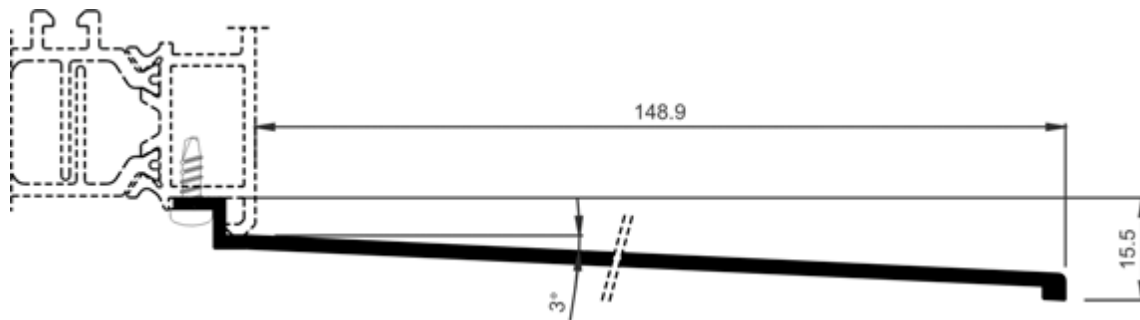

COR-7073

Descripción Description	Alargadera de 150 mm 150 mm Cill
Peso Weight (g/m)	764,1
Superficie Surface (dm ² /m)	33,66
Ix (cm ⁴)	0,22
Iy (cm ⁴)	64,13
Tornillería Screws	812913

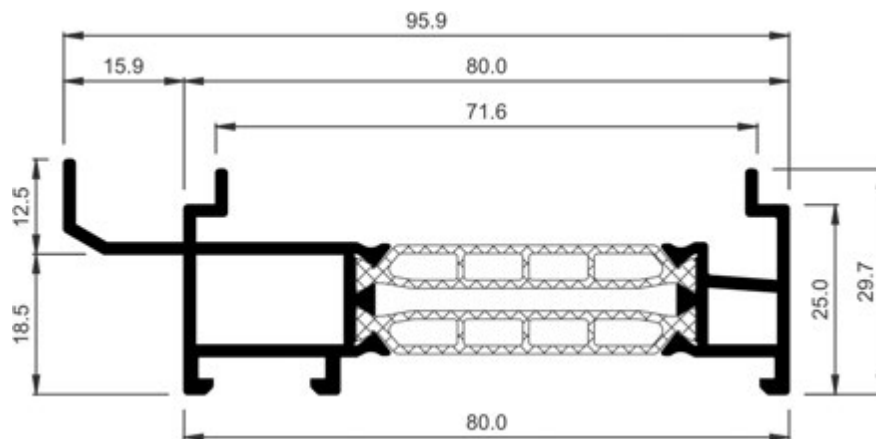

COR-7760

Descripción Description	Condensación Condensation
Peso Weight (g/m)	1504,5
Superficie Surface (dm ² /m)	43,39
Ix (cm ⁴)	2,01
Iy (cm ⁴)	37,45
Tapas Covers	257200

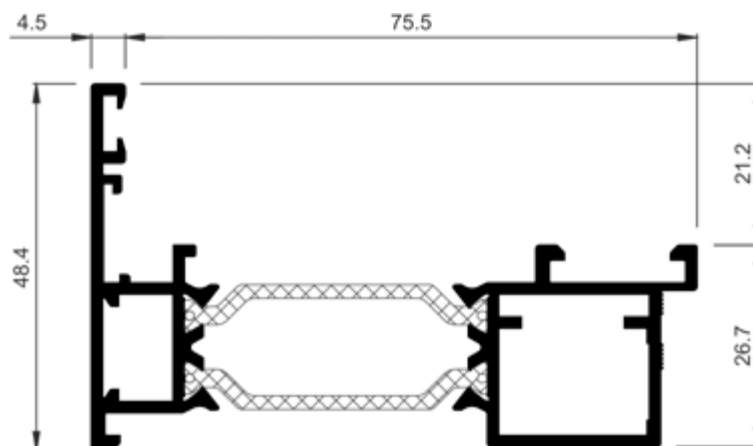

COR-7765

Descripción Description	Conversor apertura exterior Outside opening converter
Peso Weight (g/m)	1369,8
Superficie Surface (dm ² /m)	49,18
Ix (cm ⁴)	4,92
Iy (cm ⁴)	33,51
Escuadra principal Main cleat	347922
Troquel Die	337999
Escuadra secundaria Secondary cleat	327920
Escuadra alineamiento Alignment cleat	296838



ALUMINIOS IBÉRICA, S.A.



PALA-MIGUEL S REIS, Lda.



ALUMINIOS DE VISEULDA.



ANGULAR - Aluminios, Lda.

COR 80 INDUSTRIAL

Perfiles a escala

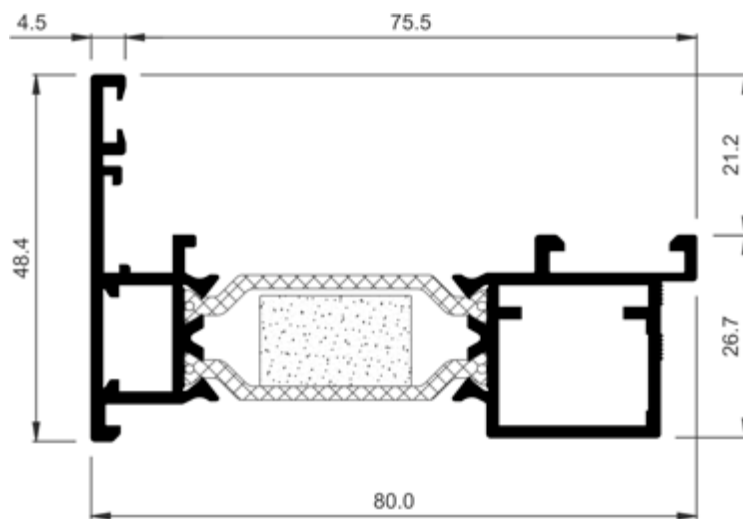

COR-7766	
Descripción Description	Conversor apertura exterior HI Outside opening converter HI
Peso Weight (g/m)	1369,8
Superficie Surface (dm ² /m)	49,18
I _x (cm ⁴)	4,92
I _y (cm ⁴)	33,51
Escuadra principal Main cleat	347922
Troquel Die	337999
Escuadra secundaria Secondary cleat	327920
Escuadra alineamiento Alignment cleat	296838

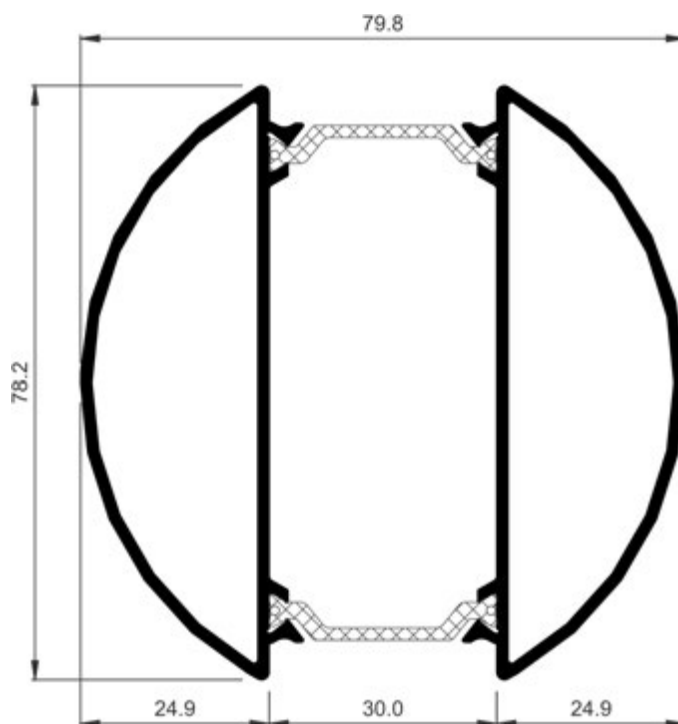

COR-7780	
Descripción Description	Esquinero regulable Adjustable corner attachment
Peso Weight (g/m)	1786,6
Superficie Surface (dm ² /m)	74,14
I _x (cm ⁴)	32,41
I _y (cm ⁴)	35,27



COR-2012	
Descripción Description	Grapa para junquillos Glazing bead clip
Peso Weight (g/m)	113,4
Superficie Surface (dm ² /m)	7,65
I _x (cm ⁴)	0,03
I _y (cm ⁴)	0,12



ALUMINIOS IBÉRICA, S.A.



PALA-MIGUEL S REIS, Lda.



ALUMINIOS DE VISEULDA



ANGULAR - Aluminios, Lda.

COR 80 INDUSTRIAL

Perfiles a escala

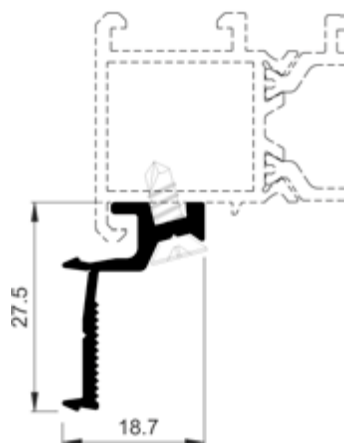

COR-2705	
Descripción Description	Grapa para solapes Clip for overlap
Peso Weight (g/m)	232,2
Superficie Surface (dm ² /m)	112,1
I_x (cm ⁴)	0,58
I_y (cm ⁴)	0,23
Tornillería Screws	853913

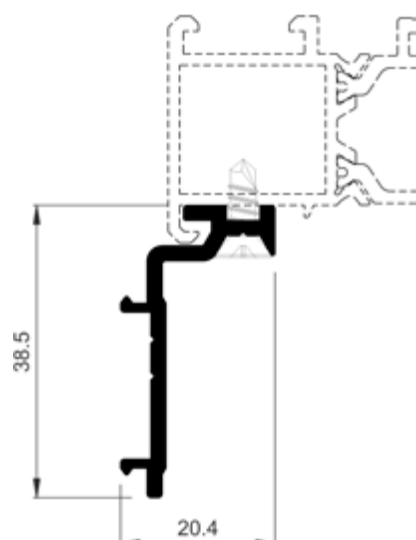

COR-2744	
Descripción Description	Grapa para solapes Clip for overlap
Peso Weight (g/m)	348,3
Superficie Surface (dm ² /m)	13,98
I_x (cm ⁴)	1,84
I_y (cm ⁴)	0,36
Tornillería Screws	853913

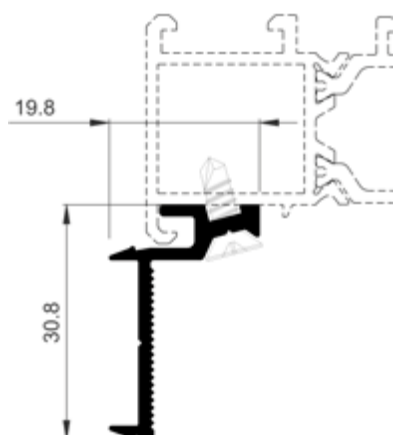

COR-2842	
Descripción Description	Grapa para solapes Clip for overlap
Peso Weight (g/m)	261,9
Superficie Surface (dm ² /m)	12,73
I_x (cm ⁴)	0,9
I_y (cm ⁴)	0,24
Tornillería Screws	853913



ALUMINIOS IBÉRICA, S.A.



PALA-MIGUEL S REIS, LDA.



ALUMINIOS DE VISEULDA



ANGULAR - Aluminios, Lda.

COR 80 INDUSTRIAL

Perfiles a escala

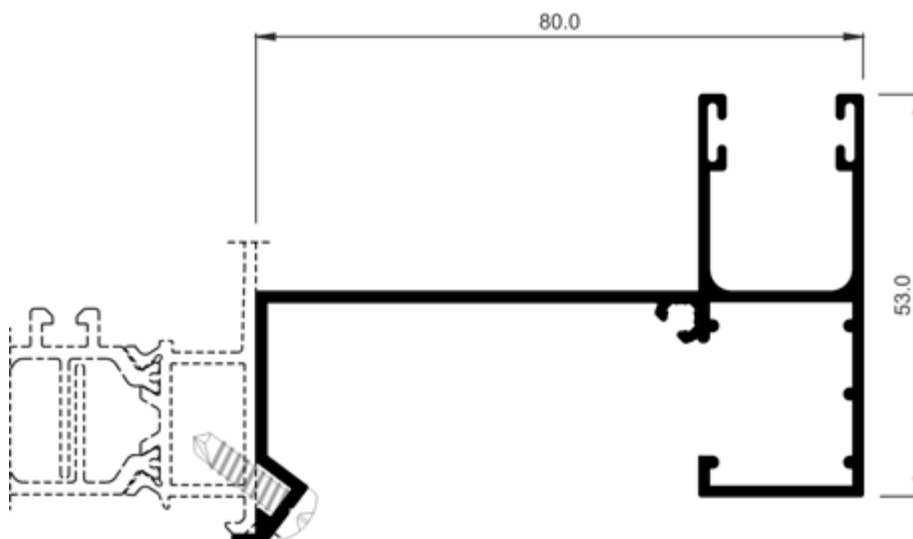

COR-2708	
Descripción Description	Guía de 80 mm 80 mm guide
Peso Weight (g/m)	926,1
Superficie Surface (dm ² /m)	50,34
I_x (cm ⁴)	7,61
I_y (cm ⁴)	29,27
Observaciones Observations	Tornillo Ø3.9 mm DIN7504N-A2. Sólo válida para persianas motorizadas Ø3.9 mm DIN7504N-A2 screw. Only for motorized shutters

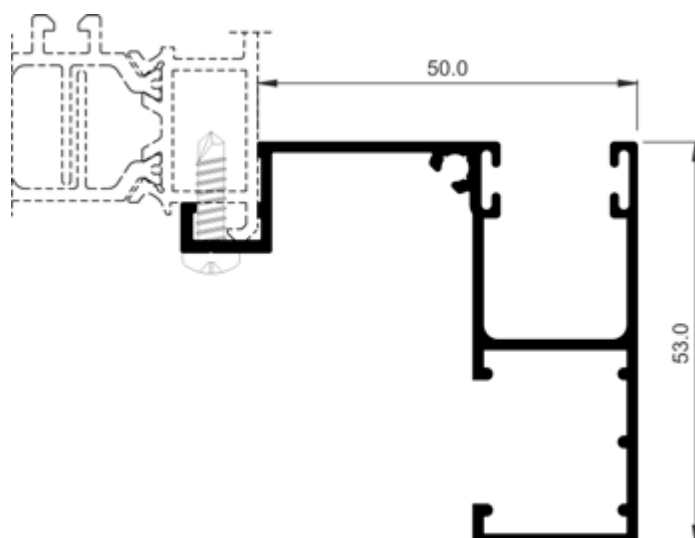

COR-2752	
Descripción Description	Guía de 50 mm 50 mm guide
Peso Weight (g/m)	758,7
Superficie Surface (dm ² /m)	41,84
I_x (cm ⁴)	8,43
I_y (cm ⁴)	9,58
Observaciones Observations	Tornillo Ø3.9 mm DIN7504N-A2 Screw Ø3.9 mm DIN7504N-A2



ALUMINIOS IBÉRICA, S.A.



PALA-MIGUEL S REIS, Lda.



ALUMINIOS DE VISEULDA



ANGULAR - Aluminios, Lda.

COR 80 INDUSTRIAL

Perfiles a escala

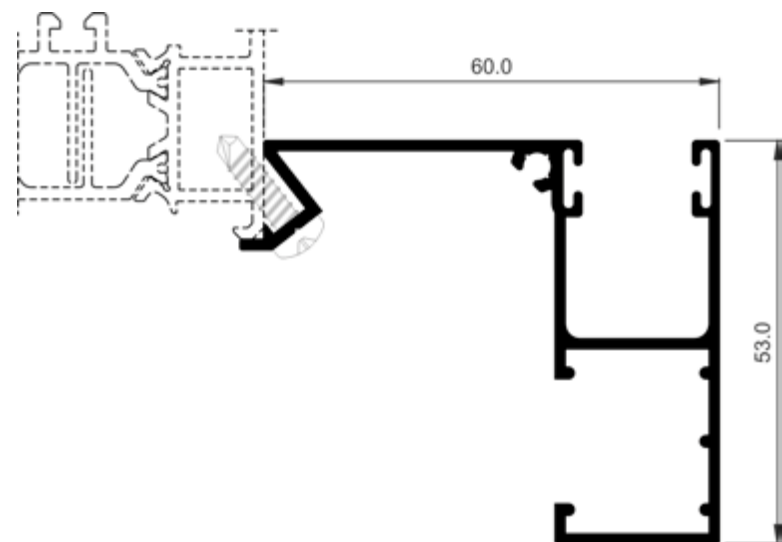

COR-2753	
Descripción Description	Guía de 60 mm 60 mm guide
Peso Weight (g/m)	761,4
Superficie Surface (dm ² /m)	42,42
Ix (cm ⁴)	8,9
Iy (cm ⁴)	10,72
Observaciones Observations	Tornillo Ø3.9 mm DIN7504N-A2 Screw Ø3.9 mm DIN7504N-A2

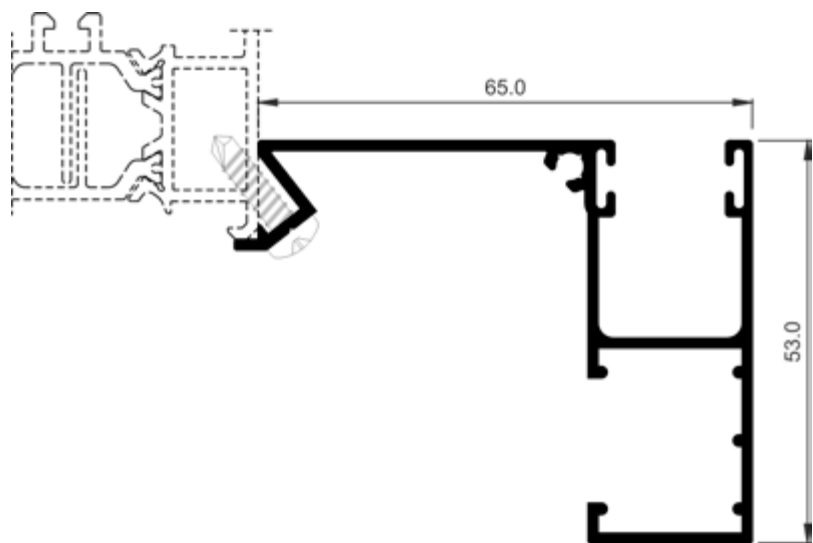

COR-2754	
Descripción Description	Guía de 65 mm 65 mm guide
Peso Weight (g/m)	777,6
Superficie Surface (dm ² /m)	43,42
Ix (cm ⁴)	9,13
Iy (cm ⁴)	13
Observaciones Observations	Tornillo Ø3.9 mm DIN7504N-A2 Screw Ø3.9 mm DIN7504N-A2

COR 80 INDUSTRIAL

Perfiles a escala

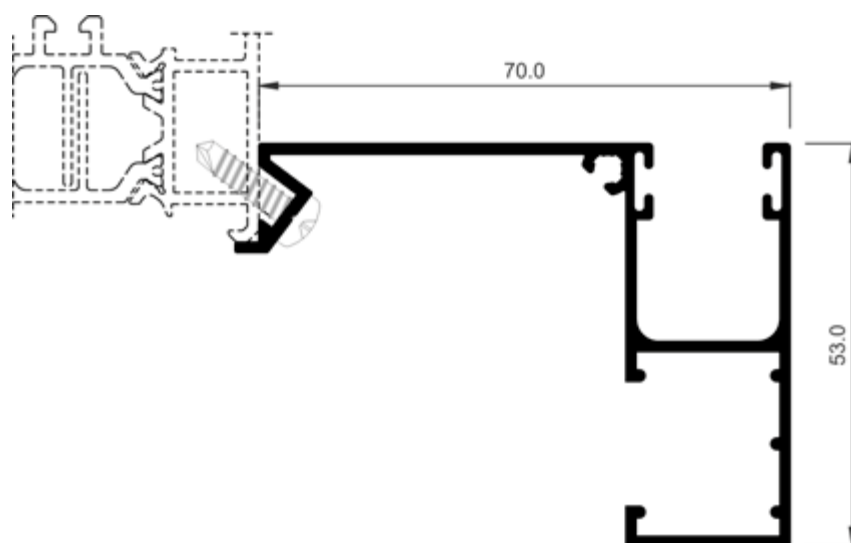

COR-2755	
Descripción Description	Guía de 70 mm 70 mm guide
Peso Weight (g/m)	810
Superficie Surface (dm ² /m)	44,33
Ix (cm ⁴)	9,48
Iy (cm ⁴)	16,21
Observaciones Observations	Tornillo Ø3.9 mm DIN7504N-A2 Screw Ø3.9 mm DIN7504N-A2

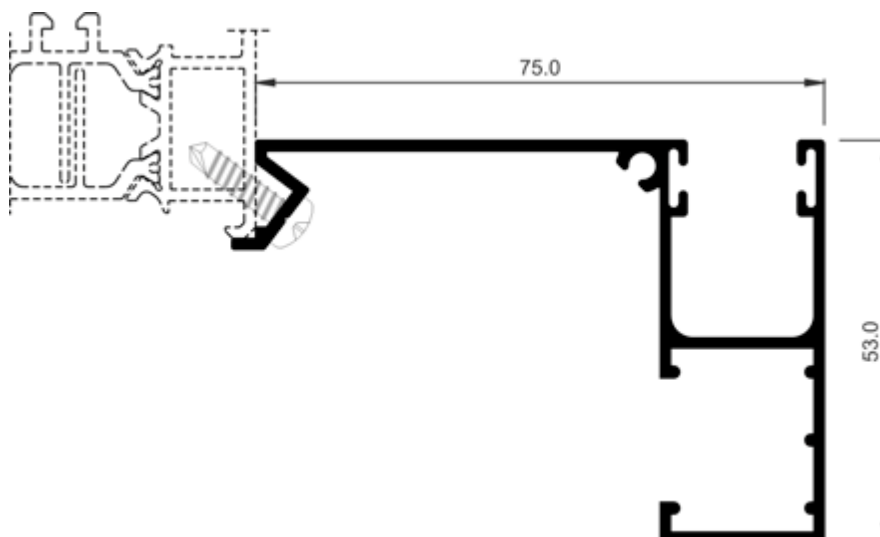

COR-2756	
Descripción Description	Guía de 75 mm 75 mm guide
Peso Weight (g/m)	828,9
Superficie Surface (dm ² /m)	44,99
Ix (cm ⁴)	9,72
Iy (cm ⁴)	18,84
Observaciones Observations	Tornillo Ø3.9 mm DIN7504N-A2 Screw Ø3.9 mm DIN7504N-A2



ALUMINIOS IBÉRICA, S.A.



PALA-MIGUEL S REIS, Lda.



ALUMINIOS DE VISEULDA



ANGULAR - Aluminios, Lda.

COR 80 INDUSTRIAL

Perfiles a escala

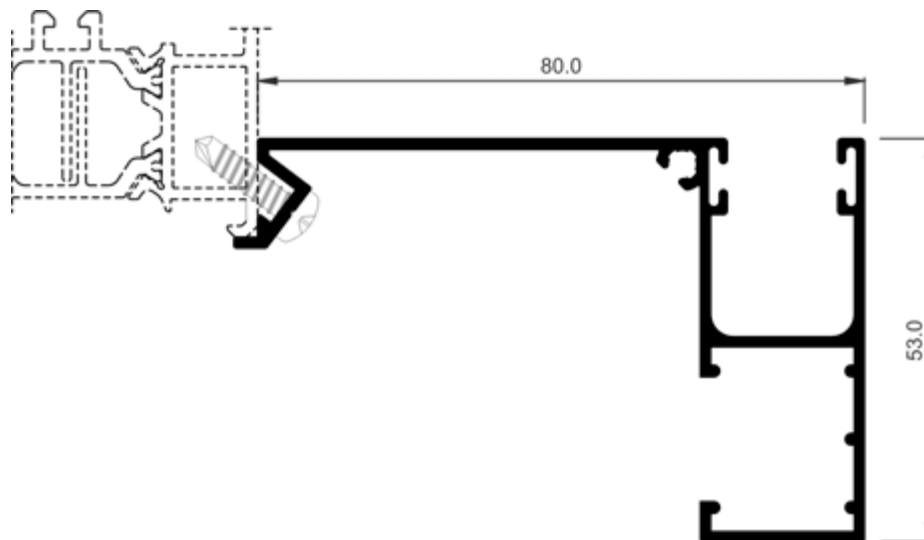

COR-2757	
Descripción Description	Guía de 80 mm 80 mm guide
Peso Weight (g/m)	847,8
Superficie Surface (dm ² /m)	46,33
Ix (cm ⁴)	9,91
Iy (cm ⁴)	22,59
Observaciones Observations	Tornillo Ø3.9 mm DIN7504N-A2 Screw Ø3.9 mm DIN7504N-A2

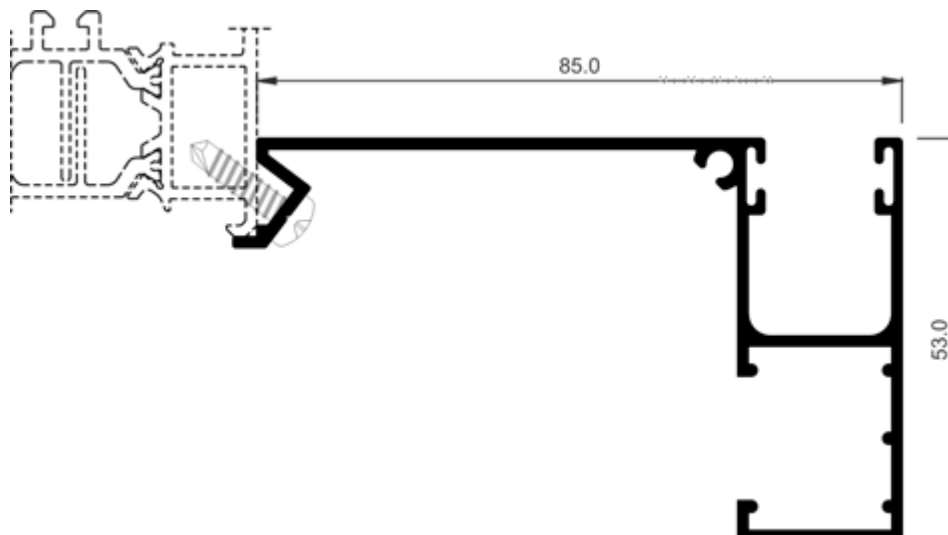

COR-2758	
Descripción Description	Guía de 85 mm 85 mm guide
Peso Weight (g/m)	866,7
Superficie Surface (dm ² /m)	46,99
Ix (cm ⁴)	10,13
Iy (cm ⁴)	25,79
Observaciones Observations	Tornillo Ø3.9 mm DIN7504N-A2 Screw Ø3.9 mm DIN7504N-A2



ALUMINIOS IBÉRICA, S.A.



PALA-MIGUEL S REIS, Lda.



ALUMINIOS DE VISEULDA



ANGULAR - Aluminios, Lda.

COR 80 INDUSTRIAL

Perfiles a escala

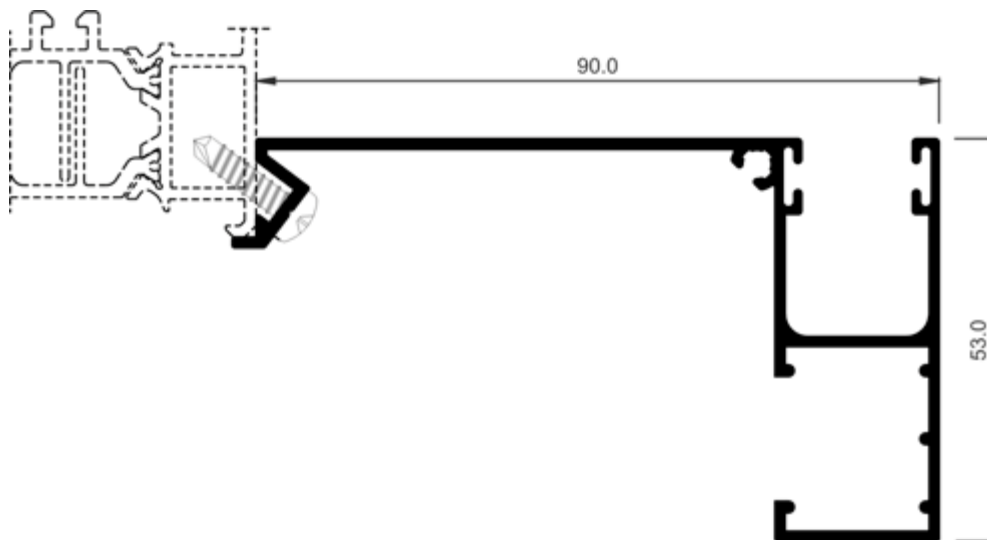

COR-2759	
Descripción Description	Guía de 90 mm 90 mm guide
Peso Weight (g/m)	885,6
Superficie Surface (dm ² /m)	48,32
Ix (cm ⁴)	10,3
Iy (cm ⁴)	30,36
Observaciones Observations	Tornillo Ø3.9 mm DIN7504N-A2 Screw Ø3.9 mm DIN7504N-A2

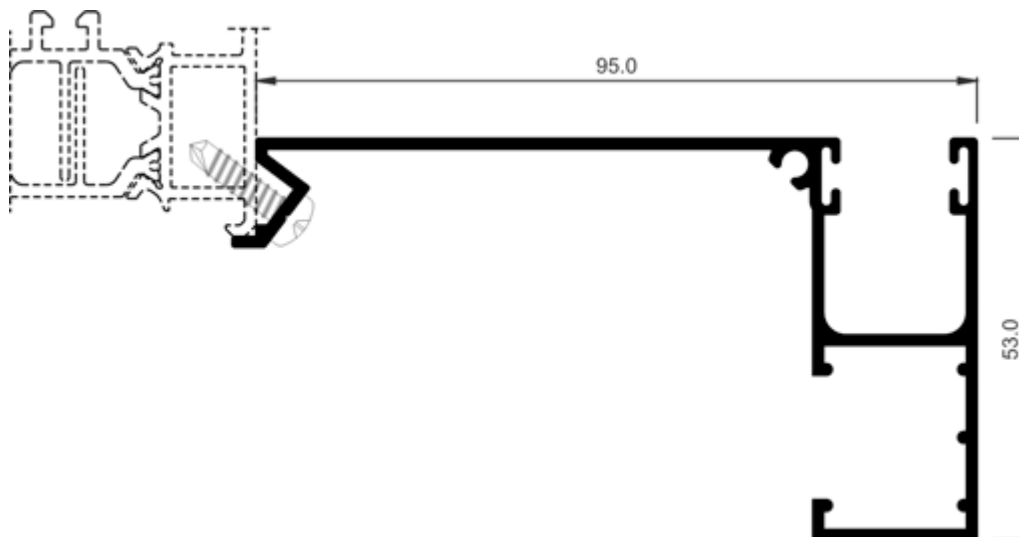

COR-2760	
Descripción Description	Guía de 95 mm 95 mm guide
Peso Weight (g/m)	918
Superficie Surface (dm ² /m)	48,83
Ix (cm ⁴)	10,72
Iy (cm ⁴)	34,47
Observaciones Observations	Tornillo Ø3.9 mm DIN7504N-A2 Screw Ø3.9 mm DIN7504N-A2



ALUMINIOS IBÉRICA, S.A.



PALA-MIGUEL S REIS, Lda.



ALUMINIOS DE VISEULDA



ANGULAR - Aluminios, Lda.

COR 80 INDUSTRIAL

Perfiles a escala

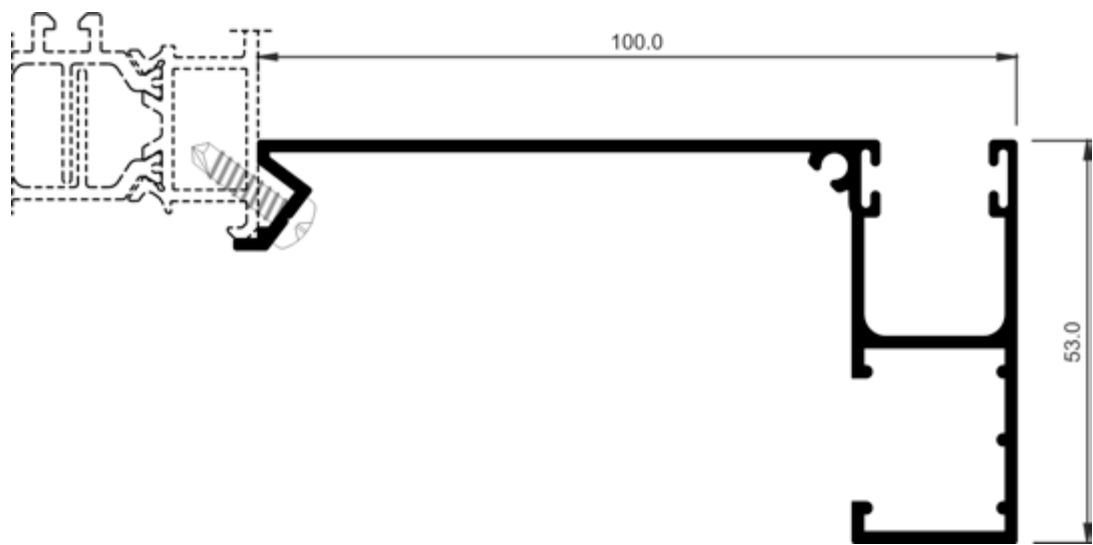

COR-2761	
Descripción Description	Guía de 100 mm 100 mm guide
Peso Weight (g/m)	950,4
Superficie Surface (dm²/m)	49,73
Ix (cm⁴)	11,1
Iy (cm⁴)	39,59
Observaciones Observations	Tornillo Ø3.9 mm DIN7504N-A2 Screw Ø3.9 mm DIN7504N-A2



COR-2763	
Descripción Description	Guía de 110 mm 110 mm guide
Peso Weight (g/m)	977,4
Superficie Surface (dm²/m)	52,13
Ix (cm⁴)	11,4
Iy (cm⁴)	50,19
Observaciones Observations	Tornillo Ø3.9 mm DIN7504N-A2. CONSULTAR DISPONIBILIDAD Screw Ø3.9 mm DIN7504N-A2 CHECK AVAILABILITY

COR 80 INDUSTRIAL

Perfiles a escala

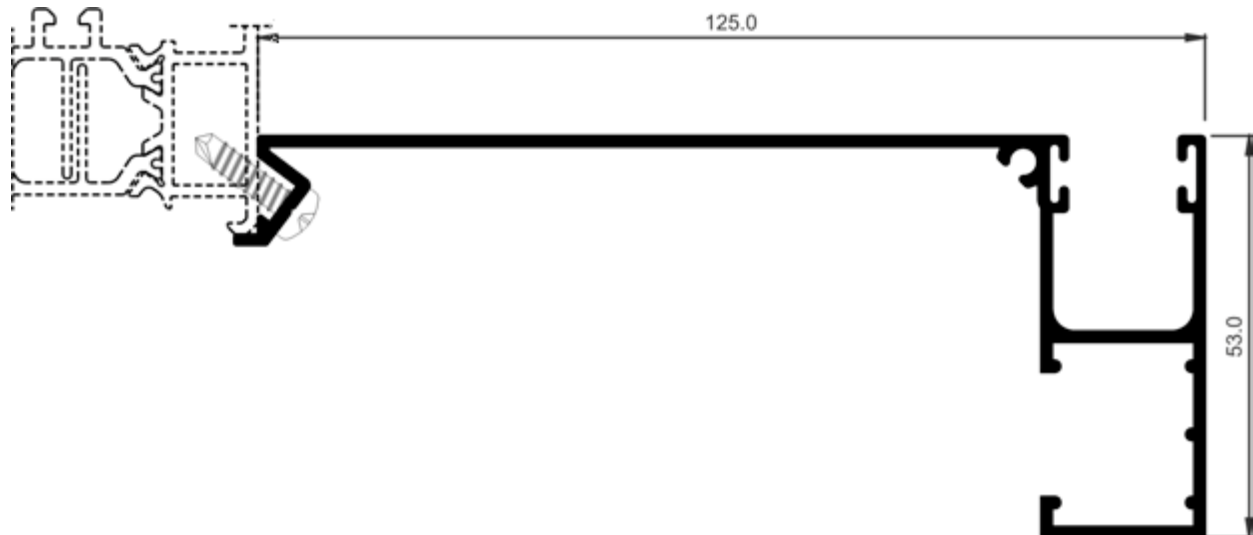

COR-2766	
Descripción Description	Guía de 125 mm 125 mm guide
Peso Weight (g/m)	1047,6
Superficie Surface (dm ² /m)	54,82
Ix (cm ⁴)	11,93
Iy (cm ⁴)	70,69
Observaciones Observations	Tornillo Ø3.9 mm DIN7504N-A2 Screw Ø3.9 mm DIN7504N-A2

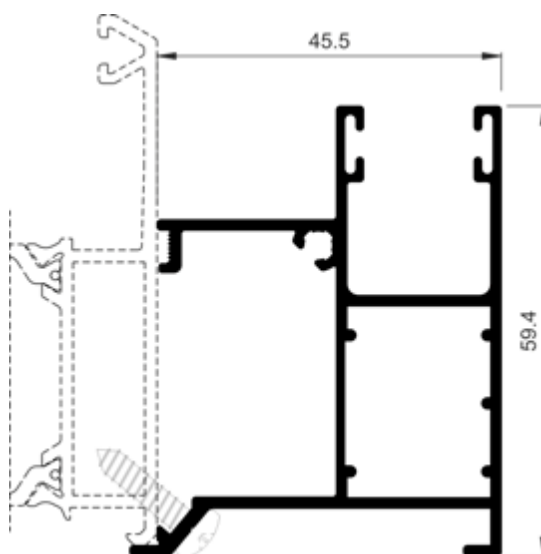

COR-2800	
Descripción Description	Guía de 45,5 mm embutir recogedor Cram scoop 45,5 mm guide
Peso Weight (g/m)	907,2
Superficie Surface (dm ² /m)	47,85
Ix (cm ⁴)	10,85
Iy (cm ⁴)	7,1
Observaciones Observations	Tornillo Ø3.9 mm DIN7504N-A2 Screw Ø3.9 mm DIN7504N-A2



ALUMINIOS IBÉRICA, S.A.



PALA-MIGUEL S REIS, Lda.



ALUMINIOS DE VISEUGUA



ANGULAR - Aluminios, Lda.

COR 80 INDUSTRIAL

Perfiles a escala

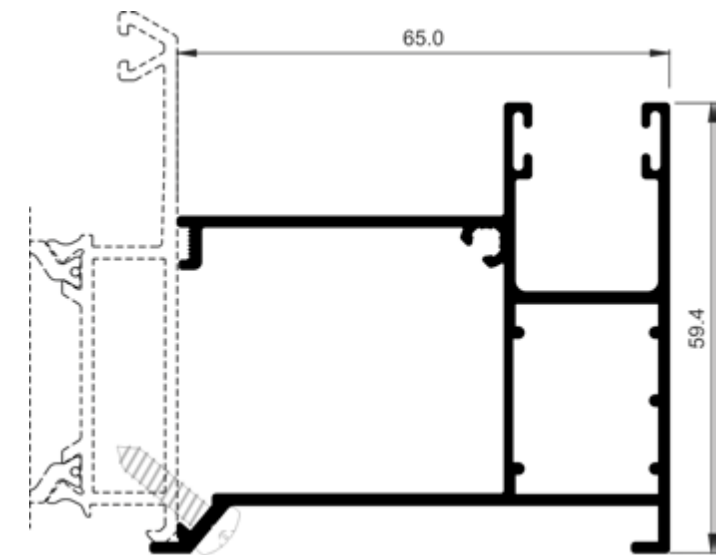

COR-2802	
Descripción Description	Guía de 65 mm embutir recogedor Cram scoop 65 mm guide
Peso Weight (g/m)	1061,1
Superficie Surface (dm²/m)	55,65
Ix (cm⁴)	12,79
Iy (cm⁴)	16,98
Observaciones Observations	Tornillo Ø3.9 mm DIN7504N-A2. Screw Ø3.9 mm DIN7504N-A2

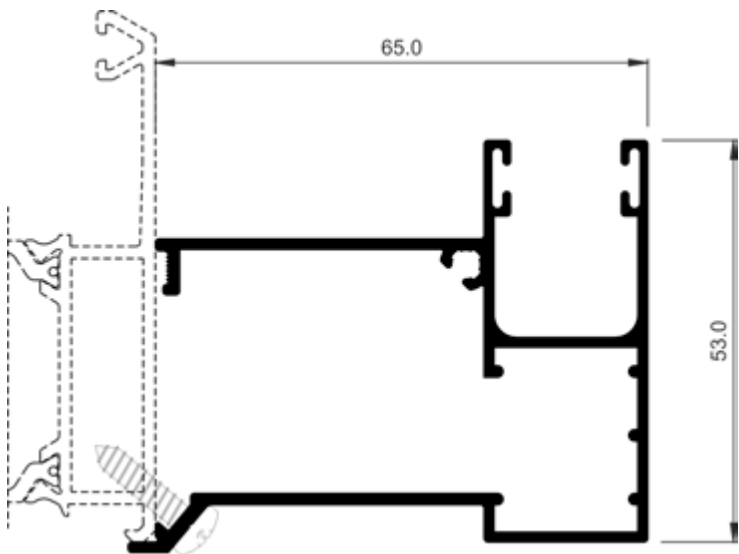

COR-2810	
Descripción Description	Guía de 65 mm embutir recogedor Cram scoop 65 mm guide
Peso Weight (g/m)	953,1
Superficie Surface (dm²/m)	50,76
Ix (cm⁴)	10,16
Iy (cm⁴)	15,92
Observaciones Observations	Tornillo Ø3.9 mm DIN7504N-A2. Screw Ø3.9 mm DIN7504N-A2

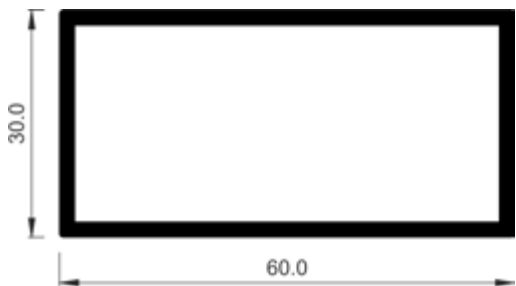

806030	
Descripción Description	Tubo de 60x30x2 mm 60x30x2 mm tube
Peso Weight (g/m)	928,8
Superficie Surface (dm²/m)	34,4
Ix (cm⁴)	15,93
Iy (cm⁴)	5,29

COR 80 INDUSTRIAL

Perfiles a escala

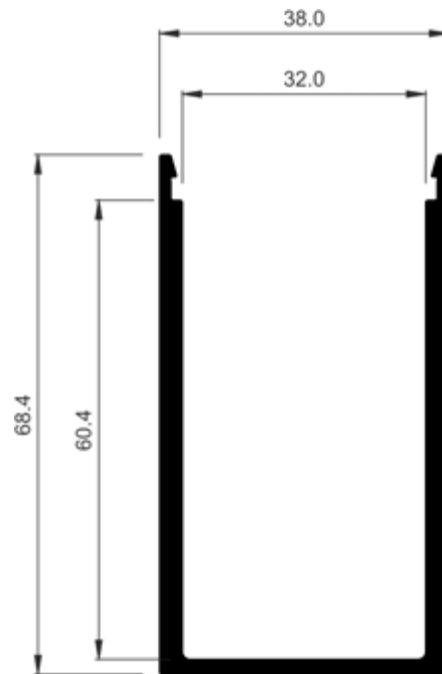

COR-1700	
Descripción Description	U de refuerzo Reinforcement U
Peso Weight (g/m)	1239,3
Superficie Surface (dm ² /m)	34,5
Ix (cm ⁴)	20,05
Iy (cm ⁴)	12,71

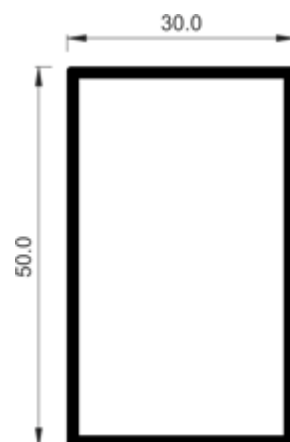

COR-6852	
Descripción Description	Tubo de 50x30 INOX 50x30 mm stainless tube
Peso Weight (g/m)	-
Superficie Surface (dm ² /m)	-
Ix (cm ⁴)	7,87
Iy (cm ⁴)	3,54



ALUMINIOS IBÉRICA, S.A.



PALA-MIGUEL S REIS, Lda.



ALUMINIOS DE VISEU Lda.



ANGULAR - Aluminios, Lda.

COR 80 INDUSTRIAL Perfiles a escala

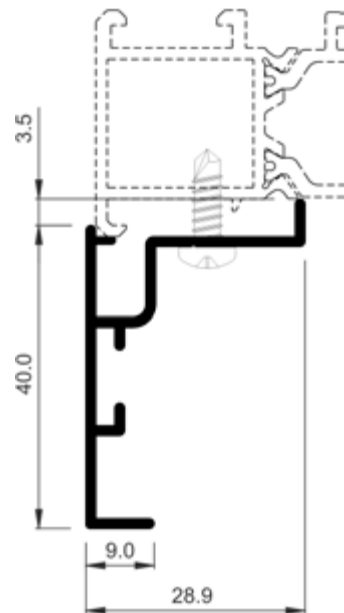

770224	
Descripción Description	Solape de registro recto Straight register overlap
Peso Weight (g/m)	353,7
Superficie Surface (dm²/m)	20,3
Ix (cm⁴)	2,24
Iy (cm⁴)	0,98
Escuadra alineamiento Alignment cleat	245054
Observaciones Observations	Tornillo Ø3.9 mm DIN7504N-A2 Screw Ø3.9 mm DIN7504N-A2

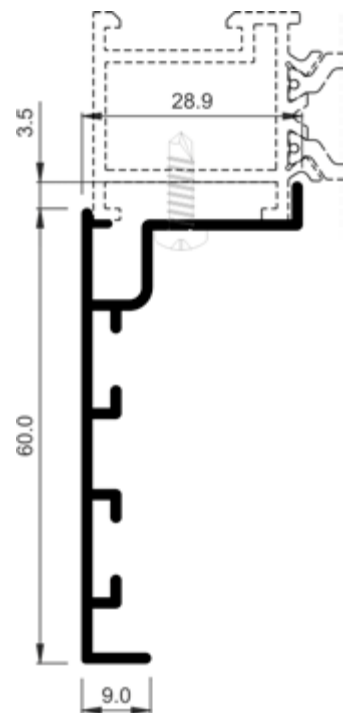

770563	
Descripción Description	Solape 60 mm 60 mm overlap
Peso Weight (g/m)	469,8
Superficie Surface (dm²/m)	26,85
Ix (cm⁴)	6,94
Iy (cm⁴)	1,09
Escuadra alineamiento Alignment cleat	245054
Observaciones Observations	Tornillo Ø3.9 mm DIN7504N-A2 Screw Ø3.9 mm DIN7504N-A2

COR 80 INDUSTRIAL

Perfiles a escala

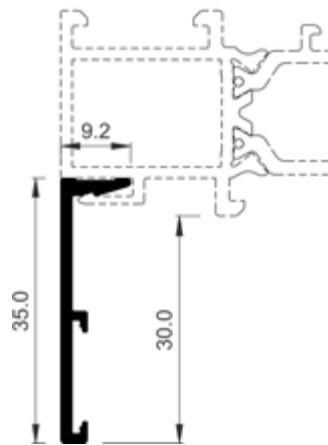

COR-1770	
Descripción Description	Solape de 35 mm 35 mm overlap
Peso Weight (g/m)	197,1
Superficie Surface (dm ² /m)	10,05
I_x (cm ⁴)	0,95
I_y (cm ⁴)	0,03
Escuadra alineamiento Alignment cleat	920135

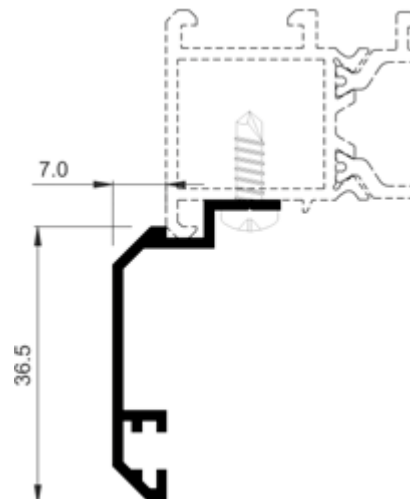

COR-2026	
Descripción Description	Solape 35 mm 35 mm overlap
Peso Weight (g/m)	272,7
Superficie Surface (dm ² /m)	15,24
I_x (cm ⁴)	1,8
I_y (cm ⁴)	0,33
Escuadra alineamiento Alignment cleat	212008
Observaciones Observations	Tornillo Ø3.9 mm DIN7504N-A2. Screw Ø3.9 mm DIN7504N-A2

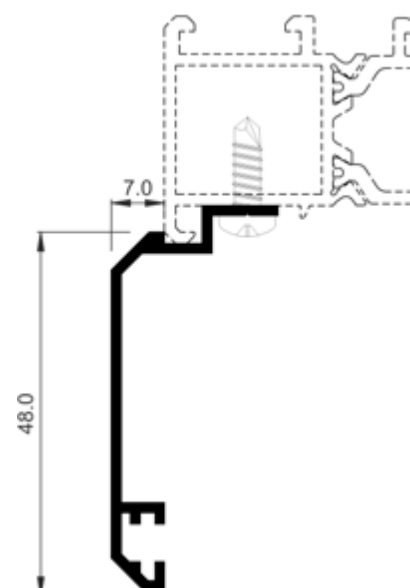

COR-2036	
Descripción Description	Solape 48 mm 48 mm overlap
Peso Weight (g/m)	272,7
Superficie Surface (dm ² /m)	17,63
I_x (cm ⁴)	3,19
I_y (cm ⁴)	0,31
Escuadra alineamiento Alignment cleat	212008
Observaciones Observations	Tornillo Ø3.9 mm DIN7504N-A2. Screw Ø3.9 mm DIN7504N-A2



ALUMINIOS IBÉRICA, S.A.



PALA-MIGUEL S REIS, Lda.



ALUMINIOS DE VISEU Lda.



ANGULAR - Aluminios, Lda.

COR 80 INDUSTRIAL

Perfiles a escala



COR-2077	
Descripción Description	Solape recto de 53 mm 53 mm straight overlap
Peso Weight (g/m)	315,9
Superficie Surface (dm ² /m)	15,75
I_x (cm ⁴)	4,43
I_y (cm ⁴)	0,17
Observaciones Observations	Tornillo Ø3.9 mm DIN7504N-A2 Screw Ø3.9 mm DIN7504N-A2

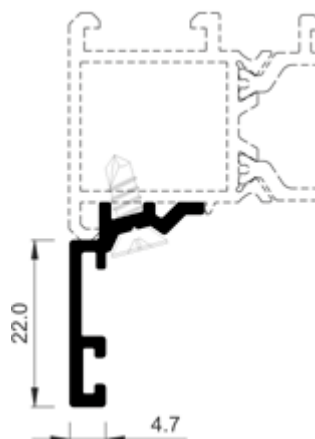

COR-2725	
Descripción Description	Solape recto 22 mm 22 mm straight overlap
Peso Weight (g/m)	245,7
Superficie Surface (dm ² /m)	11,2
I_x (cm ⁴)	0,71
I_y (cm ⁴)	0,2
Escuadra alineamiento Alignment cleat	212007
Observaciones Observations	Tornillo Ø3.9 mm DIN7504P-A2 Screw Ø3.9 mm DIN7504N-A2

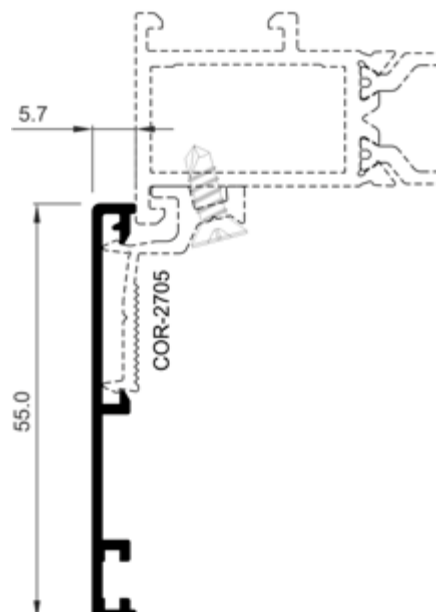

COR-2728	
Descripción Description	Solape recto de 55 mm Straight overlap 55 mm
Peso Weight (g/m)	270
Superficie Surface (dm ² /m)	16,03
I_x (cm ⁴)	3,19
I_y (cm ⁴)	0,02
Escuadra alineamiento Alignment cleat	212008 912100
Observaciones Observations	Grapa 2705 Clip 2705



ALUMINIOS IBÉRICA, S.A.



PALA-MIGUEL S REIS, Lda.



ALUMINIOS DE VISEU Lda.



ANGULAR - Aluminios, Lda.

COR 80 INDUSTRIAL

Perfiles a escala

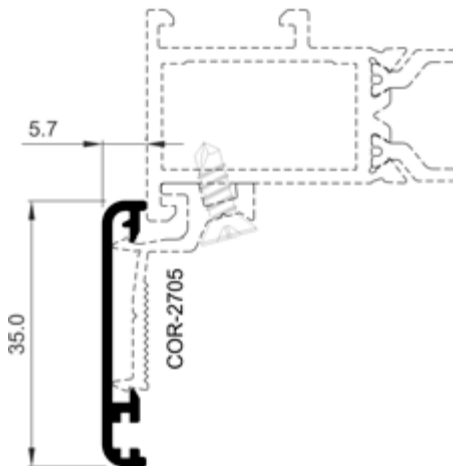

COR-2731	
Descripción Description	Solape de 35 mm Straight overlap 35 mm
Peso Weight (g/m)	183,6
Superficie Surface (dm²/m)	11
Ix (cm⁴)	0,92
Iy (cm⁴)	0,02
Escuadra alineamiento Alignment cleat	212007 912100
Observaciones Observations	Grapa 2705 Clip 2705

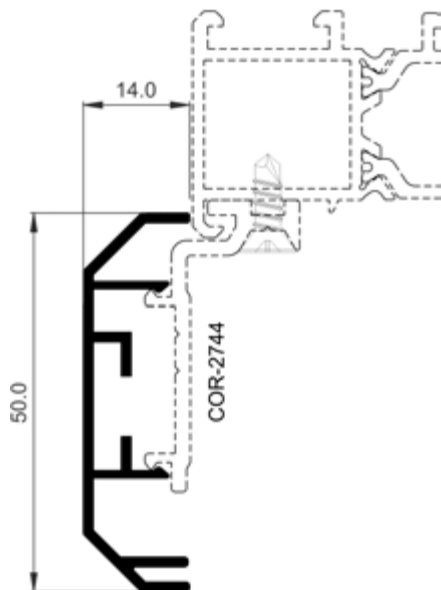

COR-2733	
Descripción Description	Solape chaflán de 50 mm Bevelled overlap 50 mm
Peso Weight (g/m)	367,2
Superficie Surface (dm²/m)	21,82
Ix (cm⁴)	3,42
Iy (cm⁴)	0,21
Escuadra alineamiento Alignment cleat	207004 277004
Observaciones Observations	Grapa 2744 Clip 2744



COR 80 INDUSTRIAL Perfiles a escala

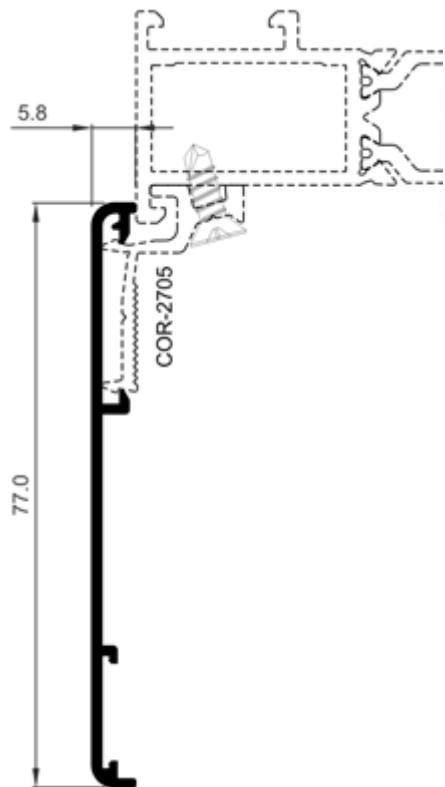

COR-2734	
Descripción Description	Solape de 77 mm 77 mm overlap
Peso Weight (g/m)	337,5
Superficie Surface (dm²/m)	19,66
Ix (cm⁴)	7,31
Iy (cm⁴)	0,02
Escuadra alineamiento Alignment cleat	912100 920135
Observaciones Observations	Grapa 2705 Clip 2705

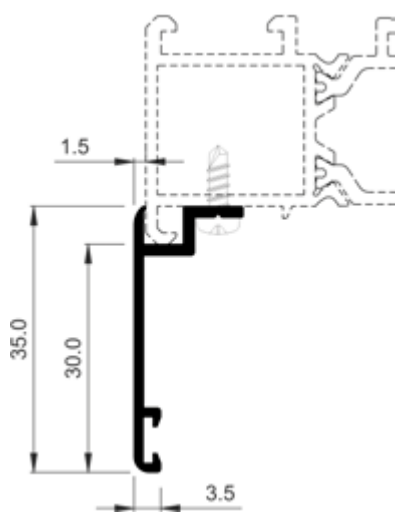

COR-2735	
Descripción Description	Solape para tornillo Screw overlap
Peso Weight (g/m)	205,2
Superficie Surface (dm²/m)	12,02
Ix (cm⁴)	0,99
Iy (cm⁴)	0,11
Tornillería Screws	852913
Escuadra alineamiento Alignment cleat	212007

COR 80 INDUSTRIAL

Perfiles a escala

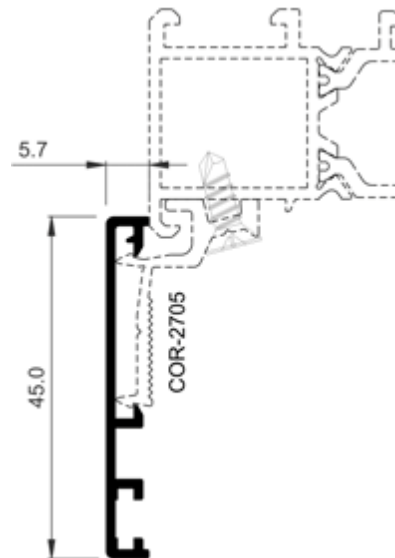

COR-2745	
Descripción Description	Solape recto 45 mm Straight overlap 45 mm
Peso Weight (g/m)	237,6
Superficie Surface (dm ² /m)	14,03
Ix (cm⁴)	1,88
Iy (cm⁴)	0,02
Escuadra alineamiento Alignment cleat	212008
	912100
Observaciones Observations	Grapa 2705 Clip 2705

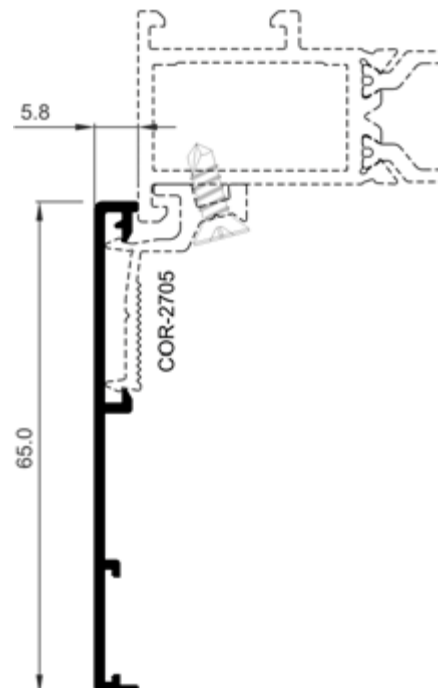

COR-2773	
Descripción Description	Solape recto de 65 mm 65 mm straight overlap
Peso Weight (g/m)	299,7
Superficie Surface (dm ² /m)	17,49
Ix (cm⁴)	4,7
Iy (cm⁴)	0,02
Escuadra alineamiento Alignment cleat	912100
	920135
Observaciones Observations	Grapa 2705 Clip 2705

COR 80 INDUSTRIAL Perfiles a escala

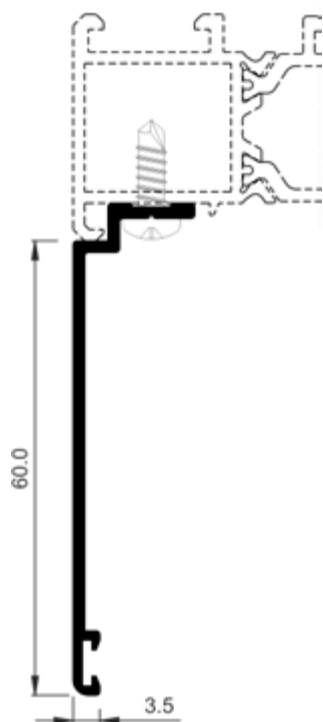

COR-2781	
Descripción Description	Solape recto 60 mm 60 mm straight overlap
Peso Weight (g/m)	337,5
Superficie Surface (dm²/m)	17,32
Ix (cm⁴)	5,59
Iy (cm⁴)	0,18
Escuadra alineamiento Alignment cleat	212007
Observaciones Observations	Tornillo Ø3.9 mm DIN7504N-A2. Screw Ø3.9 mm DIN7504N-A2

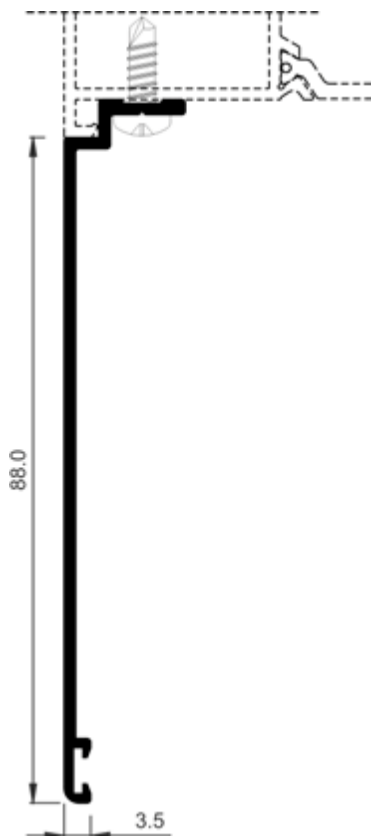

COR-2788	
Descripción Description	Solape recto 88 mm 88 mm straight overlap
Peso Weight (g/m)	450,9
Superficie Surface (dm²/m)	22,92
Ix (cm⁴)	14,88
Iy (cm⁴)	0,19
Escuadra alineamiento Alignment cleat	212007
Observaciones Observations	Tornillo Ø3.9 mm DIN7504N-A2. Screw Ø3.9 mm DIN7504N-A2

COR 80 INDUSTRIAL

Perfiles a escala

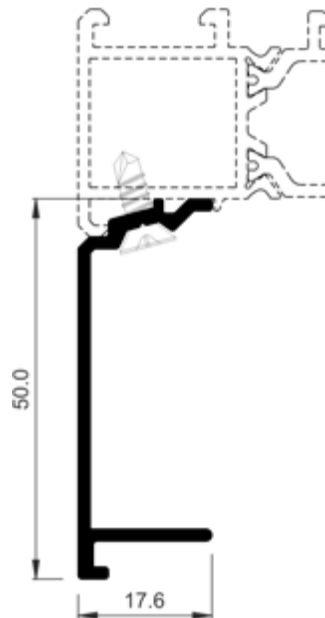

COR-2820	
Descripción Description	Tapa guía Guide end plate
Peso Weight (g/m)	369,9
Superficie Surface (dm ² /m)	16,72
I_x (cm ⁴)	4,19
I_y (cm ⁴)	0,36
Observaciones Observations	Tornillo Ø3.9 mm DIN7504P-A2. Ø2.9 mm DIN7504N- A2 screw

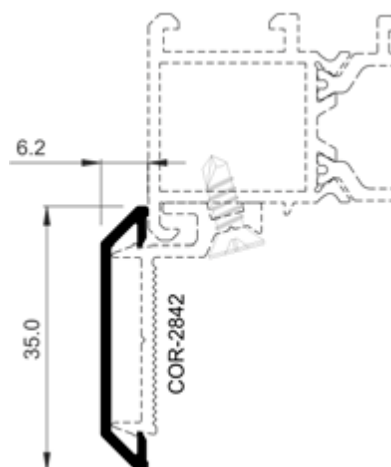

COR-2831	
Descripción Description	Solape de 35 mm 35 mm overlap
Peso Weight (g/m)	159,3
Superficie Surface (dm ² /m)	9,31
I_x (cm ⁴)	0,76
I_y (cm ⁴)	0,02
Escuadra alineamiento Alignment cleat	242831
Observaciones Observations	Grapa 2842 Clip 2842

COR 80 INDUSTRIAL Perfiles a escala

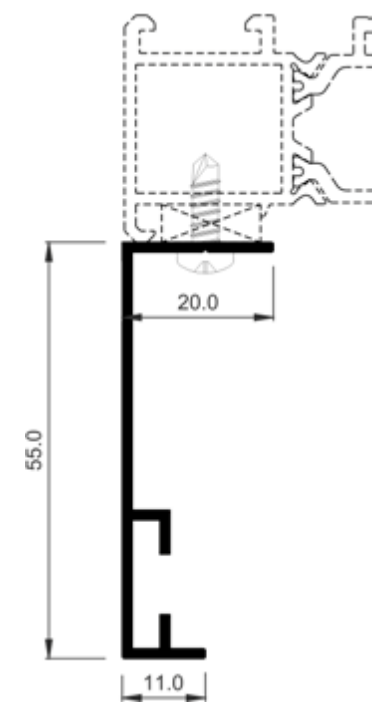

COR-2834	
Descripción Description	Solape de 55 mm atornillar (en L) 55 mm overlap screw (in L)
Peso Weight (g/m)	340,2
Superficie Surface (dm²/m)	19,71
Ix (cm⁴)	4,91
Iy (cm⁴)	0,28
Tornillería Screws	813919
Escuadra alineamiento Alignment cleat	207004
	277004

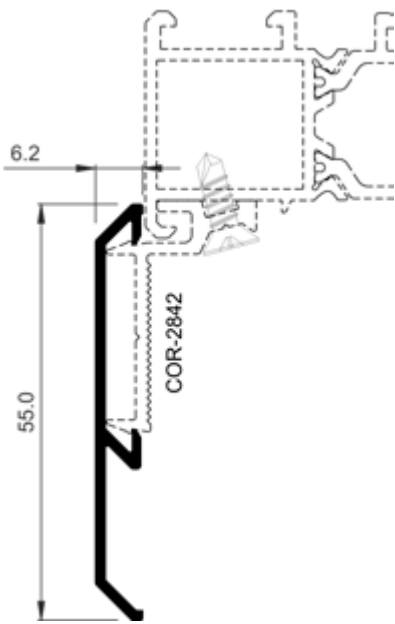

COR-2835	
Descripción Description	Solape de 55 mm 55 mm overlap
Peso Weight (g/m)	253,8
Superficie Surface (dm²/m)	14,4
Ix (cm⁴)	2,44
Iy (cm⁴)	0,03
Escuadra alineamiento Alignment cleat	242831
Observaciones Observations	Grapa 2842 Clip 2842

COR 80 INDUSTRIAL

Perfiles a escala

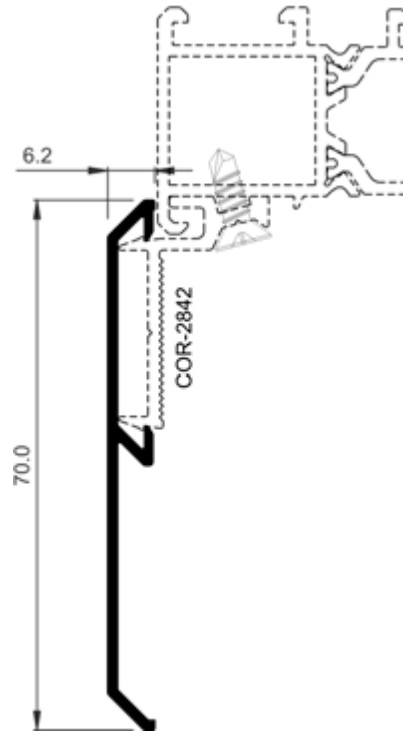

COR-2837	
Descripción Description	Solape de 70 mm 70 mm overlap
Peso Weight (g/m)	305,1
Superficie Surface (dm ² /m)	17,4
I_x (cm ⁴)	4,74
I_y (cm ⁴)	0,03
Escuadra alineamiento Alignment cleat	242831
Observaciones Observations	Grapa 2842 Clip 2842

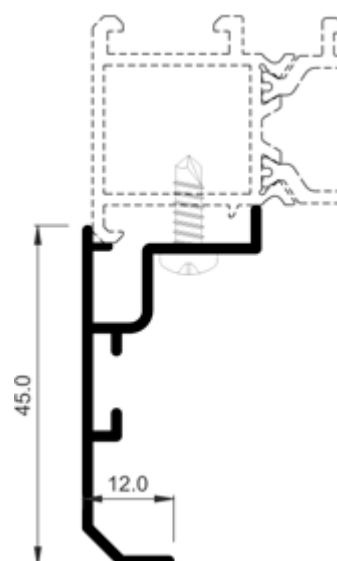

COR-2894	
Descripción Description	Solape de registro de 45 mm 45 mm register overlap
Peso Weight (g/m)	353,7
Superficie Surface (dm ² /m)	20,29
I_x (cm ⁴)	2,72
I_y (cm ⁴)	0,6
Tornillería Screws	813919
Escuadra alineamiento Alignment cleat	245054



ALUMINIOS IBÉRICA, S.A.



PALA-MIGUEL S REIS, Lda.



ALUMINIOS DE VISEULDA.



ANGULAR - Aluminios, Lda.

COR 80 INDUSTRIAL

Perfiles a escala

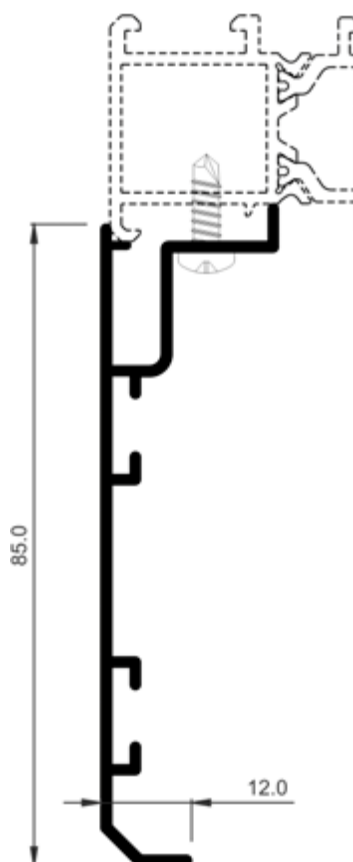

COR-2898	
Descripción Description	Solape de registro de 85 mm 85 mm register overlap
Peso Weight (g/m)	594
Superficie Surface (dm ² /m)	31,98
Ix (cm⁴)	16,75
Iy (cm⁴)	0,76
Tornillería Screws	813919
Escuadra alineamiento Alignment cleat	245054



ALUMINIOS IBÉRICA, S.A.



PALA-MIGUEL S REIS, LDA.



ALUMINIOS DE VISEU, LDA.



ANGULAR - Aluminios, Lda.

COR 80 INDUSTRIAL Perfiles a escala

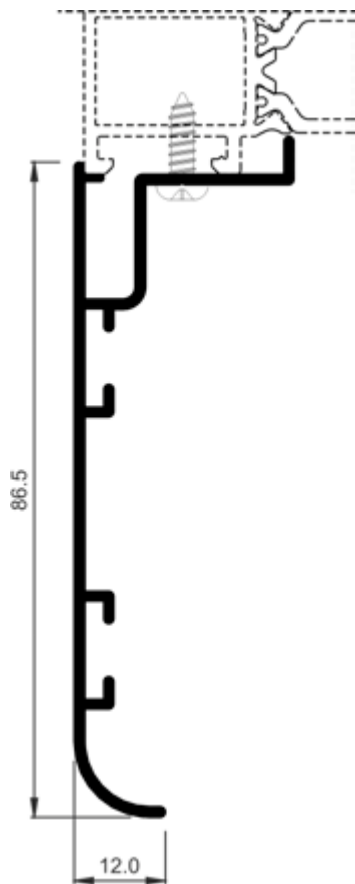

COR-5054	
Descripción Description	Solape de registro curvo de 86.50 mm Curve register overlap of 86,50 mm
Peso Weight (g/m)	621
Superficie Surface (dm²/m)	33,11
Ix (cm⁴)	17,92
Iy (cm⁴)	1,23
Tornillería Screws	813919
Escuadra alineamiento Alignment cleat	245054

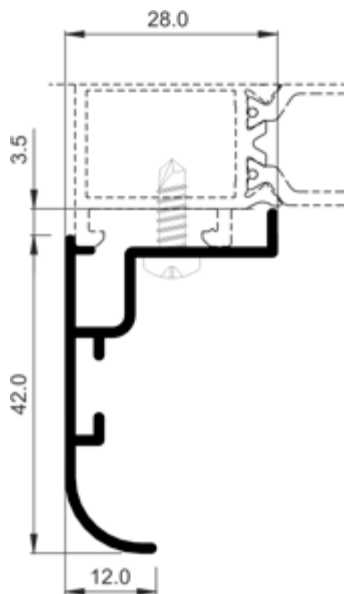

COR-5056	
Descripción Description	Solape de registro Register overlap
Peso Weight (g/m)	353,7
Superficie Surface (dm²/m)	20,31
Ix (cm⁴)	2,36
Iy (cm⁴)	0,89
Tornillería Screws	813919
Escuadra alineamiento Alignment cleat	245054



ALUMINIOS IBÉRICA, S.A.



PALA - MIGUEL S REIS, LDA.



ALUMINIOS DE VISEULDA



ANGULAR - Aluminios, Lda.

COR 80 INDUSTRIAL Perfiles a escala

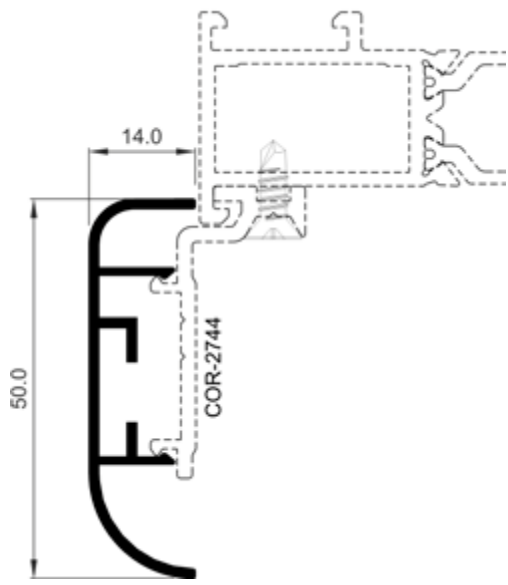

COR-7026	
Descripción Description	Solape de 50 mm 50 mm overlap
Peso Weight (g/m)	340,2
Superficie Surface (dm²/m)	20,45
Ix (cm⁴)	2,99
Iy (cm⁴)	0,18
Escuadra alineamiento Alignment cleat	207004
	277004
Observaciones Observations	Grapa 2744 Clip 2744

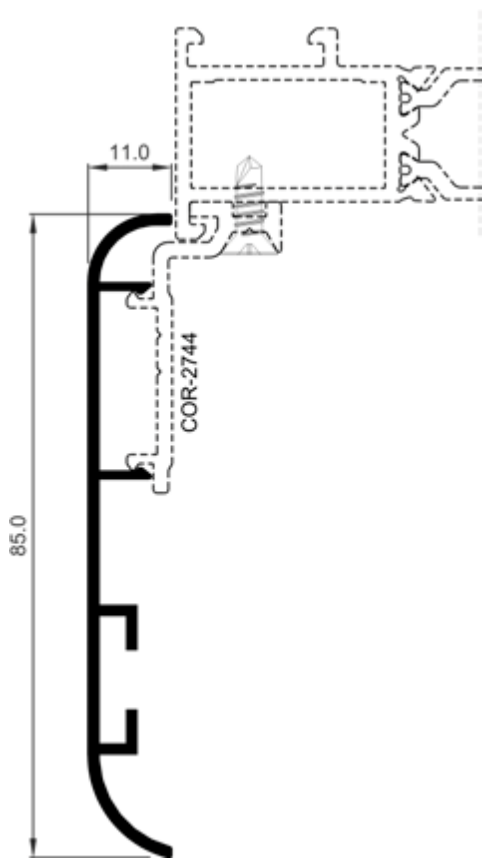

COR-7027	
Descripción Description	Solape de 85 mm 85 mm overlap
Peso Weight (g/m)	464,4
Superficie Surface (dm²/m)	25,82
Ix (cm⁴)	11,36
Iy (cm⁴)	0,12
Escuadra alineamiento Alignment cleat	207004
	277004
Observaciones Observations	Grapa 2744 Clip 2744

COR 80 INDUSTRIAL Perfiles a escala

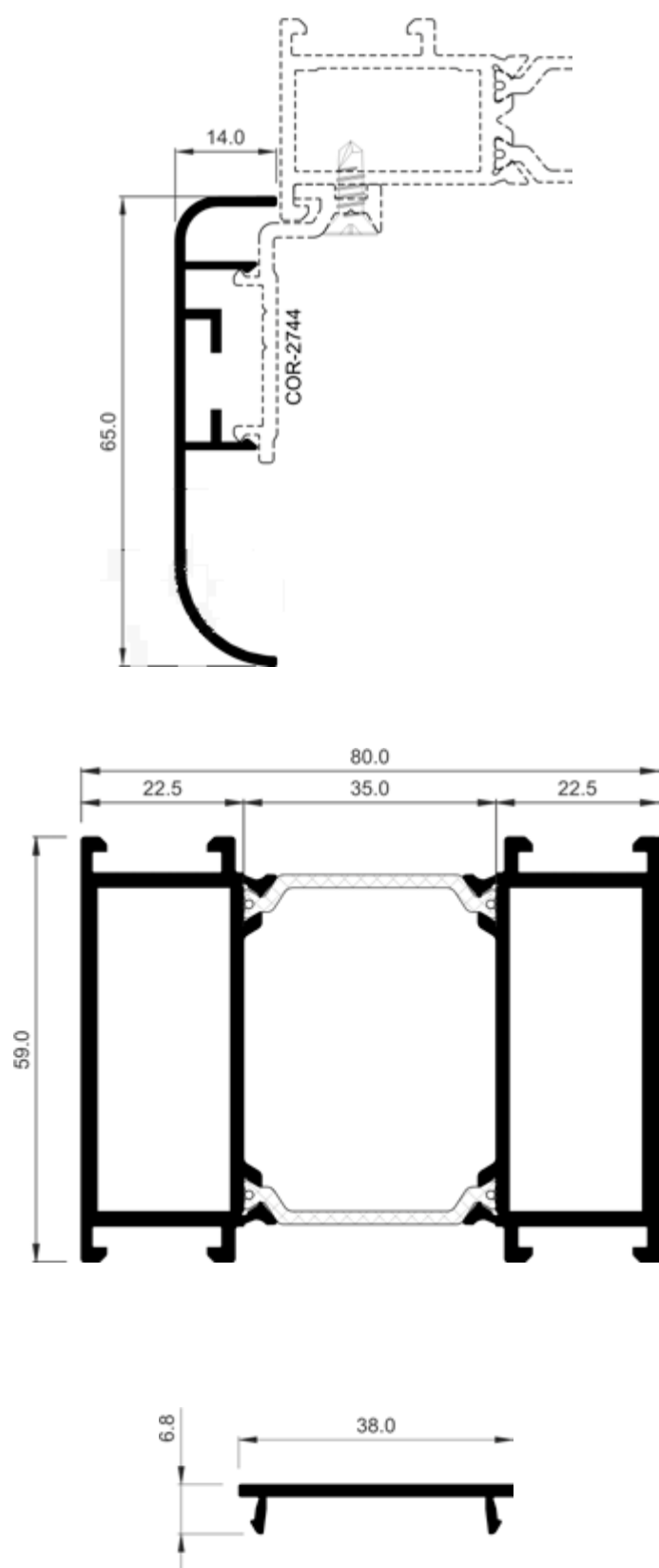

COR-7029	
Descripción Description	Solape de 65 mm 65 mm overlap
Peso Weight (g/m)	394,2
Superficie Surface (dm²/m)	23,45
Ix (cm⁴)	5,75
Iy (cm⁴)	0,2
Escuadra alineamiento Alignment cleat	207004 277004
Observaciones Observations	Grapa 2744 Clip 2744

COR-7790	
Descripción Description	Suplemento marco Frame supplement
Peso Weight (g/m)	2121,4
Superficie Surface (dm²/m)	70,38
Ix (cm⁴)	25,2
Iy (cm⁴)	60,9

COR-1701	
Descripción Description	Tapa clipaje U refuerzo Reinforcement U-clip end plate
Peso Weight (g/m)	202,5
Superficie Surface (dm²/m)	10
Ix (cm⁴)	0,02
Iy (cm⁴)	1,09

COR 80 INDUSTRIAL

Perfiles a escala

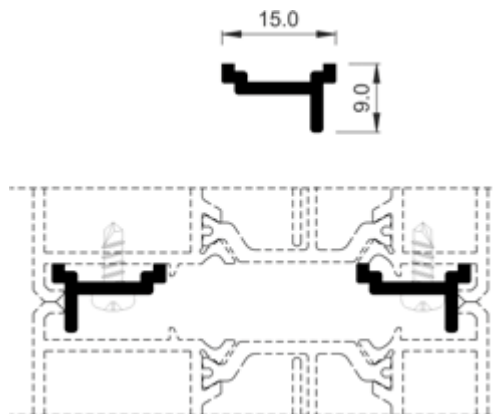

COR-7251	
Descripción Description	Unión de marcos oculta Concealed frame joint profile
Peso Weight (g/m)	105,3
Superficie Surface (dm ² /m)	5,15
I_x (cm ⁴)	0,02
I_y (cm ⁴)	0,08
Observaciones Observations	Tornillo Ø2.9 mm DIN7504N-A2 Ø2.9 mm DIN7504N-A2 screw

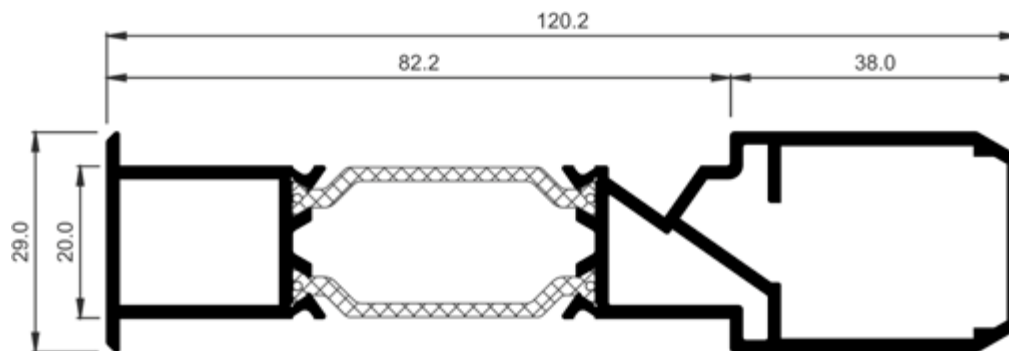

COR-7744	
Descripción Description	Unión de marcos con refuerzo Frame joint profile with reinforcement
Peso Weight (g/m)	1704,6
Superficie Surface (dm ² /m)	63,21
I_x (cm ⁴)	4,48
I_y (cm ⁴)	77,57

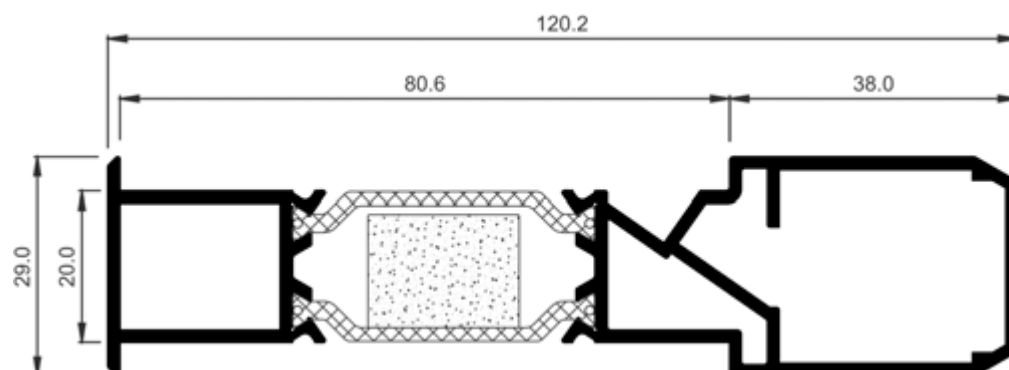

COR-7745	
Descripción Description	Unión de marcos con refuerzo HI Frame joint profile with reinforcement HI
Peso Weight (g/m)	1704,6
Superficie Surface (dm ² /m)	63,21
I_x (cm ⁴)	4,48
I_y (cm ⁴)	77,57



ALUMINIOS IBÉRICA, S.A.



PALA-MIGUEL S REIS, LDA.



ALUMINIOS DE VISEULDA



ANGULAR - Aluminios, Lda.

COR 80 INDUSTRIAL Perfiles a escala

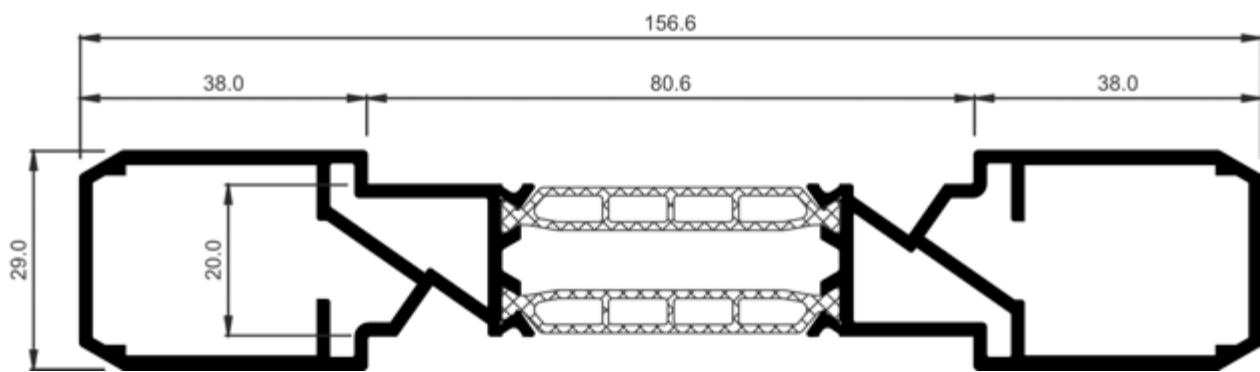

COR-7746	
Descripción Description	Unión de marcos con doble refuerzo Frame joint profile with double reinforcement
Peso Weight (g/m)	2388,8
Superficie Surface (dm²/m)	83,54
Ix (cm⁴)	6,79
Iy (cm⁴)	172,42

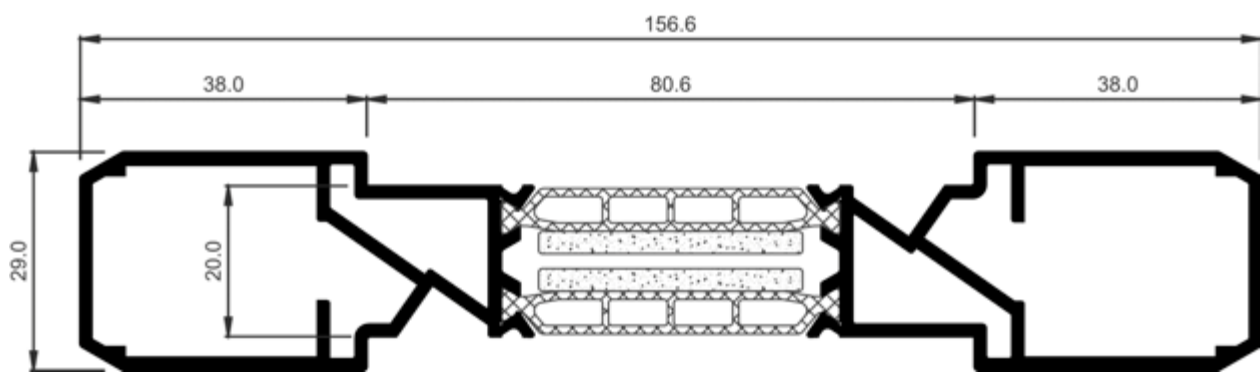

COR-7747	
Descripción Description	Unión de marcos con doble refuerzo HI Frame joint profile with double reinforcement HI
Peso Weight (g/m)	2388,8
Superficie Surface (dm²/m)	83,54
Ix (cm⁴)	6,79
Iy (cm⁴)	-

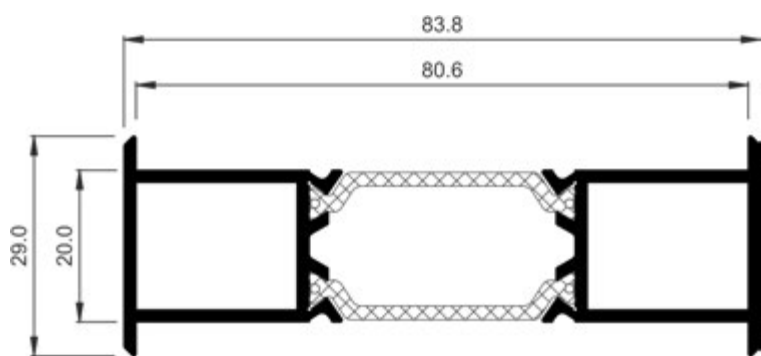

COR-7754	
Descripción Description	Unión de marcos Frame joint profile
Peso Weight (g/m)	1176,4
Superficie Surface (dm²/m)	42,88
Ix (cm⁴)	2,17
Iy (cm⁴)	30,88



ALUMINIOS IBÉRICA, S.A.



PALA-MIGUEL S REIS, Lda.



ALUMINIOS DE VISEULDA



ANGULAR - Alumínios, Lda.

COR 80 INDUSTRIAL

Perfiles a escala

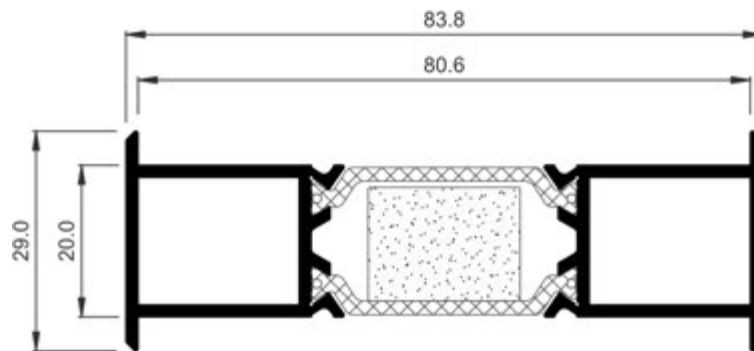

COR-7755	
Descripción Description	Unión de marcos HI HI frame joint profile
Peso Weight (g/m)	1176,4
Superficie Surface (dm ² /m)	42,88
I_x (cm ⁴)	2,17
I_y (cm ⁴)	30,88



ALUMINIOS IBÉRICA, S.A.



PALA-MIGUEL S REIS, Lda.



ALUMINIOS DE VISEU, Lda.



ANGULAR - Aluminios, Lda.

aluminiosiberica.pai.pt



ALUMÍNIOS IBÉRICA, S.A.

Sede e Fábrica: Rua do Parque Industrial, nº 126
4720-5 Lago Amarelo

Telefs. 253 310 250 — 253 310 251 **Fax** 253 311 830

Email: aluminiosiberica@mail.telepac.pt

Filiais:

Rua da Mina, 562 - 4405-234 Canelas - V.N.Gaia
Telefs: 227 929 539 **Fax** 227 629 514
Zona Industrial de Constantim, Lote 53
5000-062 Constantim - Vila Real
Telefs: 259 331 778 **Fax** 259 338 552



ALUMÍNIOS DE VISEU, L.D.A.

Armazém: Est. do Campo de Aviação - CAMPO
3510-824 VISEU

Telefs. 232 459 138 — 232 459 741

Fax 232 450 140

E-mail: geral@alviz.pt



P.A.L.A. - MIGUEL & REIS, LDA.

Ilhavo

Sede: Zona Industrial da Mota, Rua 7 lote 21—A
Gafanha da Encarnação — Apartado 523

3834-909 Ilhavo

Telefs: 234 329 120 — **Fax** 234 329 121

E-mail: pala.aluminio@sapo.pt

Leiria

Armazéns: Canhestro—Pousas 2410-235 LEIRIA

Telefs: 244 801 593 **Fax** 244 855 702

E-mail: pala.leiria@sapo.pt

Algarve

Zona Industrial de Vilamoura

Lote 28—Apartado 841 , 8126-910 Quarteira

Telefs: 289 322 748 — **Fax** 289 301 928

E-mail: pala.loule@sapo.pt



ANGULAR - Aluminios, Lda

Armazém: Av.Almirante Gago Coutinho

Portela de Sintra—Apartado 212

2711-901 SINTRA

Telefs. 219 244 074 — 219 244 101

Fax 219 241 015